

Tender /Fur/BUPGB/RO/Dec /2019/1130-2019  
31.12.2019

**(PART-II)**  
**PRICE BID**

**Summary**

**BARODA UTTAR PRADESH GRAMIN BANK**  
**REGIONAL OFFICE DISTT. RAE BARELI**

sno	Description	Section	Amount of Tender
1.	Furnishing works	in digits	
		in words	
2.	Electrical	in Digits	
		In words	
3.	Air Conditioner	in Digits	
		In words	
	TOTAL	in Digits	
		In words	
	GST 18%	In words	
	GRAND TOTAL	in Digits	
		In words	

**Note :-**

1. All materials to be used strictly follow the list of approved materials.
2. Any deviation in the use of materials at site other than approved materials list will not be permitted and the bank may cancel the contract at any time for any such misconduct & colour as per bran manual.
3. The workman ship and quality of work should be of good quality and to be satisfaction level of the bank's architect and bank

Tender /Fur/BUPGB/RO/Dec /2019/1130-2019  
31.12.2019

**TENDER OF FURNISHING WORKS FOR *BARODA UTTAR PRADESH GRAMIN BANK* SITUATED AT REGIONAL OFFICE , RAE BARELI.**

**1. FURNISHING WORKS:-**

SNO	ITEMS	QTY	UNIT	RATE	AMOUNT
1	<b>FALSE CEILING (Gyp board):-</b>				
	Providing and fixing Gypsum false ceiling as per India Gypsum specification for ceiling with drops as per drawing including of providing and fixing G.I. Frame work as per specification of India gypsum at a distance of 2'0"c/c both ways complete with 12.5 mm board and all necessary perimeter channels etc. No extra payment will be made for the cutting of light points, stained glass, cove lighting etc. The measurement will be taken in one level, rate should include the drops also, no extra amount will be paid for the drops. The joints to be properly mended with paper tapes and gypsum compound all complete. The rate should include the full completion of the ceiling. At the time of handing over the site all necessary repairing work to be considered if required. The work	2180.00	SQ.FT.		
1A.	<b>False ceiling (24"x24" Grid False Ceiling</b>				
	<b>24" x 24" Grid False Ceiling (FINE FISSURED PLANKS):</b> Providing and Fixing False ceiling Grid using hot dipped Galvanized steel sections, exposed surface chemically cleaned capping pre-finished inbaked polyster paint. Main tee of size 3000 x 32 x 24 mm at every 1200mm c/c maximum, 1200mm cross Tee of size 1200 x 27 x 24mm at every 600mm intervals and 600 mm cross Tee of size 600 x 25 x24mm at 1200mm max and 3000 x 19 x 19mm wall angle all around the wall to form grid size of 600mm x600mm. The Main grid to be suspended to the MS frame with 2mm pre-straightened GI wire and GI adjustable clamp and Laying of fibre wool board having Fire rating of 60 min. as per BS 476/23 of 1987, Noise reduction co-eff. (NRC) of 0.50, Light	1540.00	SQ.FT.		
2.	<b>PARTITION</b>				

Tender /Fur/BUPGB/RO/Dec /2019/1130-2019  
31.12.2019

	Providing and fixing partition in position as per design with 2" x 1.5" Aluminum section finished frame work @ 2'-0" c/c both ways screwed to the floor and ceiling with M.S. Cleats and to be treated with anti termite oil. The measurement will be taken upto the false ceiling visible height in case of full height partition. The frame work will be cladded with 10mm thk comm. Ply both sides and to be finished with approved 1 mm laminate (color with vertical grain) as per design with adhesive. 3" high laminated skirting to be fixed bottom side of the partition. Extra frame work to be fixed for fixing class. In the glazed partition 8 to 10mm thk.				
A	<b>PARTLY GLAZED PARTITION</b>				
I	PARTLY GLAZED R.M. CABIN PARTITION UPTO 8'-6" HT.	230.00	SQ.FT.		
II	PARTLY GLAZED C.M. CABIN PARTITION UPTO 8'-6" HT.	180.00	SQ.FT.		
III	PARTLY GLAZED LOW HEIGHT PARTITION UPTO 4'-0' HT.	408.00	SQ.FT.		
IV	PARTLY GLAZED CONFERENCE ROOM PARTITION UPTO 8'-6" HT.	315.00	SQ.FT.		
B	<b>BLOCKED PARTITION</b>				
I	BLOCKED PARTITION LOW HEIGHT PARTITION UPTO 4'-0' HT.	250.00	SQ.FT.		
II	BLOCKED PARTITION UPTO 11'-0" HEIGHT NEAR TOILET	132.00	SQ.FT.		
3	<b>DOORS</b>				
	Providing and fixing solid core 38mm solid core flush door finished with lippings in all side with necessary door hinges, cylindrical looks (golden, Godrej), door clouser, door stoppers, etc with a frame work of T.W./ Beech wood size 75mm x 62.5mm with necessary hold fast fixed to the wall/partition. 1 mm laminate to be fixed on both sides duly finished, edges to be finished with wooden lippings. A wooden molding size 1.5" x 2/8" to be provided all along the periferi of the frame work in the both sides. All the wooden area to be duly polished as per				

Tender /Fur/BUPGB/RO/Dec /2019/1130-2019  
31.12.2019

	specification of the Architect. In case of Partly glazed door 8mm thk etched or plain glass with granular blasting/sand blasting as per design of the Architect to be fixed with necessary moldings.				
I	Flap Door	0.0	Sq.fts.		
3D	FULLY GLAZED ENT. DOOR :-				
1.	P/F toughened glass (12mm thk.) door with pencil polish edges all around and including glass film of pattern and emblem as per design fixed with necessary patch fittings assembly including top and bottom patches, heavy duty floor Machine, bottom lock, SS brushed finished 2' long and 1" dia. handle on both sides of shutter etc. all complete as directed by Bank.	111.00	SQ.FT.		
2.	FULLY GLAZED CONFERENCE ROOM DOOR 2 nos. :- Specification same as item no. 3 D(1)	56.00	SQ.FT.		
3.	FULLY GLAZED R.M. OFFICE ROOM DOOR:- Specification same as item no. 3 D(1)	24.50	SQ.FT.		
4.	<b>CASH COUNTER:-</b>				
	For customer as per layout with provision of 3'-9" high, 2'-6" deep with shelf for CPU and storage unit out of 18 mm thick commercial board with 1.00 mm thick laminate on all exposed surfaces with key board tray with telescopic slides. All edgings. Margin etc. out of polished steamed.	0.0	RFT.		
5.	<b>OFFICER COUNTER</b>				
	For customer as per layout with provision of 2'-6" high, 2'-6" deep with shelf for CPU and storage unit out of 18 mm thick commercial board with 1.00 mm thick laminate on all exposed surfaces. With key board tray with telescopic slides. All edgings. Margin etc. out of polished steamed.	0.0	Rft.		
	R.M. TABLE:- 9' x 3'-6" , H = 2'-6" IN SEMI CIRCULAR SHPAE:- Providing and fixing R.M. TABLE 8'-0"x 3'-0"x2'-6" (ht.) and 10mm beveled glass of approved make to be fitted on top obtain the total height of 2'-6" as per detailed drawing . made up of 19 mm commercial board of	1 no.	each		

	approved make the finished with 1 mm thick laminate of approved make and shade as approved as per detailed drawing including glass of table Top. Table shall be provided with 3 drawers sliding on telescopic channels with proper locking arrangements and keyboard with telescope channels tabletop shall be finished with 1.0 mm thick laminate of approved shade & quality . The work includes provided and fixing locks, wire manager , spirit polishing of steam beach bending etc. complete in all respects to the entire satisfaction of the architect.				
	C.M. Table:- 6'-0"x 3'-0" H = 2'-6"	1.00	each		
	Reception Table:- 5'-0"x 2'-6" H = 2'-6" IN SEMI CIRCULAR SHPAE:-	1.00	each		
	Officer Table:- 4'-6"x 2'-6" H = 2'-6"	21.00	each		
	Lunch Table:- 3'-0"x 8'-0"	0.00	each		
	Conference Table:-	56	Rft.		
	Center Table:- 24" x 48"	3 nos.	each		
6.	<b>STORAGE</b>				
	Providing and fixing Full height storage 400mm deep made out of 19mm bwp block board finished with 1.0mm laminate in all exposed areas. The drawers to be made out of 19mm BWP block board in the front cladded with 1.0mm laminate (color, vertical grain). sides to be made out of 6mm plywood duly painted in matching tone and it should play on drawer sliding channels. The shutters to be made out of 19mm block board and should play on drawer sliding castors on powder coated channels. The necessary locks, handles, etc to be provided. Inside of the unit to be enamel painted in matching tone. All the exposed edges of the boards / plywood's to be covered with wooden lapping / moldings duly polished all complete.				
	Low Height storage (2'-6" ht).	460.00	SQ.FT.		

Tender /Fur/BUPGB/RO/Dec /2019/1130-2019  
31.12.2019

	Full height storage (7'-0" ht).	200.00	SQ.FT.		
	Cup Board in Kitchen	45.00	SQ.FT.		
7.	<b>COMPLAINT BOX (1'-0"x1'-6"x1'-0")</b>				
	Providing and making <b>Complaint box</b> 1.5'x1'x (12" deep)as per design & pattern with 19 mm ply finished exterior surface with 6 mm thick extra clear white painted glass having 4"x1" slots with 3 mm thick S.S. plat pasted with metal adhesive. Rate shall includes all necessary hard wares and locking and side opening arrangements.	1.0	EACH		
8.	<b>SUGGESTION BOX (1'-0"x1'-6"x1'-0")</b>				
	Providing and making <b>Suggestion box</b> 1.5'x1'x(12" deep)as per design & pattern with 19 mm ply finished exterior surface with 6 mm thick extra clear white painted glass having 4"x1" slots with 3 mm thick S.S. plat pasted with metal adhesive. Rate shall includes all necessary hardwares and locking and side opening arrangements.	1 NO.	EACH		
9.	<b>WALL MOUNTED WRITING TABLE 1'-3" TO 1'-6" WIDE AND LENGTH 5'-0"</b>				
	Providing and Fixing wall mounted writing tables as per design. The base of the table shall be a frame of wooden members mounted on a wooden base. The top <b>shall be of 1" comm. Ply finished in 1.5 mm laminate</b> the edge of the top shall be provided with a wooden <b>moulding ¾" x 3" finished in melamine.</b>	0.0	EACH		
10	<b>NOTICE BOARD (4'x 3')</b> Providing & fixing Notice Board the tag board of approved make & design, of size 4' X 3', with anodized aluminum boarder/frame type. The board should be 3/4" th. Strow board with velvet type fabric lining of apprd. Colour.	2 NOS.	EACH		
11.	<b>METER BOX</b> Providing and fixing Meter Box 400mm deep made out of 19mm bwp block board finished with 1.0mm laminate in all exposed areas. The drawers to be made out of 19mm BWP block board in the front cladded with 1.0mm laminate (color, vertical grain). sides to be made out of 6mm plywood duly painted in matching tone	34.00	SQ.FT.		

Tender /Fur/BUPGB/RO/Dec /2019/1130-2019  
31.12.2019

	and it should play on drawer sliding channels. The shutters to be made out of 19mm block board and should play on drawer sliding castors on powder coated channels. The necessary locks, handles, etc to be provided. Inside of the unit to be enamel painted in matching tone. All the exposed edges of the boards / plywood's to be covered with wooden lapping / moldings duly polished all complete.				
12.	Providing and fixing paneling on wall. Framing shall consist of Aluminum Section 1"X1.5" (Wall Thickness 2 mm) @ 2'0" C/C. Both ways horizontally and vertically on the wall. This framing <b>would be covered by ¼" thk. Ply and 10mm thk gypsum board.</b>				
	1. R.M. cabin 8'-6" height	350.00	SQ.FT.		
	2. C.M. cabin 8'-6" Height	80.00	SQ.FT.		
	3. Conference hall Paneling 8'-6" Height	650.00	SQ.FT.		
	4. Column Paneling	352.00	SQ.FT.		
	5. Paneling in Hall up to 8'-6" HEIGHT	450.00	SQ.FT.		
13.	Aluminum partition for UPS room:-				
	1. UPS Room	70.00	SQ.FT.		
14.	Vertical blinds in R.M. Manager Cabin, Conference Hall & Windows:-	280.00	Sq.ft.		
15	Sofa Set (3 seats in One Sofa) :- Sofa set:- Complete sofa 16" high with rubber up holster and fabric finish of choice costing up to 150/ per mt.	6 nos.	EACH		
	TOTAL OF INTERIOR WORKS			Rs.	

## 2. ELECTRICAL WORKS:-

SNO	ITEMS	QTY	UNIT	RATE	AMOUNT
1	Wiring for light points, fan points, bell points, sockets etc. with 1.5 Sq.mm PVC insulated, 1100 V grade copper conductor wires				

Tender /Fur/BUPGB/RO/Dec /2019/1130-2019  
31.12.2019

	and 1.0 Sq mm copper earth wire and 1.0 Sq mm copper earth wire in concealed/surface using PVC (Heavy)25mm dia conduits, accessories such as bends, tees, saddles, draw boxes, mounting boxes, inner plates, cover plates, ceiling rose etc. (including chase cutting where where ever required) and chromium plated brass screws/rowel plugs etc.. The conduits to be laid in ceiling with proper clamps/wall/floor and filling the chase with cement mortar and finish the same in original form/wooden partition/above false ceiling with proper clamps (wherever required as per standard specification.				
	<b>NOTE:</b>				
	i) Each circuit shall have independent earth wire.				
	ii) Each point shall be earthed.				
	a) One light point controlled by one 6A modular one way switch.	70 nos	each		
	b) A set of two light points controlled by one 6A modular one way switch.	10 nos.	each		
	c) One wall fan point with 6A 3 pin socket controlled by one 6A modular one way switch. The switch should be at switch board level.	28 Nos.	each		
	c) One Ceiling fan point with 6A 3 pin socket controlled by one 6A modular one way switch. The switch should be at switch board level.	02 Nos.	each		
	e) One exhaust fan point with ceiling rose controlled by one 6A modular one way switch.	04 nos	each		
	f) One call bell point with ceiling rose/6A 3Pin socket controlled by one 6A modular bell push switch.	04 nos.	each		
	g) One 6A 5Pin socket controlled by 6A modular one way switch				
	i) Dependent	20Nos.	each		
	ii) Independent	10 nos.	Each		
	[FOR ITEM NO. "a" TO "h" ALL MOUNTING BOXES, INNER PLATES, MODULES, COVER PLATES ETC. SHALL BE CRABTREE MEGA SERIES, PLATINUM RANGE MATERIAL (OR EQUIVALENT OF ABB/M.K.) ONLY]				
2.	<b>CIRCUIT WIRING</b> :circuit wiring starting from DB to point control box/switch box using PVC (Heavy) 25mm dia conduits, accessories such as bends, tees, saddles, draw boxes, mounting boxes, inner plates, cover plates, ceiling rose etc. (including	600.00	RMT.		



Tender /Fur/BUPGB/RO/Dec /2019/1130-2019  
31.12.2019

	chase cutting where ever required) with 2x2.5 sqmm PVC insulated 1100V grade multi-stranded copper conductor wire and 1.5 sqmm PVC insulated earth wire and 1.5sqmm. PVC insulated earth Wire (color code to be used). Identification ferrules at both end to be provided. (Flexible conduit/elbow NOT allowed)				
3.	<b>POWER POINTS</b>				
	Same as serial no. 1, but wiring for 16A 6-Pin socket by using 4 sq mm PVC insulated 1100V grade copper conductor wire with independent 2.5 sqmm earth wire from D.B. to first 1st. Socket and 1st socket to 2nd Socket with 2.5 sqmm and 1.5 sqmm earth wire including providing and fixing of 16A 6-Pin socket with 16A switch				
	1. a) Power point with 4sqmm copper	30.00	EACH		
	b) Power point with 2.5sqmm copper conductor wires.	8.00	EACH		
	FOR ITEM NO. "a" & "b" SHALL BE CRABTREE (OR EQUIVALENT OF ABB/M.K.) MAKE MODULAR/DOUBLE MODULE WITH ALL ACCESSORIES ONLY]]				
4.	<b>A.C. POINTS:</b>				
	A.C. points i/c Box, MCB, Socket, Switch i/c 32 C MCB complete	8.00	NOS.		
5.	<b>DISTRIBUTION BOARDS:</b>				
	Supplying, installation, testing and commissioning of DOUBLE DOOR type distribution boards ORIGINAL FACTORY FABRICATED ONLY) of following specifications:				
	<b>A) 4-WAY TPN DB (POWER &amp; AC DB)</b>				
	INCOMER :63A 4P	1 NO.	EACH		
	OUTGOING: 32A SP MCB-6Nos.	6	No		
	25A SP MCB-6 Nos.	6	No		
	(FOR SPLIT/WINDOW A.C. & POWER POINTS)				
	<b>B) 12-WAY TPN DB (LIGHT &amp; FAN DB)</b>				
	INCOMER :40A 4P. MCB-1No.	1 NO.	EACH		
	OUTGOING: 10A SP MCB-12Nos.				
	C) Supplying & Fixing of 1 no. 40A DP	1 NO.	EACH		

Tender /Fur/BUPGB/RO/Dec /2019/1130-2019  
31.12.2019

	MCB in 4 way SPN DB ( FOR UPS OUT-PUT AT S/R)				
	D) 12-way SPN DB with 32A ELCB+D.P. 100mA sensitivity Controlling 6 nos. 10Amp. SP MCB and blanking plates. (FOR UPS OUT- PUT AT HALL)	2 NOS.	EACH		
6.	<b>MAIN PANEL</b>				
	A. ) Designing, manufacturing, installation, testing and commissioning of cubical type MAIL PANEL made from 16 SWG CRCA sheet steel, "I" type base M.S. Channel for grouting on floor complete with MCCBs, MCBs, Meters, C.T. etc. complete in all respect, insulated bus-bar with heat shrinkable PVC sleeve in suitable bus- bar chamber, wiring, name plates, danger plate, earth-bus etc.& comprising of compartments with hinged doors and rubber gasket, bus- bar chamber with bolted door and rubber gasket etc. The panel being of dust & vermin proof construction and to be painted with primer and smoke gray paint (minimum two coats) to look attractive. The panel should be comprising with the followings: Degree of Protection IP-54)	1 NO.	EACH		
	<b>INCOMER:</b> 100A HRC fuse base and bridge with HRC fuses Natural link for three phase four wire system- 1Set	1	Set		
	100A, 25KA, 4P MCCB -----1 NO.	1	No		
	100A 4-P, ON LOAD change over switch-1no.	1	No		
	160A capacity aluminum bus-bar with heat shrinkable proper insulation with color coaded.				
	Digital ammeter and voltmeter with selector switches.				
	R-Y-B phase indicators with 2A backup HRC fuse.				
	<b>OUTGOING:</b>				
	63A 4-P MCCB, 25KA,-----3Nos.	3	No		
	63A 4-P ON LOAD change over switch (FOR SYSTEM ROOM/ATM)-----1No.	1	No		
	40A 4-P MCCB, 25KA-----1 No.	1	No		

Tender /Fur/BUPGB/RO/Dec /2019/1130-2019  
31.12.2019

	32A TPN MCB, 25KA-----1No.	1	No		
7.	Supplying, installation, testing and commissioning of following light fixtures, fans etc.				
	a) PHILIPS/WIPRO/C.G./HAVELLS Make light fixtures				
	i) S/F of LED 2 X2 Light fixture instead of equal Luminous Led light of Philips by the name of Green Square Led Luminaries on	44	NOS		
	ii. S/f of down light LED Luminaries with reflector (Havel's/Crompton/Philips) complete With cutting of false ceiling 15 watt LED.	36	NOS.		
	iii) S/F of LED 4' wide ( patti ) Light fixtures	16	NOS.		
	iii. LED Strip Light (Cove Light)	500.00	Rft.		
	b) CROMPTON GREAVES make fans				
	i) 400mm SDX120 Wall Mounted fan.	28	NOS.		
	ii).Ceiling fan	03	Nos.		
	c) CROMPTON/GE-ALOSTHOM make				
	1. 18" Exhaust fans Commercial/ industrial with clamps, bolt/dash fastener by grouting on wall for Banking Hall.	2	NOS		
	2. 12" Exhaust fans with clamps, bolt/dash fastener by grouting on wall for Toilets.	2	NOS		
8.	<b>COMPUTER POINT</b>				
	a. Wiring with sx2.5 sqmm + 1x1/5 sq mm PVC insulated 1100 V grade multistranded copper conductor wires in 2 mm thick PVC conduit from UPSDB to computer point. Each point to have 3 nos 6A -5 Pin modular type sockets, one 6A indicator at below the top of table/counter and controlled by one 16A modular switch at above the table top in wooden partition with all accessories, inner/outer plates, metal box etc. and to be fixed on wooden	55	nos		

Tender /Fur/BUPGB/RO/Dec /2019/1130-2019  
31.12.2019

	partitions/by grouting on wall etc. as per the requirement at site.				
	b. Supply & fixing of porcelain fuse 63 Amp with neutral	08 no	Nos.		
	c. Cut out 63 AP	08 nos.	Nos		
	d. UPS wiring for 2 UPS	500.00	Mtrs.		
9.	<b>TELEPHONE POINT / DATA CABEL</b>				
a.	Providing/Laying of Cat 6 Cable	1400.00	Mt.		
b.	Patch Cord 2 Meter	55	Nos.		
c.	Patch Cord 1Meter	55	Nos.		
d.	I/O box	55	Nos.		
e.	RJ 45 Connector	220	Nos.		
f.	Tray	2 no.	No.		
g.	Cable Manger	1 no.	No.		
i.	12 U Rack  <u>Note:-</u> All products should be D-Link, Tp Link or equivalent International Quality.	1 no.	No.		
j.	Supply, Installation, testing and commissioning of 24 Port patch panel complete	3 nos.	each		
10	Supply & fixing of Intercom/EPABX points with GI / PVC box suitable for fixing of Telephone jack or 2 pin telephone socket as required with 2 pair of 0.63 mm Die annealed tinned copper conductor In PVC pipe for each telephone complete in all respect As per drawing and specification give by architect	40 nos.	each		
A.	Supplying and Fixing of 1x24-port switch for telephone wiring connections.	4	No.		
11.	a) Providing and fixing of following earth station as per IS:3043, with water pouring pipes, GI funnels, masonry brick chamber with CI cover, including excavation & refilling of pit after filling with charcoal, salt and sand, identification of pit as required.				
	i) 600x600x3.15mm Copper Plate Earth Station.	3	No.		

Tender /Fur/BUPGB/RO/Dec /2019/1130-2019  
31.12.2019

	ii) 50mm dia (16SWG & 7mtr. Length) GI Pipe Earth Station.	2	No.		
	b) Supplying, Laying and terminating of the following tapes/ wires with suitable G.I./copper clamps.				
	i) 25x3mm Copper strip with copper clamps.	80.00	Rmt.		
	ii) 1x8SWG Copper earth wire in PVC conduit inside the Branch.	100.00	Rmt.		
12.	CIRCUIT WIRING FOR POWER SOCKETS & A.C. Wiring				
a.	10 mm FR PVC Copper wire & 2.5 mm insulated copper earth wire in 25 mm dia. 2 mm thick pvc conduit ISI mark.	250.00	Rmt.		
b.	2.5 mm & 1.5 mm insulated copper earth wire in 25 mm dia. 2 mm thick pvc conduit ISI mark.	80.00	Rmt.		
c.	4 x 16 mm + 2 x 6 mm pvc wiring in 25 mm dia conduit for main line.	70.00	Rmt.		
d.	4x4 mm + 1 x 2.5 mm pvc wiring/UPS to MCB in 20 mm dia conduit for pipe.	100.00	Rmt.		
				Rs.	

*Certified by: -*

(Ar. Manmeet Singh Bajaj)  
Regd. Architect.  
M/s Bajaj & Associates,  
Sophia Market, Court Road,  
Saharanpur.

<b><u>AIR CONDITIONER WORKS BARODA UTTAR PRADESH GRAMIN BANK SITUATED AT REGIONAL OFFICE, RAE BARELI.</u></b>					
S.no	Particulars	qty	Unit	Rate	Amount
1	Fixing only & installation of stabilizer for :- 1. Split A.C. 3 nos 2. Cassette A.C. 8 nos	11	Nos		

Tender /Fur/BUPGB/RO/Dec /2019/1130-2019  
31.12.2019

	<i>Stabilizer will be provided by the bank.</i>				
2	Supply/fixing of stand for external unit of A.C. According to requirement of Cassettes A.C. 2 Ton 8 nos.	08	nos		
3	Supply/fixing of stand for external unit of A.C. According to requirement of Split A.C. 1.00 Ton & 1.5 ton 3 nos.  Location as per map/instruction of Architect.	03	nos		
5	Installation charges of Split A.C.:-  Location as per map/instruction of Architect. <i>A.C. Unit will be provided by the bank.</i>	03	nos		
6	Installation charges of Cassette A.C.:-  Location as per map/instruction of Architect. <i>A.C. Unit will be provided by the bank.</i>	08	nos		
6	Providing and fixing concealed copper pipe with wire proper insulation i/c cutting and repairing etc. for 1. Split A.C. 3 nos 2. Cassette A.C. 8 nos	700	Rft.		
7	Providing and Fixing Concealed Drain pipe with proper fixing & water proofing i/c cutting and repairing etc. for 1. Split A.C. 3 nos 2. Cassette A.C. 8 nos	500	Rft.		
	<b>TOTAL SAY</b>				

*Certified by: -*

**(Ar. Manmeet Singh Bajaj)**  
Regd. Architect.  
**M/s Bajaj & Associates,**  
Sophia Market, Court Road,  
Saharanpur.

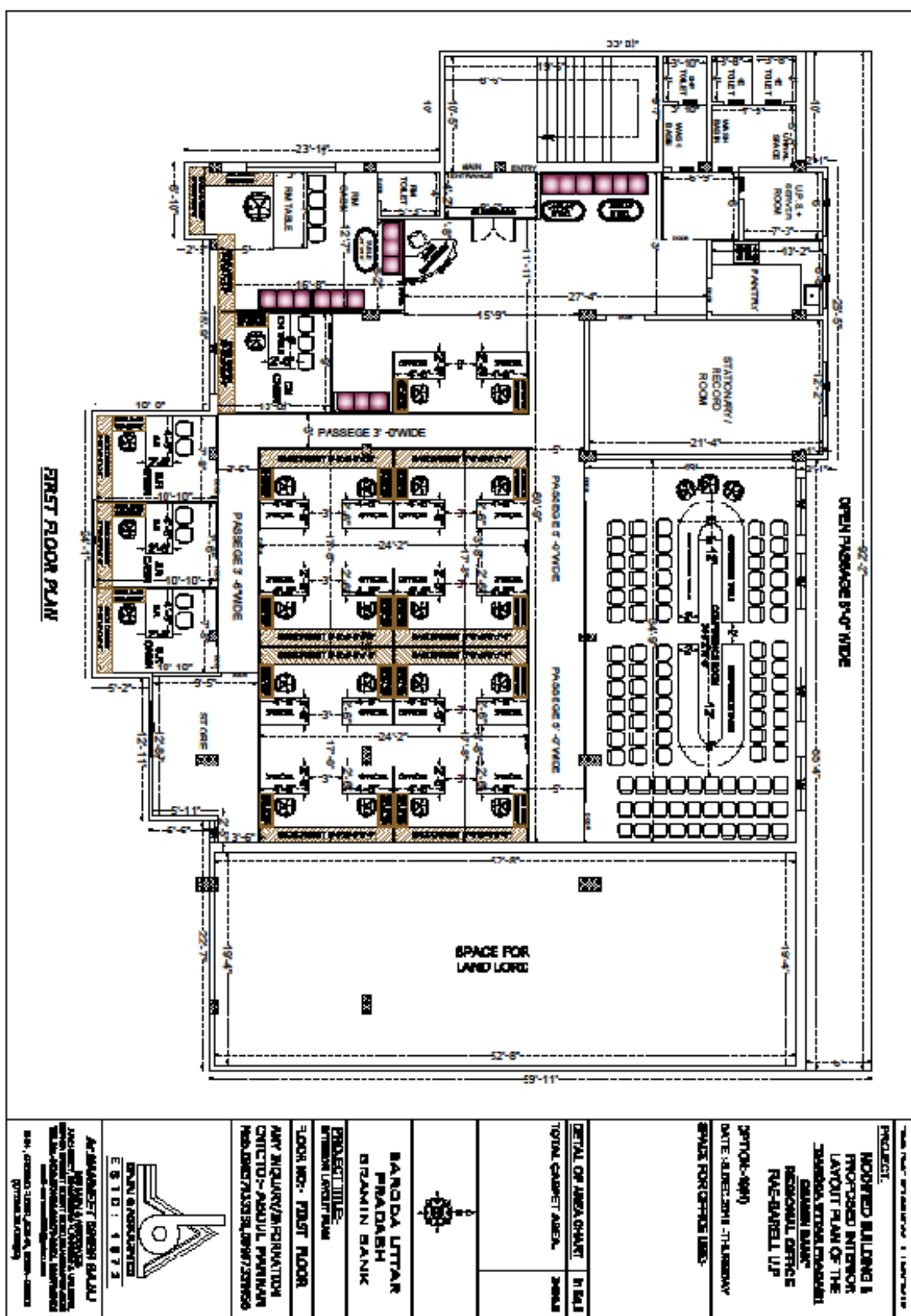

Tender /Fur/BUPGB/RO/Dec /2019/1130-2019  
31.12.2019

