



बड़ौदा यू.पी. बैंक  
Baroda U.P. Bank

### TENDER NOTICE

Baroda U.P Bank, Regional Office Jaunpur, intends to invite Tenders from empanelled furnishers/applicants for the **proposed interior work of our Branch-Shakarmandi** at Jaunpur as per enclosed offer Bid/BOQ proforma.

The completion period of work will be 30 days from the date of issue order. The work shall be executed under the supervision of our consulting Architect and as per specifications demonstrated in Offer Bid proforma/BOQ.

Offer Bid proforma/BOQ is attached with notice. Offer should be valid for a minimum period of 120 days from the last date of submission. No brokerage shall be paid. The sealed cover marked as Bid super scribing **"Re-FURNISHING WORK BID FOR SHAKARMANDI BRANCH"** be put in one sealed envelope addressed and submitted to **The Regional Manager, Baroda U.P. Bank Regional Office-Jaunpur, Pawan Plaza Civil Line Jaunpur U.P-222002** within 21 days from the day of publication of this advertisement /on or before 10-11-2021 by 17.00 hrs.

Any decision taken by bank at any point of time in connection with this process shall be final and conclusive and no claim or dispute from any quarter in that regard shall be entertained.

Date-21-10-2021

Enclosed: Offer Bid Proforma/BOQ

Regional Head

21/10/2021

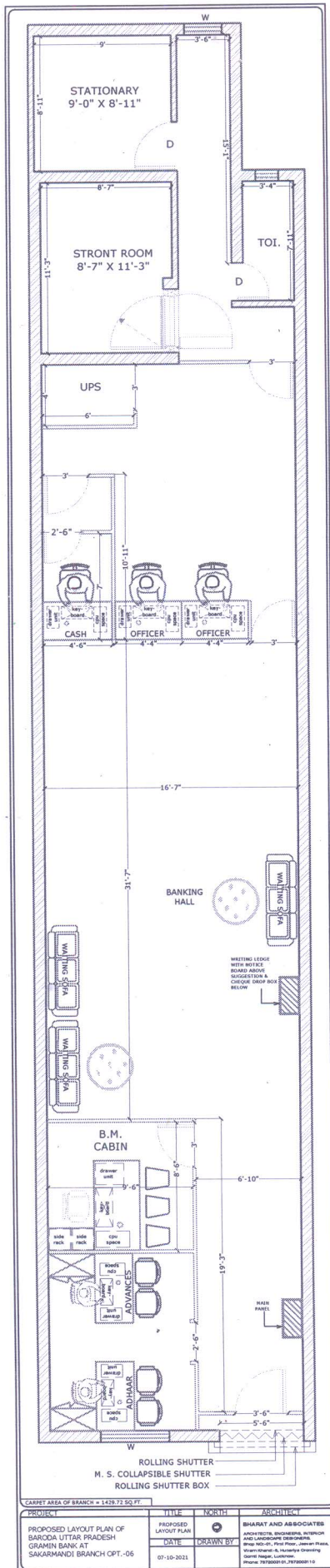



**PROJECT - ESTIMATE FOR FURNISHING WORKS.**

**BANK - BARODA UTTAR PRADESH BANK**

**BRANCH - Sakar Mandi Branch .**

**REGIONAL OFFICE- JAUNPUR**

**\*ALL ITEM TO EXCLUSIVE OF TAXES . Taxes to Mentioned By the Contractor.**

**\*ALL WORKS TO BE DONE AS PER TENDER CONDITIONS.**

**Laminate use only-Century,Green,Sunmica (Other Laminate is not Acceptable)**

S.NO.	DESCRIPTION OF ITEM	QUAN- TITY	UNIT
<b>A.</b>	<b>FURNISHING WORKS</b>		
<b>1</b>	<b>Main Entrance Door For Branch</b>	80.80	SQFT
	Providing and Fiing in Position toughened glass door with 12 mm thick toughned glass with 3M security film complete in all respects with Ozone patch fittings including top patch(OPF-02),BOTTOM PATCH (OPF-03)angle lock(OPL-01)TOP PIVOT (OFS-ACC-GDP)Floor Spring (FS8400) and handle (OGH-55) 32mm x 457 mm all item included )		
<b>2</b>	<b>FULL HEIGHT GLAZED &amp; UNGLAZED PARTITION (HT -8'-6")</b>	282.41	Sq.Ft
	Glazed Partition(upto false ceiling height only considered and above necessary ceiling supports to be provided) with Anodized Aluminium frame work, heavy sections (2mm thickness) of 2"x1.5" section, spacing of 2'0"x2'0" on bothsides and covered with 9mm thick BWR plywood finished with 1mm thick laminate of skirting & borders on both sides.Above 1'0"/2'6"/3'0" height partition, fixed with 8.0 mm bevelled glass with 3m sticker works door and teak wood beading with duco paint. Clear glass shall be finished with frosted film sticking over the glass of approved pattern and design. Rate to include providing cutouts and provisions to run electrical conduits, switches, etc..Cost include wastages, transports, loading, unloading charges, labours, materials, tools, lead, lift and etc.Complete as per drawings and instructions of the Architect.		
	The job shall also include for provision of laying conduits, switch boxes etc. The erection of partition shall include for expansion bolts cleats, clamps bolts, nuts, screws, rivets and other accessories, all complete up to the satisfaction of the Architect.		
	All door opening shall have rebated teak wood framework (size - 75mm x 50mm, as per profile) on vertical (2 Nos.) and horizontal (1 No.) sides, with melamine finish and rebate of 40mm x 12mm, all complete up to the satisfaction of the Architect.		
	the partition and doors shall have hinges floor springs/sliding arrangement/hydraulic door closer, mortise locks (Godrej make all), etc. The rate shall include cost of all materials, labour, T&P, wastages, etc. required for proper completion of work, all complete to the satisfaction of the Architect.		
<b>3</b>	<b>Low Height Wooden Partitions (partly glazed) and Flap Doors</b>		
	Same specification as in 1 but P/F half height partition of height 4'-6" with wooden laminate till 3'-0" and 1'-6" height 12 mm thick glass secured with D brackets including all hardware necessary with the same specs.as above.	56.05	Sq.Ft
<b>4</b>	<b>CASH CABIN PARTITION(HT-7'-6"ONLY)</b>		
	Decorative Grill (12mm thk)-hexagonal opening as per instruction of Bank's Engineer/Architect.) All exposed edges of Plywood shall be fixed with 1/8" C.P.Teak Lipping.		



	Providing and fixing of Cash Enclosures at height of 7'-4" with Anodized aluminium frame work, heavy sections (2mm thickness) of 2"x1.5", spacing of 2'0"x2'0" on both sides and covered 6mm thick BWR plywood finished with 1mm thick laminate of colours for skirting & borders. Partition shall have provision for opening and 19mm BWR plywood tray for challan receiving purpose. Cost include aluminium grill and fixed with teak wood beading and duco paint. Cost also include 3 Nos of Solid core flush Doors with sizes of 2'6"x7'0", fixed in the partition. Door shall have teak wood beading and lipping with duco paint. Door finished with 1mm thick laminate of white colour for base and red & blue for skirting of approved pattern. Door shall have 8mm glass fixed with teak wood beading and duco paint. Rate to include hardware's like brass hinges, godrej three nos of night latch, door closure, door stopper and handles. Cost also include cash transaction opening shall be provided with door arrangements made with BWR plywood frame work finished by laminate, duco paint and locking system. Cost include wastages, transports, loading, unloading charges, labours, materials, tools, lead, lift and etc. Complete as per drawings and instructions of the Architect.		
	Solid till 4'-0" then Aluminium Decorative Grill height till 7'-0" then again solid	172.50	Sq.Ft
5	<b>Glass Barrier on cash cabin and front glass for counter(12 MM NECESSARY)</b>	0.00	Sq.Ft
	Providing and fixing glass barrier (as per profile and design) in front of cash and ledger counter made out of 12mm thick polished edged float glass (Make – Modi guard or equivalent). It shall have 25mm x 20mm teakwood beading (as/shade approved by the Architect) to hold the glass from sides and top (optional). All teak wood surfaces shall be melamine polished. The rates shall include for cutting (in geometrical shape) and polishing the edges, all complete to the satisfaction of the Architect.		
6	UPS PARTITION to be made gypsum partition with aluminium frame section 2" x 2" along with paint complete work as per PNB Circular.	37.52	Sq.Ft
7	<b>Computerised Ledger &amp; Cash Counter</b>		
	Providing and placing in position ledger counter with top, vertical sides/dividers, skirting and fascia made out of 19mm thick water proof board with 1mm thick laminate (as/shade approved by the Architect) on all exposed surfaces. It shall also have 75mm x 40mm teak wood runners below the top and for footrest below. Every unit shall be provided with a side unit (size - W-500mm, H-750mm, D-500mm approx.), consisting of 150 mm deep drawer at top and a cabinet with open able/hinged shutter below.		
	The fascia of drawer and shutter of cabinet below shall be made out 19mm thick water proof board with 1mm thick laminate (as/shade approved by the Architect) and sides and bottom of drawer shall be made out of 12mm thick water proof ply. The side unit shall have CAM locks, handles, guides, sliding units, hinges, magnetic catcher's etc. of approved make. Every unit shall be provided with a keyboard drawer unit (size - W-550mm, H-100mm, D-300mm approx.) below. The counter shall have 100mm deep fascia, below the top, in which keyboard drawer unit shall be adjusted.		
	It shall be made out 19mm thick water proof board with 1mm thick laminate (as/shade approved by the Architect) and sides and bottom of drawer shall be made out of 12mm thick water proof ply. The unit shall have CAM locks, handles, guides, sliding units etc. of approved make. The job shall include for 6mm x 6mm grooves in between sides and open able drawers and hinged shutters. All the exposed edges of water proof board and ply shall be provided with 6mm thick teak wood/hard wood lipping. All teak wood surfaces shall be melamine polished and other internal surfaces shall be painted with two coats of synthetic enamel over one coat of primer, all complete to the satisfaction of the Architect.		
a	<b>High Level</b>	4.50	Rg.Ft
	High level (two levels) Computerised cash counter.		
	Lower level top shall be 900mm wide and at 750mm level from floor & upper level top shall be 250mm wide (and at 1150 mm level from floor		
b	<b>Low Level</b>	9.00	Rg.Ft
	Low level (two levels) Computerised ledger counter.		
	Lower level top shall be 900mm wide and at 750mm level from floor & upper level top shall be 150mm wide and at 900mm level from floor		



	<b>Tables</b>		
<b>A</b>	Manager's Table with Side credenza include the 10 mm thick glass	1.00	No.
	Providing and placing in position tables with top, vertical sides/dividers, skirting and modesty panel made out of 19mm thick water proof board with 1mm thick laminate (as/shade approved by the Architect) on all exposed surfaces. It shall also have 75mm x 40mm teak wood runners below the top and for footrest below. Every table shall be provided with a side unit (size - W-500mm, H-750mm, D-500mm approx.), consisting of 150 mm deep drawer at top and a cabinet with open able/hinged shutter below.		
	The facia of drawer and shutter of cabinet below shall be made out 19mm thick water proof board with 1mm thick laminate (as/shade approved by the Architect) and sides and bottom of drawer shall be made out of 12mm thick water proof ply. The side unit shall have CAM locks, handles, guides, sliding units, hinges, magnetic catcher's etc. of approved make. Every table shall be provided with a keyboard drawer unit (size - W-550mm, H-100mm, D-300mm approx.) below. The table shall have 100mm deep facia, below the top, in which keyboard drawer unit shall be adjusted. It shall be made out 19mm thick water proof board with 1mm thick laminate (as/shade approved by the Architect) and sides and bottom of drawer shall be made out of 12mm thick water proof ply. The unit shall have CAM locks, handles, guides, sliding units etc. of approved make.		
	The job shall include for 6mm x 6mm grooves in between sides and open able drawers and hinged shutters. All the exposed edges of water proof board and ply shall be provided with 6mm thick teak wood/hard wood lipping. All teak wood surfaces shall be melamine polished and other internal surfaces shall be painted with two coats of synthetic enamel over one coat of primer, all complete to the satisfaction of the Architect. Every table top shall be provided with 10 mm thick float glass (as per profile) with polished and beveled (25mm wide) edges all complete to the satisfaction of the Architect.		
<b>B</b>	Officer Table size 4'-6"x 2'-6"x 2'-6" With Side Table include the 10 mm thick glass	2.00	No.
	<b>SPECIFICATION AS PER MANAGER TABLE( PART -A)</b>		
<b>9</b>	<b>Writing Table &amp; Brochure Holder</b>	1.00	No.
	Providing and fixing in position (with rear wall) slip and customer writing desk (as per design) of over all size - 1200mm x 450mm x 300mm. The fixing shall include for expansion bolts, cleats, clamps, bolts, nuts, screws, rivets and other anodized accessories, all complete up to the satisfaction of the Architect.		
	The writing top and facia/sides shall be made out of 19mm thick water proof board with 1mm thick laminate (as per shade approved by the architect), on all sides and . It shall be laid over the base of 19mm thick water proof board (already considered in various items.) and fixed with araldite. It shall include for beveling and polishing at all the exposed edges. The rate shall include cost of all materials, labour, scaffolding, wastages, polishing and T & P etc. It shall be made out of 12mm thick water proof plywood (two surfaces of 6mm thickness, fixed together, where required) on rear and both sides.		
	The front shall be made out of 12mm thick glass (as per profile). It shall be fixed in the grooves, made in side members, in an inclined manner (as per profile in drawing enclosed) with a gap of 75mm (max.) in between. The space shall be further divided in four equal parts with help of 12mm thick water proof plywood. All edges of the glass shall be polished. All the exposed edges of water proof board and plywood shall be provided with 6mm thick teak wood/hard wood lipping. All teak wood surfaces shall be melamine polished and other internal surfaces shall be painted with two coats of synthetic enamel over one coat of primer, all complete to the satisfaction of the Architect		
<b>10</b>	<b>Complaint &amp; Suggestion Box &amp; CHEQUE DROP BOX</b>	2.00	No.
	Providing and fixing in position complaints/suggestion box (as per design) with hinged shutter of size - 450mm x 600mm x 150mm made out of 19mm thick water proof board with 1mm thick laminate (as per shade approved by the architect) on all exposed surfaces. It shall have 6mm thick water proof plywood on the back.		



	The hinged shutter shall be made out of teakwood (section - 25mm x 50mm) framework, with 4mm thick float glass, fixed with teakwood (size - 12mm x 12mm) beading. The unit shall have cam locks, handles, spring hinges, magnetic catchers etc. of approved make. All the exposed edges of water proof board or ply shall be provided with 6mm thick teak wood/hard wood lipping. All teak wood surfaces shall be melamine polished and other internal surfaces shall be painted with two coats of synthetic enamel over one coat of primer, all complete to the satisfaction of the Architect.		
11	<b>Notice Board</b> Providing and fixing in position notice board (as per design) of size - 900mm x 600mm x 150mm. The sides shall be made out of 19mm thick water proof board with 1mm thick laminate (as per shade approved by the architect) on all exposed surfaces. It shall have 12mm thick tack The front shall have 6mm thick float glass sliding shutter in two parts. It shall also have 19mm wide two track aluminium channel for sliding arrangement, all around, along with locking arrangement. board (Make - Cellotex or equivalent) wrapped with stretched blazer cloth (Make- Raymonds), of Rs. 200.00 per Mt. (approx.) in colour and pattern approved by the Architect. It shall be fixed with help of kail/partal wood (sect. 19mm x 25mm) frame work. It shall be covered with 6mm thick water proof plywood, on the back. All the exposed edges of water proof board and ply shall be provided with 6mm thick teak wood/hard wood lipping. All teak wood surfaces shall be melamine polished and other internal surfaces shall be painted with two coats of synthetic enamel over one coat of primer, all complete to the satisfaction of the Architect.	1.00	No
12	<b>Column /Wall Panelling (As per Direction BY Architect )</b> Providing & fixing in position 2"x2" kailwood frame and finished with 6 mm thk. Commercial ply on both sides with 1.0 mm thk. Laminate on top as per instruction of the Architect	83.09	Sq.Ft
13	Designer MDF board column cladding with CNC Cutting and backing of Acrylic /Metalim, Jaali to be painted in white duco mpaint and LED strip lighting to be included in this rate. The support system to be as above.	0	Sq.Ft
14	<b>Acrylic Emulsion with POP Base.</b> Painting on undecorated / decorated wall and ceiling surfaces with two or more coats of acrylic emulsion (Asian/ Berger make) (as / shade approved by the Architect) of approved brand. It shall include for preparing the surfaces clean, even and smooth with thoroughly brushing with broom, scratching with patti and sand papering respectively, so that the surfaces are free from oil, grease, dirt, mortar droppings & other foreign and loose matter. It shall also include for preparing the surface and filling of holes with plaster of paris before priming coat of whiting / approved primer. this work is included Front Elevation painting (including First Floor elevation painting ) Complete in all Respects . The rate shall include cost of all materials such as plaster of paris, whiting /primer, glue (Fevicol), indigo / stainer, brushes, sand paper, patti, dhoti, broom stick, clean water with storage and other containers, labour, scaffolding / ladder charges, cleaning of floors and other sundries etc., all complete to the satisfaction of the Architect.	4171.82	Sq.Ft.
15	<b>Low /full height Storage Racks</b> <b>S1-Storage (Low Height)</b> <b>Size- 6' Length X 2'-6" high X 1'-4" deep</b> <b>Ply Wood-19.0mm thick for side top and door &amp; back 6.0mm with shutters, shelf 19.0mm</b> <b>Shelf-19.0mm thick Ply</b> <b>Handle-Brush finish stainless steel</b> <b>Lock-Vijayan/Godrej</b> <b>All internal &amp; rear surfaces to be painted with two coats of enamel paint over a coat of primer / putty as directed to get a smooth finish. All instructed by Bank's Engineer/Architect.</b>	121.00	sqft



16	<b>ACP PANNELING (Baroda Uttar Pradesh Bank colour)</b>	70.00	sqft
	Rolling Shutter Box.		
	Frame Work-2" X 2" X 1.5 mm thick Aluminium Tubular section (Horizontal/Vertical) Jindal /Alstrong Make		
	Aluminium Composite Panel-3.0mm thick of approved colour with bonding		
17	<b>Main Panel Boxing</b>	36.00	sqft
	Providing & fixing in position with Anodized Aluminium frame work, heavy sections (2mm thickness) of 2"x1.5" section, spacing of 2'0"x2'0" on bothsides and covered with 12mm thick <b>Bison Board</b> with Front side to be laminate with 1mm thick & Inner Side of Storage Paste 1.5 Thick Aluminium Tubular Section of Approved Colour Pattern . Front Side of Storage Loovers/Aluminum Jali for Ventilation of the Panel & the Measurement of the Storage only front Facia of the Storage (Lenth x Height ) . All work Complete to the Satisfaction of the Bank /Architect .		
18	<b>Wooden Planter with Plants</b>	0.00	No.
	Providing and placing in position planter made of phenol bonded 19 mm thick commercial board with top front and sides finished in 1.0 MM Thick laminate including GI trough with sand and marble chips filling and artificial plants as per the approval of the architect of not less than Rs.750. The design of the grooves shall be as per detailed drawing and complete as per Architects direction		
19	<b>Synthetic Enamel</b>	1585.00	sq.ft.
	• Surface preparation.		
	• Rub with sand paper to ensure that the surface is dry and free from abrasions, dust, dirt, grease etc.		
	• Fill the holes etc. in the wood, if any with putty.		
	• Let the surface dry before application of paint.		
	<b>How to apply</b>		
	• Generally two coats of synthetic enamel finishes are required for satisfactory results.		
	• After priming the surface with two coats of wood primer white and one coat of putty apply first coat of paint and finish as recommended.		
	• Allow a minimum time gap of 8 hrs in between two coats.		
	• First coat should be sanded with emery paper grade 320/400 and wipe clean before application of subsequent coats.		
	• For make and shade please refer to the schedule of interiors, furniture &		
20	<b>Fire Extinguisher Rack</b>	0.00	No.
21	P&F vertical <b>Venetion blinds</b> made out of 100mm wide strips as/ shade approved including supports,	0.00	Sqft
22	Post construcion antitermite treatment	0.00	Sqft
	by drilling holes and injecting chemical as per		
	IS code from a reputed company with		
	10 years warranty certificate		
23	At the entrance of branch board showing opening & closing time of branch has to be displayed	1.00	Nos.
	<b>Total</b>		
	<b>GST EXTRA</b>		