

**BARODA U.P. BANK
REGIONAL OFFICE RAEBARELI**

(Sponsored by Bank of Baroda)

**(INTERIOR FURNISHING, ELECTRICAL, UPS, DATA CABELING
& AIR CONDITIONERS PIPING. VENDORS EMPANELLED WITH
BARODA U.P. BANK REGIONAL OFFICE, RAEBARELI CAN APPLY)**

**BARODA U.P. BANK
Regional Office RAEBARELI
Plot no.2400, Bargad Chauraha, Civil Lines,
Opp. saint James School & College
Raebareli.**

**TENDER FOR INTERIOR FURNISHING WORK, ELECTRICAL, UPS
DATA & AIR CONDITIONER PIPING WORKS**

AT

**GHURWARA BRANCH
DISTT. RAEBARELI**

Architect

Gunjan and Associates.
141, Sainik Nagar, 9th Lane,
Raebarelli Road, Lucknow-226002
Phone: 9838818489, 9839018489

**E-Mail: garun1511@gmail.com; arunjan@yahoo.com
studio@gunjanandassociates.com**

BARODA U.P. BANK
REGIONAL OFFICE RAEBARELI
(Sponsored by Bank of Baroda)

BARODA U.P. BANK
Regional Office RAEBARELI
Plot no.2400, Bargad Chauraha, Civil Lines,
Opp. saint James School & College
Raebareli.

Subject: Interior Furnishing, Electrical, UPS, Data Cabling & Air Conditioners Piping works for Baroda U.P. Bank at GHURWARA Branch, Distt. RAEBARELI

ISSUE OF TENDERS FROM	10.01.2022 TO 25.01.2022
PREBID MEETING WITH CONTRACTORS:	23.01.2022 at 3.30 pm
LAST DATE OF SUBMISSION	25.01.2022 up to 3.00 pm
TENDER OPENING DATE	26.01.2022 TIME 4.30 PM

(TENDERS WILL BE OPENED IN PRESENCE OF CONTRACTING AGENCIES OR THEIR AUTHORISED REPRESENTATIVES)

TENDERS CAN BE DOWNLOADED FROM THE BANK'S WEBSITE www.barodagraminbank.com OR CAN BE COLLECTED FROM THE FOLLOWING ADDRESS AND SHOULD BE SUBMITTED BY GIVEN DATE ALONG WITH NON RETURNABLE TENDER DOCUMENT FEES OF Rs. 500/- BY WAY OF DEMAND DRAFT IN FAVOUR OF **BARODA U.P. BANK AND PAYABLE AT RAEBARELI. (Our Bank Empanelled Furnishing & Electrical & Air Conditioner Piping Vendors Can Apply)**

PLACE OF TENDER COLLECTION / SUBMISSION:

BARODA U.P. BANK
Regional Office RAEBARELI
Plot no.2400, Bargad Chauraha, Civil Lines,
Opp. saint James School & College
Raebareli.

TENDER ISSUED TO: M/S _____

NOTICE FOR INTIMATION TENDER

To,

M/s. _____

Dear Sir,

Sub: - Interior Furnishing, Electrical, UPS & Data & Air Conditioner Piping works for Baroda U.P. Bank at GHURWARA Branch, Distt. Raebareli

1) Sealed, item rate, tenders are invited in the prescribed format from experienced contractors empanelled for carrying out jobs in RAEBARELI Region for execution of **Interior Furnishing, Electrical, UPS, Data & Air Conditioners Piping work for Baroda U.P. Bank at GHURWARA Branch Distt. Raebareli**. As per following details:

Name of the work	: Interior Furnishing, Electrical, UPS & Data & A.C. Piping works for Baroda U.P. Bank at GHURWARA Branch Distt. Raebareli
Earnest Money Deposit	: Rs. 18,000/- (Rs. Eighteen Thousands Only) by Demand draft / Pay Order payable at RAEBARELI & drawn in favor of BARODA U.P. BANK
Period of Completion	: 4 (FOUR) weeks
Validity of Tender	: 120 days
Date of Issue of Tender	: From 10.01.2022 on any working day during Office hours
Tender Cost	: Rs. 500/- (Rs. Five Hundred Only) Applicable only in demand draft collection of hard copy of tender from our office.
Last date of submission of Tender	: Up to 3.00 p.m. on 25.01.2022 .
Date & Time of opening the Tender	: 4.30 p.m. on 26.01.2022

2) The tender document can be downloaded from our bank's website www.barodagraminbank.com or obtained from the Office of the Regional Manager, **Baroda U.P. Bank, Regional Office RAEBARELI Plot no.2400, Bargad Chauraha, Civil Lines, Opp. saint James School & College, Raebareli** and should be submitted in original, dully stamped, and sealed in the same office with requisite tender fees.

3) The item rates under the contract include for full, final & entire completion of all works in all respects described in contract & as shown in drawings forming part of the contract. Contractor must quote item rates for all the items of work. Tenders will be opened in the presence of contracting agencies or their authorized representatives.

4) The tenders shall be submitted in a sealed envelope. The envelope shall be marked as Technical Bid, shall contain Volume- 1 of the tender, EMD in the form of Demand Draft / Pay Order and any other matter.

5) The Envelope of the contractors who have complied with the required EMD will be opened on the due date & time of opening.

6) Tenders are to be submitted in a sealed envelope cover super scribed "Tender for **Interior Furnishing, Electrical, UPS & Data AC Piping work for Baroda U.P. Bank at GHURWARA Branch, Distt. RAEBARELI.**

7) The tenderer must use only the tender forms issued for the purpose to fill in the rates intimation of tender quoted by letter, telegram / telex will not be acceptable.

8) Tenderers are advised not to make any alternation / modification in the tender documents, item of work or in any respect whatsoever. Violation of this requirement will make the Tender Liable for rejection.

9) In case of postal delivery, the tenderer has to ensure that tender is reached before the due date and time. The bank will not be responsible for damage in the transit and delay of receipt to tender, if any or sent by a special messenger. Tender received late shall be rejected.

10) Every page of the tender documents should be signed by the person or persons submitting the tender in token of his / their having acquainted himself / themselves with the General and Special Conditions of Contract, Specifications etc., as laid down. Any tender with any of the documents not so signed will be subjected to rejection.

11) No consideration will be given to a tender received after the time stipulated above and no extension will be allowed for submission of the tender. The **Baroda U.P. Bank** shall not be bound to accept the lowest tender and reserves the right to accept or reject any or all the tenders without assigning any reason whatsoever.

12) This notice inviting tenders, the conditions of tender and the duly completed form of tender etc. will form part of the Agreement to be executed by the successful tenderer with the bank.

The following document forming a part of tender are enclosed herewith

1. Introduction
2. Tender Notice
3. Special Instructions & Conditions
4. Letter of Offer
5. Form of Agreement
6. Preamble to B.O.Q.
7. Mode of Measurement
8. List of Approved Manufacturers for Materials
9. Bill of Quantities

This tender notice shall form part of the contract and non-submission of tender in the above manner will render your offer liable for rejection.

**FOR Baroda U.P. Bank
REGIONAL MANAGER**

Terms & Conditions for Vendors:-

1. Advance is not right of Vendor. The rights of advance to Vendor solely rests with Bank.
2. **Any request of advance from Vendor will only be entertained if work order is of more than Rs. 10.00 Lakhs**
3. Only Vendor having valid & active e-mail id should participate in Tender process.
4. Work order sent via e-mail will be considered accepted if there is no response within 3 days of e-mail sent from Regional/ Circle office.
5. Day to day communication/ instructions will be via e-mail and Vendor should be prompt in replying to every e-mail sent by Regional Office/ Circle office / Architect etc.
6. Quantity of any item can be modified at the time of furnishing as per need of the branch.
7. Vendor has to strictly provide items of make as per list attached on page no 18,19 & 20. Bank reserves the right to cancel the work order without any payment if quality of items are not as per list provided.

TENDER NOTICE

Subject: Interior Furnishing work for Baroda U.P. Bank at GHURWARA Branch Distt. Raebareli

**Sealed item rate tenders are invited by M/s Baroda U.P. Bank,
The REGIONAL HEAD, BUPG Bank, Regional Office, Bargad Chauraha Civil Lines, Opp.
Saint James School & College, Raebareli.**

1. The work to be completed within 4 **weeks** from 3rd days of the date of acceptance of work order placed by **M/s Baroda U.P. Bank**.
The tenderers are required to complete form of tender, price the schedule of quantities and sign each page of tender documents before submission. The completed set is to be enclosed in a sealed envelope addressed to:

**Regional Head Baroda U.P. Bank, Regional Office, Bargad Chauraha,
Civil Lines, Opp. Saint James School & College, Raebareli.**
2. Tenders will be received up to 23.01.2022 on **15.00 hrs.**
3. No tender will be received after the expiry of the time notified for receiving tenders under any circumstances whatsoever.
4. The tender will be opened at **16.30** hours on 26.01.2022 at above address in the presence of authorized representatives contracting agencies.
5. Tender shall remain valid for acceptance for a period of 90 days from the notified last date of tender submission.
6. The Bank reserves the right to reject any or all tender received without assignment of any reasons thereof.
7. The tender rate against each item of work / price indicated in the schedule of quantities and rates / price should be indicated both in words and figures. In case of any discrepancy, the rates indicated in words would prevail.
8. The rates quoted against each item of work / price should be for the complete finished item of work and include all labour, material, taxes, overhead, duties, etc. Any statutory change in the tax structure after opening of the tender shall be reimbursed by the Bank as per actual.
9. Each tender shall be accompanied by Earnest Money of **Rs. 18,000/- (Rs. Eighteen Thousand Only)** in the form of Pay Order / Demand Draft in favour of **Baroda U.P. Bank**, payable at **RAEBARELI**. Tenders without Earnest Money shall be summarily rejected.
10. The earnest money deposited shall not carry any interest and will be refunded to the unsuccessful tenderers. Earnest money paid by the successful contractor will be retained by the Bank till completion of the work.
11. Earnest money paid by contractor shall be forfeited by the Bank if contractor fails to undertake the job if he is communicated about acceptance of his rates.
12. All tenders in whom any of the prescribed conditions are not fulfilled or incomplete in any respect are liable to be rejected. This tender notice shall form part of the contract documents.

GENERAL CONDITIONS OF CONTRACT

Subject: Interior Furnishing work for Baroda U.P. Bank at GHURWARA Branch Distt. RAEBARELI.

General Instructions to Contractor

Inspection of sites: The contractor shall visit and examine the site and satisfy as to the nature and correct dimensions of work and facilities for obtaining material and shall obtain generally his own information on all matters affecting the execution of work. No extra charge made in consequence of any misunderstanding or incorrect information on any of these points on the ground of insufficient description will be allowed. All expenses incurred by the contractors in connection with obtaining information for submitting this tender including his visit to site and efforts in compiling the tender shall be borne by the tenderer and no claims for reimbursement thereof shall be entertained.

Safety Regulations: The contractor shall take all the necessary precautions while working and to safeguard adjacent property, Bank's property, Bank's employees, and traffic persons

Compliance to local laws: The contractor shall conform to the provisions of any Act of the Legislature relating to the work and to the Regulation of Bye Laws of any authority. He shall also obtain the permission of the Municipality or any other Authorities if required under the existing rules.

Site cleaning: All the rates quoted are inclusive of removal of rubbish / debris collected during the progress of work, rejected material and clearance of site before and after the work is completed. Not more than one truck load shall be stored that to for not more than 3 days. The contractor shall arrange to remove the same immediately. If the contractor is failing to remove the same and the expenses shall be recovered from the contractor and he will not dispute for the expenses so incurred.

Vouchers / bills: Contractor shall upon the request of the Bank furnish bills, invoices, accounts, receipts and other vouchers for all materials brought on site to prove that the material purchased are as mentioned in the specification.

Contractor's responsibility: The work will from time to time be examined by Project Architect, but such examination shall not in any way exonerate the contractor from the obligation to remedying any defects which may be observed at any stage of the work or after the same is completed.

Dismissal from work: The contractor shall upon the written request of the Project Architect immediately dismiss from the work any person employed by him thereon, who may in the opinion of the authority be incompetent or misconduct himself and such person shall not be again employed on the work, without the permission of the bank.

Order of work, etc.: Bank reserves the right to fix the order in which the various items of work involved are to be executed. However, the contractor shall be responsible for the completion of the entire job within the item limit specified failing which liquidated damages as mentioned in clause No.49 shall be recovered from the contractor.

Commencement of work: The work must be started within **3rd days** upon accepting the work order and the programme for carrying out the various jobs shall be drawn out in consultation with the Project Architect. Adequate labour force shall be provided to complete the work within the specified period. Proper security aspects should be taken care of by adequate vigilance in view of the importance of the building. Default in compliance with the programmes so finalized shall entail operation of liquidated damages as stated.

Subletting the work: The contractor shall not directly or indirectly sublet the work to other party without

written permission from the bank.

Quantities of works are provisional: The quantities mentioned in schedule are provisional and likely to increase / decrease to any extent or may be omitted thus altering the aggregate value of the contract. No claim for loss of profit / business shall be entertained on this account.

Distribution of work: The Bank reserve the right to distribute the work for which quotation have been called, among more than one parties, if found necessary. No claim in this respect shall be considered and the contractor agrees to cooperate with other agencies appointed by the bank.

Third party damage: The contractor shall be responsible for all injury to persons, animals, building, building structure, any damage to road, streets, footpaths and shall rectify it at its own cost.

Insurance cover: All the workers of the contractor as well as his sub-contractor must be properly covered by an Insurance Policy under Workman's Compensation Act and Fatal Accidents Act. The contractor at his own expenses arrange to effect and maintain until the virtual completion of the contract, insurance policy in the joint name of the Bank and the contractor against this risk to be retained by the Bank until the virtual completion of the work, and indemnify the Bank from all the liabilities arising out of such events. In case of delay, contractor shall arrange to extend insurance policy till work is completed.

Delay & Extension of time: All the work should be completed within the specified period in the tender. If the work is delayed due to the reasons beyond the control of the contractor, he should applying to the Bank explaining, therein the reasons for such delays, immediately and if in the opinion of Bank's authorities the delay is justified, the contractor shall be granted extension in time limit.

Certificate of virtual completion: As soon as the work is completed, the contractor shall inform in writing such completion to the **PE department Regional office & Project Architect, Ar. Gunjan Kapur Gunjan and Associates.** 141, Sainik Nagar, 9th Lane, Raebarelli Road, Lucknow-226002. Who will inspect the work and if satisfied will issue the certificate that the work has been virtually completed and the defects liability period shall commence from the date of such certificate.

Defect liability period: The defects or other faults which may appear during the defect liability period which is 12 months after the virtual completion of the work, arising in the opinion of the bank due to inferior quality of material or bad workmanship not in accordance with the contract, contractor shall make good at his own cost within a reasonable time. In case of default, Bank may employ and pay other agencies to amend and make good such defects and all expenses / damages / losses shall be recoverable by Bank or may be deducted from any money due to the contractor

Arrangement of work: The contractor shall organize the work in such a way that the office users or the nearby public area put to no hardships and the working of the office is not affected. The contractor shall take adequate care during the progress of work to protect the office property like stationery, furniture, etc. In case of any damage, the same shall be made good by the contractor. Contractor is agreed to work after office hours for which no extra cost shall be considered.

Stacking of material: The contractor is not to stack any of his material recklessly so as to endanger the safety of the building and cause any nuisance to the occupants and the public.

Extra charges: It must be clearly understood that all the conditions of contracts are intended to be strictly enforced and that no extra charges in respect of extra work will be allowed unless they are clearly outside the spirit and meaning of the condition and unless such work shall have been ordered in writing.

Protection of material and work: The contractor shall be responsible for storing and watching his own material and protecting the work at his own cost. The contractor and his worker will be allowed to use lift after office hours. However, no paint drums or heavy bag of cement / paint will be allowed to be taken into the lift. Any damage / spoiling of lift / floor / dado caused during such act will have to be made good by the contractor at his own expenditure.

Water supply: The contractor shall make his own arrangement for water required for the work. In case the water is available and supplied by the Bank, the charges for the same shall be recovered at the rate of 1% of value of the work executed. In case water supplied by the Bank, the contractor shall make his own arrangement for the storage, pipeline from point of take off to the required location.

Electric supply: The contractor shall make his own arrangement for Electricity required for the work.

Approval of samples: The contractor shall furnish well in time before work commence at his own cost, colour samples, samples of material or workmanship that may be called by Project Architect for approval. Rates quoted shall cover for such preliminary work.

Workmanship: The work involved calls for a high standard of workmanship combined with speed. All the glass panes, door handles / hinges, electric fitting, fans, furniture records, floors etc. are to be thoroughly cleaned after work is completed. Any damage to the flooring, tiles, dado, paneling or any other part of the building, etc. shall be made good at the cost of the contractor to the entire satisfaction of the Bank. Contractor shall make all arrangements for shifting of furniture / records and keeping the same in its original position after he finishes the work on daily basis. The contractor at his own cost shall provide brown paper, polythene, tarpaulin etc. for protecting furniture / fixtures, paneling, electrical, fittings, records, etc.

Interpretation of documents / drawing: Except where otherwise provided in the contract all questions and disputes relating to the meaning of the specifications, design drawings and instructions herein before mentioned and as to the quality of workmanship or materials used for the work or as to any other question, claim, right, matter or thing whatsoever, in any way arising out of or relating to the contract, designs, drawings specifications, estimates, instructions, orders or these conditions or otherwise concerning the works, or the execution or failure to execute the same whether arising during the progress of the work or after the completion or abandonment thereof shall be referred to the competent authority of the Bank whose decision shall be final and binding on the contractor.

Use of scaffolding: The contractor shall allow the use of scaffolding erected by them to any other agency employed by the Bank during the contract period without any payment.

Provisional Item: If ordered by the Bank, contractor shall be required to carry out provisional items at the same conditions and rates as applicable for this contract.

Measurements of all concealed items: Measurements of all concealed items of work and extra item if any, shall be got recorded by the Project Architect before they are checked up.

Measurements: All measurement tapes shall be of steel and all scaffolding and ladders that may be required for taking measurements shall be supplied by the contractor.

Cleaning during the work: The rates quoted shall include cleaning of ceiling roses, electric switches, boards, window panes etc. after the repairing leaving the site neat and tidy from time to time.

Complying I.S. specification: Unless otherwise mentioned in the contract, the latest Indian Standard Code for material specifications, method of work, and mode of measurements shall be followed. The payment shall be made on the basis of actual measurement of work done to be submitted along with bill

Rate to include: The rates quoted by the contractor shall cover for work at any height in the premises for all finished items under this contract. The rate quoted shall be inclusive of all material cost, wastage, labour, loading, profit, taxes if any, scaffolding, transport, supervision, spot light arrangement and any other means to complete the job. **Octroi, sales-tax, works contract tax or any other taxes present or future to be included in the rates so quoted.**

Price Fluctuation: The rates quoted by the contractor shall be firm throughout the currency of contract (including extension of time if any granted) and will not be subject to any fluctuation due to variation in the cost of material or labour.

The successful tenderer if called upon to do so, shall obtain a letter from the approved trade manufacturer whose product is used, if found necessary by the Bank confirming that the manufacturer shall provide all the technical assistance and supervision during the execution of the work at all such places as directed and the contractor shall bear the expenses, if any, for such supervision and technical assistance supplied by the trade manufacturer.

Testing of materials: If at any point of time during the work, if Bank authorities desire to carry out the tests of certain materials, the contractor shall arrange for the same and submit the test report without any extra cost to the Bank.

The contractor shall note that they should bring to the notice of the PE department/Architect any breakage in glass window before starting work. However, if any glass window is found to be broken during the repairing work, the same shall be replaced by the contractor at his own cost.

Conditional tenders: Conditional tenders are liable to be rejected.

Rates of non-tendered items: The successful tenderer is bound to carry out any item of work necessary for the completion of the job even though such items are not included in schedule of quantities.

Abandonment of work: If in any case the work required to be abandoned, the contractor shall not be entitled for any claims and he will be paid as per the actual work done till that period.

The Bank reserves the right to accept / reject the lower or any or all tenders in part or in whole without assigning a reason therefor.

Decision of the Bank shall be final and binding on any matter connected with the work. The matter of any dispute shall be decided after mutual discussions based on the terms and conditions of this contract. However, if the matter can not be resolved then the same shall be referred to the respected, qualified person in the field agreed to both the parties and his opinion shall be binding on both the parties. However, this is precourse to any legal action in this regard.

Incomplete quotation: Incomplete quotations shall be summarily rejected

Payments: The contractor shall be paid by the Bank from time to time under interim payment on account of works executed and when the value of work equal to the approximate value named in the Appendix as 'Value of work for Interim Certificate' has been executed in accordance with this contract.

When the work has been virtually completed and Bank's Architects / Engineer has certified in writing that the work has been completed on the basis of detailed measurements and has made a final scrutiny and that there is no dispute items, rates, ad quantities, the contractor shall be entitled to the payment of the final bill in accordance with the final certificate which will be honored within the period specified in the Appendix as period of honoring final certificate.

The contractor shall be paid by the Bank within the period named in Appendix (period of honoring certificate) after such certificate has been delivered to the employer by the Project Architect. Project Architect has power to withhold any certificate in the work or any part thereof are not carried out to his satisfaction or the contractor fails to show the desired progress or fails to follow the instructions given or in case of breach of this contract.

For water proofing works on traces, bathroom, WC, Chajja, work has to be executed through the agency specialized in waterproofing. Contractor will have to submit a guarantee of 10 years on stamp papers as per the format to be prescribed by the Bank.

Earnest Money Deposit of successful tenderer shall be treated as security deposit with additional amount required to fulfill requirement of **2% of Tendered Amount (Inclusive of E.M.D.)**. The contractor should pay this amount to the Bank by DD or PO at the time of submission of tender. This amount shall be retained by the Bank till the work is virtually completed and all amounts relating thereto settled. Second part of security deposit shall be built through the retentions from interim and final bills of the contractor and the amount of retention shall be as stated in the Appendix.

When the certificate of the virtual completion is issued to the contractor the security deposit in the form Security Money shall be refunded, provided that the contractor has fulfilled all the conditions of contract and further provided that the employer has no claim for forfeiture of part or whole of the said deposit. The retention money built up through retention from interim and final bills will be returned to the contractor after the expiry of defect liability period, subject to deductions for any appropriations thereof required to be made by the Bank as per conditions of the contract. The contractor should note that no interest will be allowed on his security deposit. It will be minimum of 5% of Final verified Bill.

The contractor is requested to sign each page of the quotation and put rubber stamp, seal below his signature and seal the quotation in an envelope.

Liquidated damages: If the contractor fails to maintain the required progress or to complete the work and clear the site or before the contract or extended date period of completion, he shall without prejudice to any other right, pay as agreed compensation amount of **1 %** of contract amount per week of delay subject to maximum of **10 %** of contract amount as liquidated damages.

Records & measurements: Measurements shall be taken jointly by Project Architect and contractor and shall without extra charges provide assistance with appliance, labour and other things necessary for the work and measurements will be signed and dated by both the parties on completion of measurements.

Safety measures: The contractor at his own cost shall provide tarpaulins on the external side of the building at the time of breaking plaster etc. to safeguard adjacent property, Bank's property, employees, traffic, etc. The contractor shall follow all the safety measures while carrying out the work. Employer that is Bank shall not be liable for any compensation due to accident, any mishap or negligence.

If there is delay in commencement of work for any reason, the employer that is Bank shall not be liable for any compensation.

If at any point of time during the progress, it is observed that the contractor is not progressing the work with due diligence, care and lagging much behind the schedule or fails to gear up the work despite instructions from Project Architect, the employer (Bank) reserves the right to terminate the contract with 7 days notice. In such case, the contractor shall be liable to pay the employer any extra cost involved for the completion of the said work and will not obstruct any way in completing the work through other agency. After completion of entire work the contractor shall be paid for the actual work executed by him at the quoted rates after deducting any claims, damages. In case of such termination the security deposit held by the Bank will be forfeited

Although the number of coats of paints / polishing / white washing are specified the contractor will have to additional coats if the surface is not to the satisfaction of the Project Architect and there shall be no extra payment on account of such coats

First Aid: The contractor shall be responsible for all first aid and he shall keep the site fully equipped to meet such emergency.

Supervision: The contractor is required to have on site during all working hours a competent supervisor (acceptable to Bank) who will be responsible for the conduct of worker and who has authority to receive and act on such instructions issued by the PE Department/Architect of Bank.

All work shall be carried out in a workman-like manner to the entire satisfaction of the Architect / PE Department.

Contractor shall follow all rules / regulations in force and should possess the license for employing labour and also follow all safety measures, labour bye law and shall be responsible for any lapse.

Transfer of Tender Documents: Transfer of tender documents purchased by one intending tenderer to another is not permissible.

Safety: The contractor shall carry out the entire work in a workman like manner having full regard for the safety of the men working at site. All safe practices shall be strictly adhered to by the workmen of the contractor like wearing helmets, safety belts when working at heights, gloves when handling sharp objects and reinforcement, eye shields during welding, safety shoes, etc. The contractor shall protect sides of openings in floor slabs, edges of slabs, stairs, stairwells etc. with barricades, warning signs / lights and educate all his workmen regarding following safe working practices. He shall provide first aid boxes at site.

In spite of following safe methods, in case of any unfortunate accident, the contractor shall indemnify the employer against any expenses or claims towards treatment or compensation.

A Daily Diary Register: A daily diary register (with cement and steel stock statement) will be kept in the Engineer's Office or the site office. The contractor or his representative will furnish every day at 9.00 hrs. details of work for the day proceeding and the diary will be written up every day and jointly signed by the Engineer and the Contractor or their representatives in token of its correctness.

Nuisance: The contractor shall not any time do cause or permit anyone to do or cause any nuisance on the site or do anything which shall cause unnecessary disturbance of inconvenience to the Employer or to the owners, tenants or occupiers of other properties near the site and to the public generally.

Rights, remedies and powers:

- I) Termination of contract due to contractor's default. If the contractor:
 - a. Abandon the contract

- b. At any time defaults in proceedings with the works with due diligence and continues to do so after a notice in writing of seven days from the Engineer or Project Architect or Employer, or
- c. Commits default in complying with any of the terms and conditions of the contract and does not remedy it within **3RD days** after a notice in writing is given to him in that behalf of the Engineer or Project Architect or Employer.
- d. Persistently disregards the instructions of the Engineer, Project Architect or contravenes any provision of the contract, or
- e. Fails to remove materials from the site or to pull down and replace work after receiving from the Engineer, Project Architect notice to the effect that the said materials or works have been rejected.
- f. Fails to complete the works or items of work on or before the stipulated date (s) of completion, and does not complete them within the period specified in a notice given in writing in that behalf by the Engineer, or Project Architect of Employer, or
- g. Offer or gives or agrees to give to any person in the Employer's service or to any other person on this behalf, any gift or consideration of any kind as an inducement or reward for doing or forbearing to do so for having done or forborne to do any act in relation to the obtaining or execution of this or any other contract for the Employer, or
- h. Shall enter into a contract with the Employer in connection with which commission has been paid or agreed to be paid by him or to his knowledge, unless the particulars of any such commission and the terms of payment thereof have previously been disclosed in writing to the Employer / Engineer, or
- i. Shall obtain a contract with the Employer as a result of ring tendering or other non-bonafide methods of competitive tendency, or
- j. Being an individual, or if a firm, any partner thereof, shall at any time be adjudged insolvent or have a receiving order or order for administration of his estate made against him or shall take any proceedings for liquidation or composition (other than a voluntary liquidation for the purpose of amalgamation or reconstruction) under any Insolvency Act for the time being in force or make any conveyance or assignment of his effects or composition or arrangement for the benefit of his creditors or support so to do, or any application be made under any Insolvency Act for the time being in force for the sequestration of his estates or if a trust deed be executed by him for benefit of his creditors, or
- k. Being a company, shall pass a resolution or the court shall make an order for the liquidation of its affairs, or a appointed or circumstances shall arise which entitle the court or debenture holders to appoint a receiver or manager, or
- l. Shall suffer an execution being levied on his goods and allow it to be continued for a period of 21 days, or
- m. Assigns, transfers, sublets (engagement of labour on a piece work basis or of labour with materials not to be incorporated in the work, shall not be deemed to be sub-letting) or attempts to assign, transfer or sub-let the entire works, or any portion thereof without the prior written approval of the employer.
- l) The Bank may, without prejudice to any other right or remedy which shall have accrued or shall accrue thereafter as the Employer by written notice determine the contract either as a whole or in part.

II) Upon such determination of the contract in whole or in part, the security deposit with the Employer in respect of the contract shall stand forfeited to the Employer without in any way effecting the rights of the Employer.

III) Rights of the employer after determination of the contract due to contractor's default.

The Engineer shall on such determination have powers to:

- a. Take possession of the site and any materials equipment, plant, implements stores etc. thereon, and / or
- b. Carry out the incomplete work by any means at the risk and cost of the contractor.

IV) On determination of the contract in full or in part, the Engineer shall determine what amount, if any, is recoverable from the contractor for completion of the works or part of the works or in case the works or part of the works is not to be completed, the loss or damage suffered by the Employer. In determining the amount, credit shall be given to the contractor for the value of the work executed by him up to the time of cancellation or the value of contractor's materials to be present so as to record the measurements in his presence. If the contractor fails to be present in response to the notice, the recording of measurements shall be preceded with ex-parte and the measurements as recorded shall be binding the contractor.

V) The Bank shall have the right to use contractor's plant, machinery and materials on the balance work but shall not in any way be responsible for any damage or loss of the same and the contractor shall not be entitled to any compensation thereof.

APPENDIX TO THE CONTRACT DOCUMENTS

Subject	:	Interior Furnishing, Electrical, UPS & Data AC Piping work for Baroda U.P. Bank at GHURWARA Branch, Dist- Raebareli
1. Defect liability period	:	12 months from the date of virtual Completion of work.
2. Date of commencement	:	3rd days after the contract is accepted by The contractor
3. Date of completion	:	4 (FOUR) weeks.
4. Liquidated damages	:	1% of contract amount per week / day of delay Subject to maximum of 10% of contract amount For the works of less than 6 month completion Period.
5. Period of honoring final certificate	:	45 days
6. Period of honouring certificate	:	15 days
7. Security Money	:	2% of the tendered amount, will be sought as Security Money inclusive of EMD and will be released on completion of work.
8. Retention money	:	5% of the bill value will be deducted as retention subject to maximum security deposit. the retention money so held shall be refunded after defects liability period of 12 months of full & final completion of job.
9. Earnest Money to be submitted	:	Rs. 18,000/- (Rs. Eighteen Thousand Only) by demand draft or pay order on any nationalised Bank drawn in favour of Baroda U.P. Bank payable at RAEBARELI.

To,
BARODA U.P. BANK
 Regional Office RAEBARELI
 Plot no.2400, Bargad Chauraha, Civil Lines,
 Opp. saint James School & College
 Raebareli.

Dear Sir,

LETTER OF OFFER

**Sub: Interior Furnishing, Electrical, UPS & Data & A.C. Piping works for Baroda U.P. Bank
 at GHURWARA Branch, Distt. RAEBARELI.**

With reference to the tender regarding the above work invited by you, we have to state as under.

We declare that before quoting the rates, we have visited the site and our rates are as per present site condition. Further we herewith deposit **Rs. 18,000/- (Rs. Eighteen Thousand Only)** as Earnest Money for due execution of the works at my /our tendered rates as per the Terms of Contract. In the event of this tender being accepted, I / We agree to enter in to and execute the necessary contract documents as required by you.

DD No.: Drawn on:
 Dated: Amount :

As required by you, I / We are returning herewith the documents (in single) duly signed by us at each page in token of our acceptance of the provisions in the documents.

We hereby offer to execute and complete the whole of the works strictly in accordance with the said conditions of contract, special conditions of contract, specifications and drawings at the rates set out against each of the items of work in the schedule of quantities. the total cost included in the above is Rs. _____ /- (Rs. _____ only).

We have carefully read and clearly understood the conditions of contracts, special conditions of contract, special conditions of contract and specifications. We agree to complete the work at the rate / rates quoted by me / us in the schedule of quantities and within the specified time from the date of work order awarding the work to us.

We understand the work is to be completed within scheduled time period.

Our rates are firm, include and cover all cost, expenses, liabilities of every description and all risk of every kind to be taken in execution and handing over the work to the Bank. The VAT, Service Tax, Sales Tax (State & Central), works contract tax, octroi, duties, municipal tax, general tax and any other taxes applicable and prevailing from time to time on such item for which the same are leviable and the rates quoted by us are inclusive of the same.

Thanking You,

Yours faithfully,

Name :
 Address :
 Sl. No. :
 Mobile No. :

(Fax. No) :

FORM OF AGREEMENT

(On stamp paper of Rs.100/)

THIS AGREEMENT made this Day of,2022..... between Baroda U.P. Bank Plot no.2400, Bargad Chauraha, Civil Lines, Opp. saint James School & College Raebareli. (hereinafter called “ the owner “) of one part and.....

..... Of or whose registered office is situated at

..... (hereinafter called : “ the Contractor “) of the other part.

WHEREAS the Owner is desirous of

..... (hereinafter called “ the work “) at

and has caused drawings and Bills of Quantities showing and describing the work to be done to be prepared by or under the direction of

AND WHEREAS the Contractor supplied the owner with a fully priced copy of the said Bills of Quantities (which copy hereinafter referred to as “ the Contract Bills “) AND WHEREAS the said drawings (hereinafter referred to as “ the Contract Drawings “) and The Contract Bills have been signed by on behalf of the parties hereto : AND WHEREAS the contractor has deposited the sum of Rupees.....

..... With the owner for due performance of this Agreement.

NOW IS HEREBY AGREED AS FOLLOWS :

For the consideration hereinafter mentioned the contractor will upon and subject to the conditions annexed carry out and complete the work shown upon the contract drawings and described by or referred to in the Contract Bills in the said conditions.

The Owner will pay the Contractor the sum of Rupees

..... (hereinafter referred to as “ the Contract Sum “) or such other sum as shall become payable there under at the times and in the manner specified in the said conditions.

The term “ ARCHITECT “ in the said conditions shall mean the said in the event of his death or ceasing to be the “ ARCHITECT “ for the purpose of this contract, such other person as the owner shall nominate for that purpose, not being a person to whom the contractor shall object for reasons considered to be sufficient by employer. Provided always that no person subsequently appointed to be the “ ARCHITECT “ under this contract shall be entitled to disregard or overrule any certificate or opinion or decision or approval or instruction given or expressed by earlier “ ARCHITECT “.

The said conditions there to shall be read and constructed as forming part of this agreement, and the parties hereto shall respectively abide by, submit themselves to the conditions and perform the agreements on their parts respectively in such conditions contained.

Any dispute arising out of the contract shall be referred to Arbitration as per the condition stipulated in clause of “ Special condition of contract “.

AS WITNESS the hands of the said parties.

Signed by the said
In the presence of witness

OWNER

NAME:

ADDRESS:

Signed by the said
In the presence of witness

CONTRACTOR

NAME:

ADDRESS:

LIST OF FURNISHING MATERIAL

PARTICULARS	Make of Material
Plywood/Block Board	Archid / Century / Green (6mm, 9mm, 12mm, 19mm)
Laminates	Greenlam / Century / Archid. (1.0mm thick)
Soft Board (Pin up Board)	Jolly Board, Stylex
Gyp Board	India Gypsum/Armstrong/Gyproc
Metal Ceiling	ClimaPlus™ Ceiling tiles
Vertical Blinds	Vista, Universal, Maac
Screws	GKW / Mettle fold , Hindalco
SS Hinges	Godrej / Hardwyn
Hardware	Dorma, Hardwyn, Godrej
Drawer shutter lock	Godrej , Link, Dorset
Ball catch	Dorma, Hardwyn, Godrej
Door lock / Handles	Dorma, Hardwyn, Godrej
Veneer	Archid / Century / Green
Adhesives	Fevicol, Mahacol, Jeevanjor
Wood Preservatives	Black Japan.
Door closure	Dorma, Hardwyn, Godrej
Glass	Modi / Asahi / Saint Gobain
Glass tinted	Same as above.

Melamine Polish	Asian Paint, Nerolac.
	French. Zinc oxide.
Paint	Burger, Nerolac, Asain
AC Grill	Air Products, Omicron, Patrawala
Vitrified tiles	Marbonite Jhonson, Kajaria
Ceramic Tiles	Jhonson & Jhonson, Kajaria,
Alu. Door & Window Sections	Jindal / Bhansail.
Floor springs	Dorma, Hardwyn, Godrej
Cement	ACC / Ambuja / Ultratech
White Cement	Birla Cement. JK Cement.
Sun Control film	Garware.
Stainless steel sink	Nirali / Diamond.
Carpet	Modi / Trans Asia/ Unitec
Rubber foam	34 density mm foam
WC seat cover	Jaguar, Cera
Toilet paper holder	Dorma, Hardwyn, Godrej

NOTE : All materials shall confirm to IS / BIS respective numbers.

- Commercial ply shall conform to IS 303.
- Marine Ply shall conform to IS 710
- Block Board shall conform to IS 1659.

LIST OF APPROVED MANUFACTURERS / SUPPLIERS OF MATERIALS

MATERIALS	APPROVED MANUFACTURERS /SUPPLIERS
S & F / Light fixtures / Patti	Philips / Wipro / Havells/C.G.
1x 18 w LED	Philips /Wipro / Havells/C.G.
Switch, sockets, conceal box, plate/ Change over switch	Philips/ Orient / Havells
MCCB	L&T / Siemens / Havells
Bus bar / TPN LDB, TPN MCB / DP MCB / SPN UPDB / MCB & DB/ELCB/RCCB	Siemens / L&T / Havells
LT Cable / Telephone cable	Delton / Polycab
Light / circuit wiring / Cable ISI / PVC insulated wire ISI	Havells/ Polycab / Finolex / R.R. Kable / L&T
Floor conduits MMS Grade / PVC conduits & accessories	Precision / Wimco / X-press
Music cum Public address system	Bosch / Sony
Low Fourteension switch fuse unit with HRC fuse	L&T, Siemens
Timer	Lea grand
Gland Flang type	Braco
Lugs / Wooden screw	Dorma, Hardwyn, Godrej
Telephone tag block	Krone Box
Wall / Ceiling / Exhaust fans	CROMPTON GREAVES/ Havells/ Bajaj/ Usha
CAT – 6 Cable / CAT-6 I/O	D-link / DiGlink

PREAMBLE TO BOQ

Abbreviations:

R.M.T	:	Running Meter
Sq. Mt.	:	Square Meter
Sq. Ft.	:	Square Foot
Cu. Mt.	:	Cubic Meter
T.W.	:	Teak Wood
Q.R.O.	:	Quote Rate Only
C / C	:	Centre to Centre
M.T.	:	Metric Ton
C.P.	:	Chrome Plated
NO.	:	Numbers
MM	:	Millimeter

1. All dimensions are in M.K.S. unless otherwise stated.
2. The quoted rate shall be all inclusive and cover the cost of material including wastage, freight, all types of taxes, duties, royalties, erection, construction, testing of materials if required samples brought for approval, tools and tackses, plant and equipments, supervision, overheads, profit and

- any other expenditure incurred for completion of work as per drawings, specifications and to the full satisfaction of BANK / Architect.
3. The rates quoted shall be valid for working at all heights, depths and on all floor levels. No extra payment shall be made for scaffolding, staging, ladders etc for transportation of men and materials at higher or lower levels.
 4. The item rate specifications are indicative. the contractor will have to carry out the work in accordance with the drawings, technical specifications and / or other conditions laid down in tender document and to the full satisfaction of BANK / Architect.
 5. Quantities mentioned against respective items are approximate and can vary to any extent. Payment shall be made on actually executed quantities.
 6. No claims shall be entertained in case of increase / decrease quantities of any item and also to add / delete any item in totality. BANK / Architect reserve the right of operating any item for any work.
 7. Rates for painting shall include cleaning glass panels, floors etc.
 8. After completion of work the site shall be handed over absolutely clean, after ensuring that all floors, walls etc are spotlessly clean.
 9. Rates of all items shall remain constant irrespective of floor level and nmo extra shall be paid for handling and stacking of materials, removing debris etc from the site.
 10. Unless otherwise noted, the method of measurement will be as per I.S. 1200.
 11. BANK / Architect reserve the right of operating all ' Quote Rate only ' items.
 12. Wherever contractor proposes to use 'equivalent 'makes (i.e. other than specified) he shall obtain BANK's prior approval. BANK may ask Architect before giving approval to the same. Any additional cost and time lost due to this will be on Contractor's account and no claims will be entertained.
 13. The rate of partition, paneling shall include necessary additional framework supports that may be required to suit site conditions or stability of the item. Decision of Architect in regards to the need for such additional supports shall be final.
 14. All wooden frame work/ member size mentioned as out of, shall be full size with maximum planning tolerance of 3 mm both ways.
 15. Rates for doors include all brass oxidized heavy duty hardware, locks, floor springs, door springs, door closer, special door handles etc as specified in relative terms.
 16. Size and type of door closer/ floor spring shall be suitable for type of door. The contractor shall give guarantee for performance of door closer / floor spring from manufacturer.
 17. Rates for partitions, paneling shall include making of necessary cut outs, chasing to be made for conduits, switch boards etc.
 18. Rates for painting and polishing shall include cleaning glass panels, fans floor etc.
 19. After completion of work the site shall be handed over absolutely clean, after ensuring that all laminates, floors walls etc are spotlessly clean.
 20. Contractor shall clean the site and mark the lining out on the floor with adhesive tape for approval. The same shall not be paid separately.
 21. In case of loose furniture, the specification for side unit or rear side credenza unit in any item shall be same as the specification of the table in that item.
 22. All key hoes should be fixed with metallic key hole ring.
 23. Key for all locks should be different and no key should match with two different locks.
 24. Rates shall include for following:-

PLASTERING:

- a) Work at all levels, heights and in all situations and profiles.
- b) Double scaffolding, working platforms / Tarpaulin curtains.
- c) Coving, drip moulds, grooves, recesses, ornamental bands etc.
- d) A coat of white wash for neeru plaster soon after curing period is over.
- e) Work in narrow width and small quantities unless special provision is made to the contrary.

- f) Preparation of surface by ranking out joints in brick or by hacking the concrete surface and wetting the surface before plastering wherever required.
- g) Thickness of plaster exclusive of the thickness of key i.e. grooves and open joints in brick work, stone work etc.
- h) Chambers of any width, internal and external rounded angle.
- i) Curling, protection and cleaning of all surfaces.
- j) Keeping all plastered surfaces well wetted for at least 7 days.

PAINTING & POLISHING:

- a) Works at all heights and use of all scaffolding, necessary for execution of work and for inspection.
- b) Preparing surfaces to receive finishing coats.
- c) Putting sand papering and dusting of surface in between coats where applicable.
- d) Work on cornices, narrow bands and widths, grooves etc.
- e) Finishing to approved matt textures, complete as directed.
- f) Spreading and removing, covering to doors, windows, floors, fittings etc to protect them from splashes.
- g) Washing floors, cleaning glass, joinery, electric fittings etc and leaving premises clean and tidy.
- h) Mode of Measurement

S.No.	Particulars	Method of Measurement	Multiplying Factors
1	Panelled doors & Windows	Measured flat not girthed including frame	1.125 for each side
2	Fully glazed		0.5 for each side
3	Partly glazed & panelled		1.0 for each side
4	Flush door		1.0 for each side
5	M.S.Grill & Collapsible door		1.0 for painting all over
6	Rolling Shutter	Measured flat not girthed including frame	1.25 for each side

Mode of Measurements:

- 1 Partition, Paneling : Sq. Ft. Area - one side only
- 2 Painting : Sq. Ft. Finished area only
- 3 Rounding off Measurements : All measurements shall be rounded off to nearest 2 decimal points.

Summary**BARODA U.P. BANK****1)
GHURWARA BRANCH DISTT. RAE BARELI**

sno	Description	Section	Amount of Tender
1.	Furnishing works	in digits	
		in words	
2.	Electrical & Data works	in Digits	
		In words	
3.	Air Conditioners Piping works	in Digits	
		In words	
	TOTAL	in Digits	
		In words	
	GST 18%	In words	
	GRAND TOTAL	in Digits	
		In words	

Note :-

1. All materials to be used strictly follow the list of approved materials.
2. Any deviation in the use of materials at site other than approved materials list will not be permitted and the bank may cancel the contract at any time for any such misconduct & colour as per bran manual.
3. The workman ship and quality of work should be of good quality and to be satisfaction level of the bank's architect and bank

TENDER OF FURNISHING WORKS FOR **BARODA U. P. BANK** SITUATED AT GHURWARA BRANCH DISTT. RAIBARELI.

1. FURNISHING WORKS:-

S.No.	Item	Units	Qty.	Rate	Amount
1	False Ceiling Works (Gypsum)	Sqft	490.00		
	Providing and fixing Gypsum False Ceiling which includes USG Knauf ST50 Perimeter Channels {Material-IS277, 120GSM galvanizing coating both sides inclusive} of size 0.50mm thick (having One Flange of 20mm and another flange of 30mm and a web of 27mm) along with perimeter of ceiling, screw fixed to brick wall / partition with the help of Nylon sleeves and screws at 600mm centers. Then suspending USG Knauf ST50 intermediate channels {Material-IS277, 120GSM galvanizing coating both sides inclusive} of size 45mm (0.9mm thick with two flanges of 15mm each) from the soffit at 1220mm centers with USG Knauf ST50 ceiling angle of width 25mm X 10mm X 0.50mm thick fixed to Soffit with soffit cleat and Anchor fasteners. USG Knauf ST50 Ceiling section of 0.50mm {Material- IS277,120GSM galvanizing coating both sides inclusive} thick having knurled web of 51mm and two flanges of 27mm each with lips of 10.5mm are then fixed to the intermediate channel with the help of connecting clips and in direction perpendicular to the intermediate channel at 457 mm centers. Gypsum board facia of 150 mm high as per the direction of the Architect.				
	USG Knauf 12.5mm thick Standard Plasterboard (conforming to IS 2095:2011, 3rd party certified is then screw fixed to ceiling section with 25mm drywall screws at 230mm centers. Screw fixing is done mechanically with drilling machine with suitable attachment. Finally tapered edges of the Standard Plasterboards are to be jointed and finished so as to have a flush look which includes filling and finishing with Premix Jointing compound, joint paper tape (Confirming to ASTM C475) suitable for Standard board (as per recommended practice of manufacturer) . Rate to be included all kinds of profiles and cut outs required for light fixtures, Speakers, Smoke detector, trap doors and AC grill in the ceiling.				
	No additional payment to be payable for grooves, cut-outs, additional supports for electrical / HVAC & all services, etc. No deduction of electrical fixtures / AC diffuser / grills etc. from payable ceiling area.				
	The ceiling fixing should adhere to the manufacturers instructions				
2	Mineral Fiber ceiling with UNI T 15mm T Grid & 16mm MPRESSIONS™ Clima Plus™ Ceilingtiles (600x600mm)	Sqft	480.00		

	This includes USG Knauf UNI T 15mm grid Wall angle of 19mmx 19mm x 0.40mm shall be screw fixed to brick wall/partition with the help of approved screws at 600mm centres. Then suspending USG Knauf UNI T 15mm Main T grid of 15mm x 38mmx0.30mm of length 3600mm is hung with USG Knaufadjustable level clips 80x30x0.70mm & 4mm diameter GI rod which are connected to USG Boral Soffit Cleat 37mmx27mmx1.6mm and 8mm dia 40mm long Anchor Fasteners @1200mm centres or as approved from RCC Slab. The USG Boral UNI T 15 Cross T of 15mm x 38mmx0.30mm of 1200mm length shall be interlocked between main T Grid at 600mm centres to form 1200 x 600mm modules. 600 x 600mm modules to be formed by click fitting USG Knauf UNI T 15 Cross T of 15mm x 38mm of 600mm length centrally between the 1200mm cross T's Then 16mm thick IMPRESSIONS™ Clima Plus™ ceiling panel having FLB edge of size 595x595 shall be placed into the above grid of size 600x600mm. This ceiling panel confirms to ASTM E84 surface burning characteristics. (Class A, Flame Spread: 25 & Smoke developed: 50). The Ceiling panel provides NRC 0.60, CAC minimum: 33. Light Reflectance: 0.84, recycled content -45% Thermal Resistance: R- 0.3 & can withstand Relative Humidity up to RH 99% (limiting conditions –Max 49 degree C/99%RH). The front & back side of the tile has anti- Microbial ZOE coating.				
3	PARTITION				
	PARTLY GLAZED PARTITION				
I	PARTLY GLAZED CASH CABIN PARTITION UPTO 7'-0" HT.	Sqft	66.00		
	Providing and fixing of Cash Enclosures at height of 7'-0" with Anodized aluminium frame work, heavy sections (2mm thickness) of 2"x1.5", spacing of 2'0"x2'0" on bothsides and covered 6mm thick BWP plywood finished with 1mm thick laminate of approved colour. Partition shall have provision for opening and 19mm BWP plywood tray for challan receiving purpose. Cost include aluminium grill and fixed with teak wood beading and duco paint. Cost also include 3 Nos of Solid core flush Doors with sizes of 2'6"x7'0", fixed in the partition. Door shall have teak wood beading and lipping with duco paint. Door finished with 1mm thick laminate of approved colour for skirting of approved pattern. Door shall have 8mm glass fixed with teak wood beading and duco paint. Rate to include hardware's like brass hinges, godrej three nos of night latch, door closure, door stopper and handles. Cost also include cash transaction opening shall be provided with door arrangements made with BWP plywood frame work finished by laminate, duco paint and locking system. Cost include wastages, transports, loading, unloading charges, labours, materials, tools, lead, lift and etc. Complete as per drawings and instructions of the Architect.				
	Decorative Grill (12mm thick)-hexagonal opening as per instruction of Bank's Engineer/Architect.) All exposed edges of Plywood shall be fixed with 1/8" C.P. Teak Lipping.				
II	PARTLY GLAZED MANAGER CABIN PARTITION UPTO 4'-6' HT.	Sqft	120.00		

	Half Height partition to be made with Anodized Aluminium frame work, heavy sections (2mm thickness) of 2"x1.5" sections, spacing of 2'0"x2'0" on both sides and covered with 9mm thick BWP plywood finished with 1mm thick laminate of approved colours for skirting & borders and white colour laminates for base on both sides with all necessary fixing accessories, arrangements and etc. Partition shall have 12mm thick etched/3M film glass and fixed with teak wood beading with melamine polish. Clear glass shall be finished with frosted film sticking over the glass of approved pattern and design. Rate to include providing cutouts and provisions to run electrical conduits, switches, etc. Cost include wastages, transports, loading, unloading charges, labours, materials, tools, lead, lift and etc. Complete as per drawings and instructions of the Architect.				
4	BLOCKED PARTITION				
I	BLOCKED PARTITION UPTO 4'-6" HEIGHT FOR UPS ROOM:-	Sqft	37.00		
	Low height Solid partition (height 4'-6") with Anodized Aluminium frame work, heavy sections (2mm thickness) of 2"x1.5" sections, spacing of 2'0"x2'0" on both sides and covered with 9 mm thick plywood finished with 1mm thick laminate of approved colour for skirting & borders and laminates for base on both sides with all necessary fixing accessories, arrangements and etc. Partition shall have necessary opening of approved size as per standards for fixing machine' s and additional frame to be fixed for strengthening the partition. Rate to include providing cutouts and provisions to run electrical conduits, switches, etc. Cost include wastages, transports, loading, unloading charges, labours, materials, tools, lead, lift and etc. Complete as per drawings and instructions of the Architect. This would include provision of teak wood chaukhat for provision.				
	The job shall also include for provision of laying conduits, switch boxes etc. The erection of partition shall include for expansion bolts cleats, clamps bolts, nuts, screws, rivets and other accessories, all complete up to the satisfaction of the Architect.				
II	BLOCKED PARTITION UPTO 11'-0" HEIGHT FOR AC & NON AC	Sqft	355.00		
	The partition and doors shall have hinges floor springs /sliding arrangement/ hydraulic door closer, mortise locks with handle set (Godrej, Dorma make all), etc. The rate shall include cost of all materials, labour, T&P, wastages, etc. required for proper completion of work, all complete to the satisfaction of the Architect.				
	Full height Solid partition (Ceiling height) with Anodized Aluminium frame work, heavy sections (2mm thickness) of 2"x1.5" sections, spacing of 2'0"x2'0" on both sides and covered with 9 mm thick plywood finished with 1mm thick laminate of approved colour for skirting & borders and laminates for base on both sides with all necessary fixing accessories, arrangements and etc. Partition shall have necessary opening of approved size as per standards for fixing machine's and additional frame to be fixed for strengthening the partition. Rate to include providing cutouts and provisions to run electrical conduits, switches, etc. Cost include wastages, transports, loading, unloading charges, labours,				

	materials, tools, lead, lift and etc. Complete as per drawings and instructions of the Architect. This would include provision				
5	DOORS				
	Providing and fixing solid core 38mm solid core flush door finished with lippings in all side with necessary door hinges, cylindrical locks (golden, Godrej), door closer, door stoppers, etc. with a frame work of T.W./ Beech wood size 75mm x 62.5mm with necessary hold fast fixed to the wall/partition. 1 mm laminate to be fixed on both sides duly finished, edges to be finished with wooden lippings. A wooden molding size 1.5" x 2/8" to be provided all along the periferi of the frame work in the both sides. All the wooden area to be duly polished as per specification of the Architect. In case of Partly glazed door 8mm thick etched or plain glass with granular blasting/sand blasting as per design of the Architect to be fixed with necessary moldings.				
1	Flap Door	Sqft	15.00		
6	FULLY GLAZED ENT. DOOR WITH ALUMINIUM PARTITION	Sqft	110.00		
	P/F aluminium powder coating Fixed glazing as per bank colour code. The section of aluminium to be 2 1/2" x 1 1/2" x 14 gauge. All sections to be of hindalco/ indal. The Glazing to be 8 mm thick glass with etching and fixed with necessary beadings duly completed in all respects as per the satisfaction of the Architect.				
7	CASH COUNTER:-	Rft	5.23		
	Providing and fixing into position Cash counters as per detailed drawing made of Phenol bonded 19mm thick BWP commercial board finished with 1.0mm thick BWP laminate on top, front and sides as per detailed drawing. The front member of the cash counter to continue to 3'-8" height. At 3'-8" m height a projection of 15cm extended towards the customers side while a projection of 25.5 cm will be extended towards the staff. The outward projection to be made of 19 mm thick phenol bonded commercial board finished with 1mm thick laminate top. The counter to have one drawer unit of 3 drawers & space for CPU. 2 drawers to have division for cash as banks specifications. The exposed edges to have TW beading as in the design.				
	The item included all hardware such as channels of glydo/ hettich/ flyrail, selfclosing hinges/ locks/ handles/ laminated keyboard tray, Other hardware etc. The exposed surfaces to be finished with 1mm thick laminate of approved shade. Provision of footrest to be made as specified. All exposed wooden surfaces to be finished with clear melamine polish as approved by the Architect. All unexposed surfaces to have synthetic enamel paint with primer, all complete as per detailed drawings and direction of the Architect. The counter to have provision for cable manager and keeping mouse.				
8	OFFICER COUNTER	Rft	33.00		

	Providing & Fixing clerical counter made out of 19.0mm thick ply (as per list of materials and Drawing) frame work for top, verticals, shelves, apron, sides, drawer unit, shutters, side units, customer top, foot rest, 12.0mm thick ply(as per list of materials for drawer sides, sliding shutters, front apron & 6mm thick ply for side unit back, drawer bottom, drawer unit back along with necessary 2" X 2" or 2" X 1.5" of laminate matching imported wood molding & teak wood supports for fixing of top. The clerical counter shall have 2'-6" in depth & counter shall have two tops i.e. one at 2'-6" for writing and second at 3'-0" for customer in height finish in approved make/color black granite of top on the counter. complete. The clerical counter shall have 1 No. of key board tray, 2 Nos. of equal drawers or as per the Bank requirements & one open able shutter. All exposed surfaces i.e. apron, counter side etc. finish with approved make/color 1.00mm thick laminate & moulding finish with 3 coats of melamine polish and internal surfaces shall have zinc oxide polish along with necessary approved Stainless Steel				
	Hinges, Ball Catches, Stainless Steel Locks, approved design Stainless Steel Handles, Stainless Steel Powder Coated Grommet (wire manager), Wood Foot Rest (Movable) Earl-Bihari make Twin Telescopic Channel, CPU Hanger/Trolley INNOFIT make etc. complete as per detail drawing and Instructions of the Bank's Engineer/ Architect				
9	Cash Cabin-Aluminium Grill Top with teak Decorative Grill Partition).	SQFT	38.00		
	Providing and fixing of Aluminum grill work in cash counter top with all nessecary fixing support of 'L', 'H' and 'C' aluminium sections and etc. Cost include 'L', 'H' and 'C' aluminium sections, hardwares, tools, wastages, lead, lift, labour charges, oading, unloading charges, cutting, transport and etc. Complete as per instructions of the Architect.				
10	12 MM Glass on Front Counter & Cash Counter	Sqft	75.00		
	Supplying and fixing 12mm thick toughened glass in bank front counter's and cash counter front side of approved length and width and fixed with "D" bracket and all necessary fixing accessories, arrangements and etc. Each glass shall have four nos of "D" bracket. Cost include edge machine polish in glass. Cost include making holes for transaction purpose for each glass, wastages, transports, loading, unloading charges, labours, materials, tools lead, lift and etc. Complete as per drawings and instructions of the Architect. Measurements shall be made actual laid quantity in SFT.				
11	Manager Table with side table with 12 mm thick bevelled glass on top.	No.	1.00		
	Size-5'-6" X 2'-6" X 2'-6"				
	Providing Table in position, Top shall be made of 19mm thick BWP comm. Board finished with 1.00mm thick laminate 1 3/4" x 1" teak wood beading as per design on all sides. The sides shall be made of 19mm thick BWP comm. board finished with 1.00mm th laminate as per design. with teak wood lipping on all exposed ends of sides The front apron shall be made of 19mm thick BWP comm. board finished with 1.00mm thick laminate as per design The drawers to be made out of 19mm thick comm. BWP board duly laminated in the front, sides to be made out of 12mm BWP comm. plyw and bottom to be made out of 6mm BWP comm. ply and it should play in drawer sliding channels. The inside of the drawer and the table to be duly paint. laminated. A legrest to be provided duly paint made out of 3"x2" thick wooden section. A shutter to be made by 19mm BWP comm. board cladded with 1.0 mm laminate. The necessary locks handles to be provided in each				

	drawers and shutters. On top of the Branch managers table 12mm thick glass to be placed duly edge polished. The table should have key board tray and tea tray duly finished with 1mm laminate. The necessary wire managers to be provided on the tables and provision for lights to be kept if required in the front of the table. (One coat of Ant termite treatment oil)				
	Side Table-3'-0" X 2'-6" X 1'-6"				
	Ply Wood-19.0mm thick BWR				
	Supports-2" X 2" & 2" X 1.5" CP Teak Wood and beading Patti				
	Drawer-1'-6" wide two drawers and one shutter below the drawers at left side of the table and two drawers at side table and below two shutters				
	Laminate-1.0mm thick approved colour				
	Key Board Tray-Metal INNOFIT make				
	CPU Metal Stand, Twin Telescopic Drawer Fittings, Brass Powder Coated Wire Manager				
	Handle-Brush finish stainless steel, Brass Ball Catches 12.0 thick plain glass with edge polish at top of the table (Other Exposed Edge of Ply with half round beading with approved colour polish)				
12	STORAGE				
	Providing and fixing storage 400mm deep made out of 19mm bwp block board finished with 1.0mm laminate in all exposed areas and .8mm white laminate on every inner surface/area instead of painting. The drawers to be made out of 19mm BWP block board in the front cladded with 1.0mm laminate (color, vertical grain). sides to be made out of 6mm plywood and .8mm white laminate on every inner surface/area instead of painting and it should play on drawer sliding channels. The shutters to be made out of 19mm block board and should play on drawer slidign castors on powder coated channels. The necessary locks, handles, etc. of approved make to be provided. All the exposed edges of the boards / plywood's to be covered with wooden lapping / moldings duly polished all complete.				
	Low Height storage (2'-6" ht)	Sqft	25.00		
13	CHEQUE DEPOSIT BOX (450x300x700)	No.	1.00		
	Providing and making cheque drop box 1.5'x1'x(9" deep)as per design & pattern with 19 mm ply finished exterior surface with 6 mm thick extra clear white paited glass having 4"x1" slots with 3 mm thick S.S. plat pasted with metal adhesive. Rate shall include all necessary hardwares and locking and side opening arrangements.				
14	SUGGESTION BOX (450x300x700)	No.	1.00		
	Providing and making Suggestion box 1.5'x1'x(9" deep)as per design & pattern with 19 mm ply finished exterior surface with 6 mm thick extra clear white paited glass having 4"x1" slots with 3 mm thick S.S. plat pasted with metal adhesive. Rate shall includes all necessary hardwares and locking and side opening arrangements.				
15	Writing Table (The work shall be executed as per design and Elevation.)	No.	1.00		

	Providing and fixing in position a writing counter with open storage made of 12mm and 19mm thick ply/commercial board finished with 1.0mm laminate and teak wood moulding/ lipping with a 6mm glass top with polished edges as per drawing and design. The glass to be of size to fit internally and the 19mm border and 6mm lipping to be flushed with the glass. The storage unit shall consist of vertical space dividers of 12 mm board with 1.0 mm laminate fill the glass top for the provision of holding withdrawal/ deposit slips stationery etc. The counters to be held in position around the columns by dash fastners at a height of 3.5/ 4 ft. Notice board with cellotex base & cloth bound in corporate coloured binded with teak wood lipping of 35 by 12 mm. size 1500X1200. All wooden surfaces to be finished in clear melamine polish and all unexposed sides to be finished in enamel paint of approved colour to be approved by the designer all complete as per detailed drawing, specification and direction of the Engineer in Charge.				
16	NOTICE BOARD (1200x900)	No.	1.00		
	Providing & fixing Notice Board the tag board of approved make & design, of size 4' X 3', with anodized aluminum boarder/frame type. The board should be 3/4" th. Strow board with velvet type fabric lining of appr. Colour.				
17	Meter Boxing (Only front face to be measured for payment purpose)	Sq.ft.	47.00		
	Manufacturing, supplying and fixing box type metre storage with overall depth of 1'6" and height as per the size of the mitre. comprising of the following.				
	19mm BWR block board hinged double shutter, height as size of the panel with around beadings 3/4" x 1/2", powder coated handles, piano hinges, magnetic ball catches, lock, locking arrangement, tower bolts etc., all as per directions.				
	All visible surfaces to be fixed with 1.0mm thick lamination sheet with matching grains & grooves as per instructions				
	All internal & rear surfaces to be painted with two coats of enamel paint over a coat of primer/putty as directed to get a smooth finish and 4nos-6" wide Powder Coated 2 nos Aluminium Aircon Louvers.				
18	Wall & Column Panelling -upto false ceiling height only considered and above necessary ceiling supports shall be provided) with Anodized Aluminium frame work, heavy sections (2mm thickness) of 2"x1.5", spacing of 2'0"x2'0" on bothsides and covered with 9mm thick BWP plywood finished with 1mm thick laminate colours for skirting & borders,. Rate to include providing cutouts and provisions to run electrical conduits, switches, etc. Cost include necessary hardwares like clamps, screws and etc. Cost include provisions for electrical db closing 19 mm BWP plywood door arrangements, wastages, transports, loading, unloading charges, labours, materials, tools, lead, lift and etc. Complete as per drawings and instructions of the Architect.				
I	Banking Hall 8'-6" height	Sq.ft.	180.00		
II	Manager cabin 4'-6" Height	Sq.ft.	95.00		
III	Cash Cabin Paneling	Sq.ft.	54.00		

19	A.C.P. on Rolling Shutter Box with Trap Door (Branch)	Sq.ft.	91.00		
	ACP Panneling & Rolling Shutter Box.				
	Frame Work-2" X 2" X 1.5 mm thick Aluminium Tubular section (Horizontal/Vertical) Jindal Make				
	Aluminium Composite Panel-3.0mm thick of approved colour with bonding material.				
	Total of Furnishing Work				

2. ELECTRICAL WORKS:-

S.NO.	PARTICULARS	Qty	Unit	Rate	Amount
1	Points Wiring:				
	Wiring for light points, fan points, bell points, sockets etc. with 3*1.5 Sq.mm FRLSH PVC insulated, 1100 V grade grade copper conductor wires in concealed/surface using PVC (medium) 20mm dia conduits, accessories such as bends, tees, saddles, draw boxes, mounting boxes, inner plates, cover plates, ceiling rose etc. (including chase cutting where ever required) and chromium plated brass screws/rowel plugs etc.. The conduits to be laid in ceiling with proper clamps/ wall /floor and filling the chase with cement mortar and finish the same in original form/wooden partition/above false ceiling with proper clamps (wherever required as per standard specification.				
	Note:				
	i) Circuit wiring to be included in the point wiring rates.				
	ii) Each circuit shall have independent earth wire.				
	iii) Each point shall be earthed.				
a)	One light point controlled by one 6A modular one way switch - marked P1	10	Each		
b)	A set of two light points controlled by one 6A modular one way switch.- marked P2	18	Each		
c)	One wall fan point with 6A 3 pin socket controlled by one 6A modular one way switch. The switch should be at switch board level.	9	Each		
d)	One Ceiling fan point with 6A 3 pin socket controlled by one 6A modular one way switch c/w electronic regulator. The switch should be at switch board level.	3	Each		
e)	One Exhaust fan point with 6A 3 pin socket controlled by one 6A modular one way switch. The switch should be at switch board level.	3	Each		
f)	One call bell point with ceiling rose/6A 3Pin socket controlled by one 6A modular bell push switch with call bell.				
g)	One 6A 5Pin socket controlled by 6A modular one way switch				
	i) Dependent	8	Each		
	ii) Independent	0	Each		
	One 6A 5Pin socket controlled by 6A modular one way switch				

	[For item no. "a" to "h" all mounting boxes, inner plates, modules, cover Plates etc. Shall be crabtree mega series, platinum range material (or equivalent of ABB/MK only)				
2	Power Points:				
	Twin Power Point: Same as serial no. 1, but wiring for 16A 6-Pin socket by using 2*4 sq mm FRLSH PVC insulated 1100V grade copper conductor wire with independent 2.5 sqmm earth wire from Db. The 2nd socket to be interlooped to first 1st. Socket with 3*2.5 sqmm FRLSH Cu stranded wires including providing and fixing of 2nos. 16A 6-Pin socket with 16A switch for twin Power points.	4	Each		
	Note: Circuit wiring to be included in the power point wiring rates.				
	Power point with 2.5 sqmm copper crabtree (or equivalent of abb/m.k.) make modular/double module with all accessories only]				
	4 Ckts - 2 for 4 officers on counters adjacent to cash cabin + 1 for BM + 1 for 2 officers o/s BM				
3	Single power Points: Same as above 2a, but wiring for 16A 6-Pin socket by using 3*2.5 sqmm FRLSH Cu Stranded wire including providing and fixing of 16A 6-Pin socket with 16A switch. 1 Cash Cabin, 2 router, 1 D/w	4	Each		
	Note: Circuit wiring to be included in the power point wiring rates.				
	Power point with 2.5 sqmm copper crabtree (or equivalent of abb/m.k.) make modular/double module with all accessories only]				
4	AC Points:				
	AC Point: Providing AC points with circuit wiring with 3*4sq.mm FRLSH Cu stranded wires to be laid in 20mm PVC medium concealed in wall/ floor/ panelling/ partitions as per requirement. The work shall include S/F of MCB protected power unit for AC c/w 25A 2P MCB including proper connections. The job shall be complete & to the entire satisfaction of the Bank.	4	Nos.		
5	DISTRIBUTION BOARDS:				
	Supplying, installation, testing and commissioning of DOUBLE DOOR type distribution boards ORIGINAL FACTORY FABRICATED ONLY) of following specifications:				
A)	4-WAY TPN DB (POWER & AC DB Combined)	1	Nos.		
	INCOMER :63A 4P				
	OUTGOING: 32A SP MCB-4Nos.				
	20A SP MCB-4 Nos. & 16A SP 4nos.				
	(FOR SPLIT/WINDOW A.C. & Power Points)				
	4 for AC, 4 for twin Power points & 4 for single power points				
B)	4-WAY TPN DB (LIGHT & FAN DB)	1	Nos.		
	INCOMER :63A 4P				
	OUTGOING: 10A SP MCB - 12Nos.				
C)	UPS DISTRIBUTION				

(i)	Supply & Fixing of 2nos. 32A DP MCB in 4way SPN Db for regulating UPS supply. 1 set for Input c/w 2metre 3*4sq.mm Cu stranded wires complete in all respects.	1	Set		
(ii)	UPS output Db - Location UPS Room - Supply & Fixing of 12way SPN Db double door c/w 32A DP MCB as incomer & 10nos. 10A SP MCB c/w 3m 3*4sq.mm Cu stranded wires complete in all respects. (Total 1 computer nodes. Any two adjacent nodes may be interlooped)	1	No.		
6	MAIN PANEL AND CABLES				
A	Fuse Set: S/F of 3no.100A 415V Kit kats rewirable Porcelain fuse carrier & base c/w 4hole heavy duty terminals with shroud & cover including making of connection from electronic meter c/w wooden board etc.	1	Set		
B	Supply, installation, testing and commissioning of of cubical type MAIN PANEL made of cubical type MAIN PANEL made from 16 SWG CRCA sheet steel, "I" type base M.S. Channel for grouting on floor complete with MCCBs, MCBs, Meters, C.T. etc. complete in all respect, insulated bus-bar with heat shrinkable PVC sleeve in suitable bus-bar chamber, wiring, name plates, danger plate, earth-bus etc.& comprising of compartments with hinged doors and rubber gasket, bus-bar chamber with bolted door and rubber gasket etc. The panel being of dust & vermin proof construction and to be painted with primer and smoke gray paint (minimum two coats) to look attractive. The panel should be comprising with the followings: Degree of Protection IP-54)	1	Nos.		
	INCOMER:				
	100A, 25KA, 4P MCCB -1 NO.				
	100A 4P, ON LOAD change overswitch-1no.				
	160A capacity aluminum bus-bar with heat shrinkable proper insulation with color coated.				
	Digital ammeter and voltmeter with selector switches.				
	R-Y-B phase indicators with 2A backup HRC fuse.				
	OUTGOING:				
	63A 4P MCB, 10KA -2Nos. 1 for AC & PP Db & 1 spare				
	63A 4P ON LOAD change over switch (SYSTEM ROOM/ATM)1No.				
	40A 4P MCB, 25KA --1 No. - for L&F Db				
C	CABLES				
	S/ laying of XLPE insulated armoured Copper Conductor cables including cost of lugs, cable glands etc. The cable should be laid on surface with proper clamps @750mm or laid & concealed in wall/ floor/ PVC Conduit/ false ceiling complete in all respect. The work also includes cutting chases for conduits in the wall/ floor (Without damaging the building) along with clamping the cable. All connection shall be done thru proper size of lugs				
	4c 16sq.mm from Pole to fuse Kit Kats	20	Mtr.		
	4c x 10sq.mm cable from Panel to AC & Power TPN Db	22	Mtr.		
	4c x 6 sq.mm from panel to L&F Db	20	Mtr.		
	4c x4sq.mm from Panel to Fuse Kit Kats in UPS room	25	Mtr.		
D	Glow Sign Board wiring & Timer				

(i)	Glow sign Board - Circuit wiring with 3*1.5sq.mm FRLSH stranded Cu. conductor to be laid in 20mm OD medium PVC conduit duly laid & concealed in wall/ floor/ panelling/ partitions or above false ceiling as per requirement.	12	m		
(ii)	Timer - Supply of 40 A SP 230 V analog time switch panel(TIMER), in manufacturer sheet steel panel, fully prewired with all components like time switch, MCB, contactor, selector switch, indicating lamp.(1 for sign board)	1	Each		
	Timers- L&T/ Legrand/ Schneider/ Siemens/ GE				
7	UPS POINTS				
	Supply, laying & Installation of point wiring for UPS on workstations / table for computers using 3*1.5 Sq.mm Cu stranded FRLSH PVC wire pulled through floor raceways/conduit and taken upto table top using PVC rigid or flexible conduits run within wooden/metal partitions. Each point consisting of 3 nos of 6A , 2/3 pin sockets & 1 No.16A Switch wired together forming one point. The job shall be complete fine finish including making necessary connections & start of equipments as per requirement				
a	UPS point directly connected to UPS Db	11	Nos.		
b	Supply & fixing of porcelain fuse 63 Amp with neutral	1	Nos.		
c	Cut out 63 A	3	Nos.		
8	EARTHING				
a	Panel: S/burying of Dual pipe technology (Pipe in Pipe) earthing electrode having GI 80mm O/D pipe with 25 micron coating, 3metres long. The job also includes S/F of GI strip clamp with two holes (with SS/GI bolts & nuts) on the electrode & taking one lead of 4sq.mm Cu Stranded wire upto Main panel complete in all respects with guaranteed E/N voltage of less than 2 volts and resistance less than 1 ohms. The 4sq.mm Cu stranded wire shall be terminated on the earth bolt in panel. The distance between two earthing pits to be 10ft or more.	1	No.		
b	UPS: S/burying of Dual pipe technology (Pipe in Pipe) earthing electrode having GI 80mm O/D pipe with 25 micron coating, 3metres long. The job also includes S/F of GI strip clamp with two holes (with SS/GI bolts & nuts) on the electrode & taking one lead of 4sq.mm Cu Stranded wire upto 6way earthlink in UPS room complete in all respects with guaranteed E/N voltage of less than 2 volts and resistance less than 1 ohms. The 4sq.mm Cu stranded wire shall be terminated on a separate 6way earthlink. The connections for UPS earthing shall be taken from this earthlink. The distance between two earthing pits to be 10ft or more.	1	No.		
c	Supply & Fixing of 4sq.mm FRLSH Cu. Stranded wire on surface or in recess for loop earthing as required earthing to Db's or main panel as required.	30	Mts.		
	PVC Insulated FRLSH Copper wire (ISI Marked)- Skyline/ Finolex/ Havells/ Polycab				
9	<u>DG Set Supply</u>				
	S/laying of 4c 16sq.mm XLPE insulated Armoured Cu. conductor cable c/w 1*6sq.mm FRLSH Cu Stranded wire (earthwire) from proposed DG set to Changeover switch including its connections at both ends with				

	lugs duly clamped with saddles @600mm with MS clamps (Made from 25x3mm MS flat) duly screwed with 32x8mm screws complete in all respect or if required buried in ground as per site conditions	14	m		
10	Supplying, installation, testing and commissioning of following light fixtures, fans etc.				
	a) PHILIPS/ WIPRO/ C.G./ HAVELLS Make light fixtures				
(i)	S/F of Energy efficient recessed mounted LED luminaire - 30/32w LED recessed mounted 2'X2' luminaire suitable for grid ceiling with indirect lighting delivering soft and uniform light - Make as approved by Bank/ architect	16	Nos.		
(ii)	S/F of down light LED Luminaries with reflector in square shape (Havell's /Crompton/Philips) complete With cutting of false ceiling 12 watt LED - Make as approved by Bank/ architect	12	Nos.		
(iii)	S/F of Surface & wall mounted LED batten - Ultra-slim poly carbonate decorative LED batten with inbuilt heat sink, anti-glare polycarbonate diffuser & energy efficient electronic driver 20W 1800 lumens - Make as approved by Bank/ architect	14	Nos.		
(iv)	S/F of Angle holder complete in all respect with 8w LED lamp (for Toilet)	4	Nos.		
	b) CROMPTON GREAVES/ Havells/ Bajaj/ Usha make fans				
(i)	S/F of metal body wall mounted fan 450mm sweep - Sturdy & heavy duty metallic blades, Nickel Chrome plated guard - Make as approved by Bank/ architect	9	Nos.		
(ii)	S/F of energy saving/ efficient ceiling fan 1200mm sweep double ball bearing type - Make as approved by Bank/ architect	3	Nos.		
	c) CROMPTON/GE-ALOSTHOM/ Havells/ Bajaj/ Usha make Exhaust fans				
(i)	18" Exhaust fans Commercial/ industrial with clamps, bolt/dash fastener by grouting on wall for Banking Hall.	0	Nos.		
(ii)	12" Exhaust fans with clamps, bolt/dash fastener by grouting on wall for Toilets.	3	Nos.		
11	<u>Telephone</u>				
1	S/F on wall/ furniture/ partition recessed type modular telephone socket outlet (RJ-11) with mounting box & front plate complete with chase cutting, mending good etc. as required complete including Supply & laying of 2 pair 0.5mm dia. PVC insulated unarmoured telephone cables through rigid PVC conduit of suitable diameter from telephone junction box to telephone socket outlet including interconnection as required complete in all respects.	4	Each		
	Telephone Wire -Delton/ Skyline/ Finolex/ Rallison/ Batra Henley				

2	Supply & fixing of MDS box	1	Each		
	MDS box - Krone/ Pouyet/ TVS				
3	Supply & fixing of 10 pair box	1	Each		
	Telephone Tag Blocks- Krone/ Pouyet/ TVS				
12	DATA NETWORKING WORK				
a	Supplying, Laying, testing & commissioning of enhanced CAT 6 LAN cable(AT&T/D-Link/Siemens shielded make) in PVC conduit & termination	180	Mtr.		
b	Supply & installation of Patch Cord 1 Meter	11	Nos.		
c	Information Outlet box	11	Nos.		
d	RJ 45 Connector	22	Nos.		
e	Supply & installation of Patch Cord 2 Meter	11	Nos.		
f	Shifting of Tray, Cable Manager, Patch Panel, Switch & U Rack from old branch to new branch	1	Job		
	TOTAL OF ELECTRICAL & DATA WORK				

3. AIR-CONDITIONING PIPING WORKS:-

S.N.	DESCRIPTION	UNIT	QTY	RATE	AMOUNT
1	Drain Water Piping Constructed out of PVC Hard Pipes, fitting, accessories, bends, elbows, tees, hanger, support, anchors, ISI approved Finolex/Prince Make (32mm)	RM	70.00		
2	Rate for Extra Piping (Rate above 12 Feet pipe which will be free with each unit) Ref. Piping (Only single distance will be measured between Indoor & Outdoor Units)				
a	Copper Piping Refrigerant along with insulator Piping for Hi Wall 1.5 ton, 1/2 and 1/4 Soft Copper Refrigerant piping with complete fitting, elbows bends supporting arrangements Nissan, Merchant, MET tube, T otaline tube, pressure tested tube and S.I.T.C. of 12.5 Sq.mm. & 6.25 Sq.mm. dia. Copper refrigerant pipe with foam Insulation between Indoor & Out door units with breaking of wall for making hole wherever required For Split Air- Conditioners. And S.I.T.C. of 19 mmdia & 16 mm dia Copper Refrigerant Pipes with Foam insulation between Indoor & Out door units. with breaking of wall wherever required for 2-3 Tr Cassette/ Inverter Air conditioners.	Rm	75.00		
b	S.I.T.C. of 4 core Copper conductor flexible cable between Indoor & Outdoor Unit through holes made as above	Rm	80.00		
Total of AC Works					

Certified by: -

Architect name

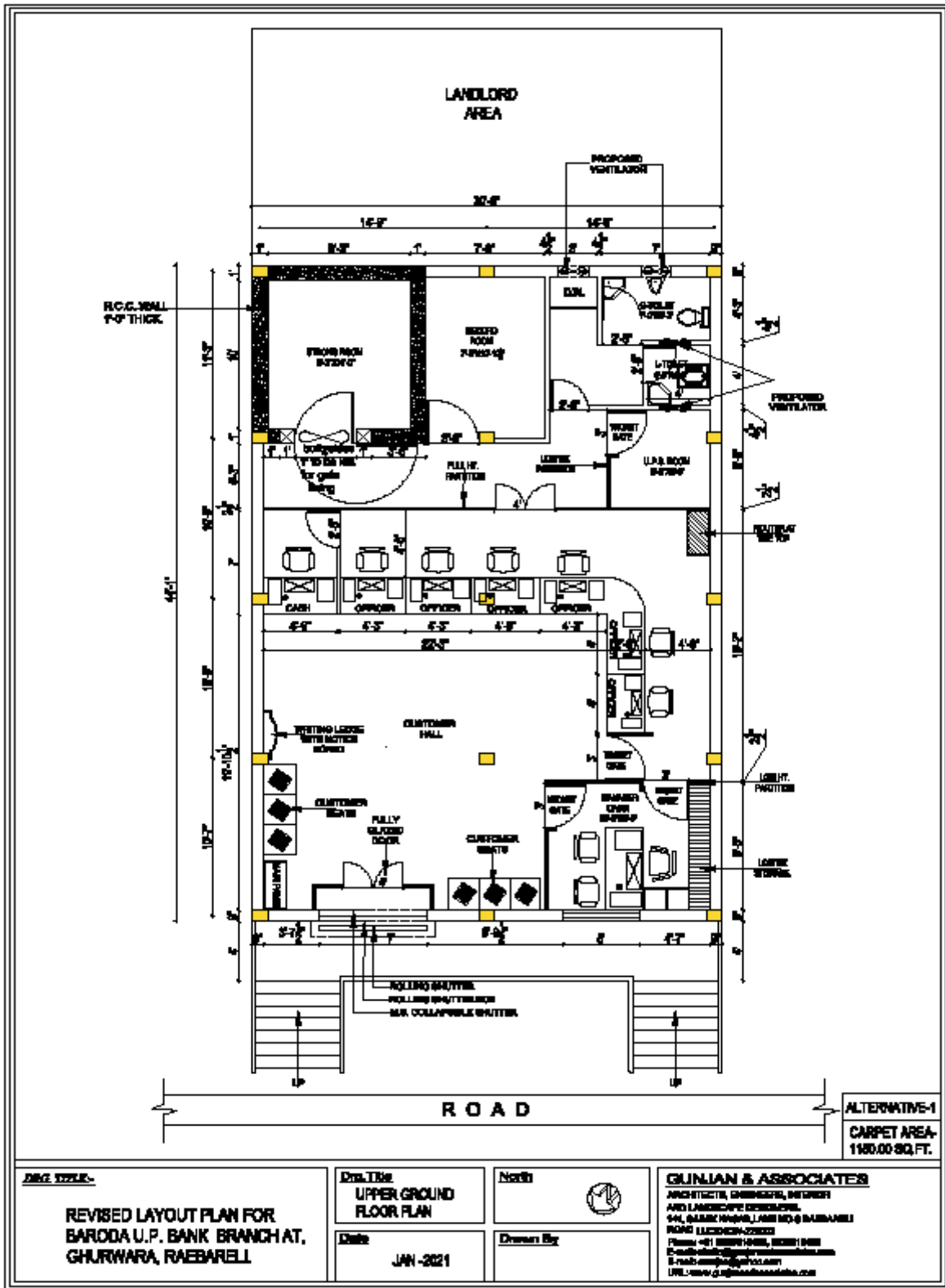

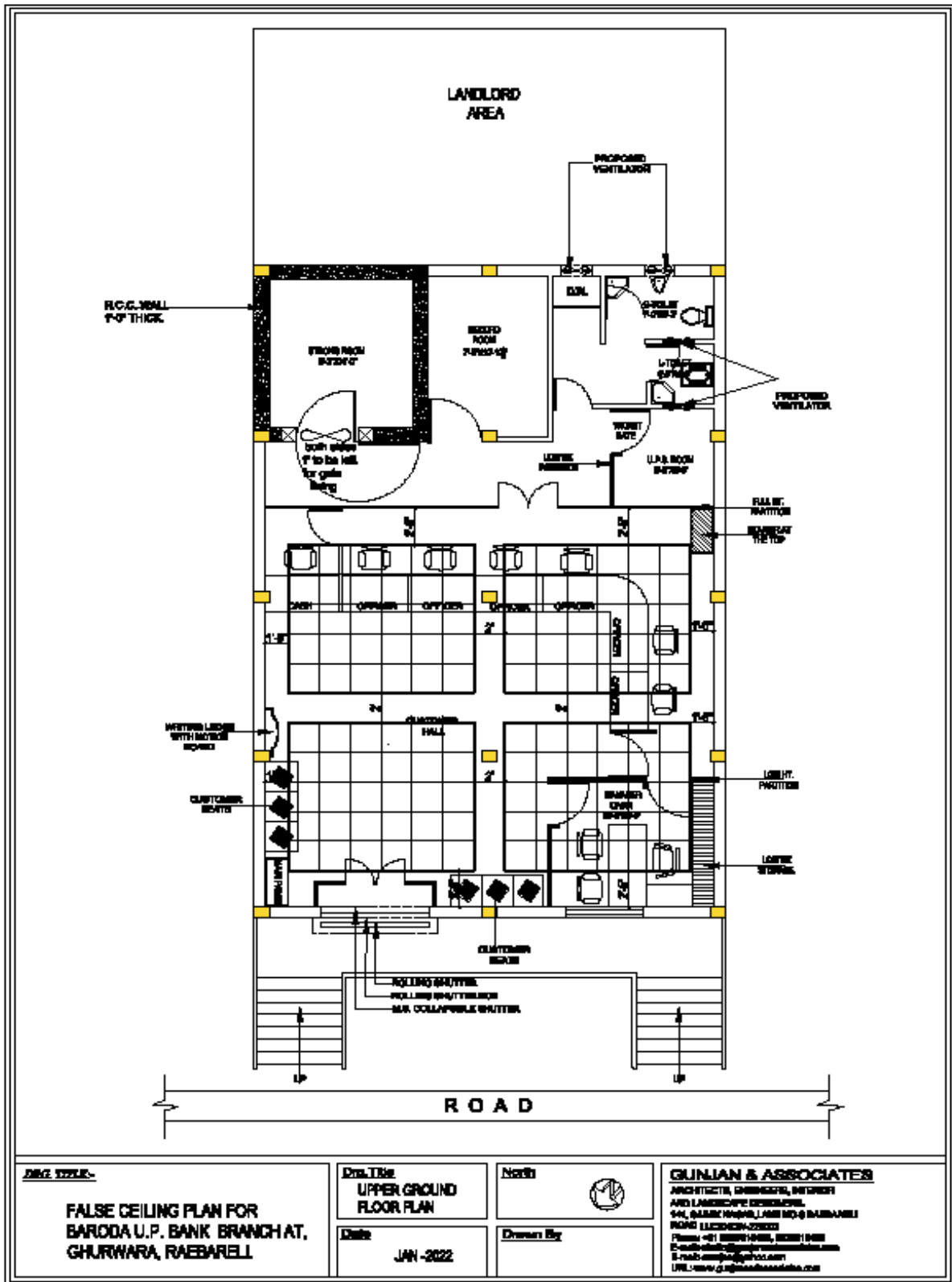

DWG TITLE:-

**FALSE CEILING PLAN FOR
BARODA U.P. BANK BRANCH AT,
GHURWARA, RAEBARELL**

Dwg Title
**UPPER GROUND
FLOOR PLAN**

Date
JAN -2022

North



Drawn By

GINJIAN & ASSOCIATES

ARCHITECTS, ENGINEERS, INTERIOR
AND LANDSCAPE DESIGNERS.
54/1, GURJIT NAGAR, JANGI IND-9 BARBANKI
PIN-241001 (U.P.) INDIA
Phone: +91 8866140818, 8866140819
E-mail: gajin@ginjiansa.com
E-rab@ginjiansa.com
URL: www.ginjiansa.com

