



बड़दा यू.पी.बंक
Baroda U.P. Bank

TENDER NOTICE

Baroda UP Bank, Regional Office, Kaushambi Collectrate Compound Manjhanpur intends to invites sealed tender for furnishing and electrical, Data cabling , UPS work for Maheshganj Branch Dist- Prayagraj from the empanelled Furnishers of Baroda UP Bank, Head Office, Buddh Vihar Taramandal Gorakhpur-273016 (U.P).

Branch- MAHESHGANJ

1. Tender issuing date. : 07.03.2024
2. Last date for submission of tender : 27.03.2024 at 03:00 PM
3. Date of opening of tender : 27.03.2024 at 04:00 PM
4. Tender to be address to: The Regional Manager
Baroda UP Bank, Regional Office-Kaushambi
Collectrate Compound Manjhanpur
Kaushambi-212207

The completion period for work will be 30 days. The work shall be executed as per specifications and supervision of our consulting Architects M/S Bharat and Associates, Shop No-1 First Floor, Jeevan Plaza, Vikram Khand-5, Gomti Nagar, Lucknow-226010.

Tender documents are attached with this notice.

Entire Tender documents are to be submitted in tender form attached herewith, in sealed packet with clearly mentioned "INTERIOR FURNISHING, ELECTRICAL WORK, UPS, DATA CABELLING FOR MAHESHGANJ BRANCH"

EMD can be paid through DD-drawn on Nationalized/Scheduled Bank for Rs.5000/- drawn in favour of The Baroda UP Bank , Regional Office Kaushambi.

All tender documents should reach our office on or before 27.03.2024 before 1500 Hrs. If demand draft details of depositing EMD are not submitted the tender of such bidder would be summarily rejected.

Date- 06.03.2024

Chief Manager

क्षेत्रीय कार्यालय, कलेक्ट्रेट कम्पाउंड, मंझनपुर, कौशांबी-212207, दूरभाष: 05331-232990

Regional Office, Collectorate Compound, Manjhanpur, Kaushambi-212207, Telephone: 05331-232990

e-mail: rokaus@barodauprrb.co.in

BARODA U.P. BANK

TENDER DOCUMENT

FOR

(INTERIOR FURNISHING, ELECTRICAL WORK, UPS, DATA
CABELING FOR MAHESHGANJ BRANCH)

BARODA U.P. BANK
Regional office Kaushambi
Collectorate Compound, Manjhanpur
Kaushambi: 212207 (Uttar Pradesh)

Date of Issue : - 07.03.2024
Date of Submission : - 27.03.2024
up to 15:00 HRS

ARCHITECTS

M/S Bharat and Associates
Shop No-1 First Floor, Jeevan Plaza, Viram Khand -5 Gomati Nagar
Lucknow-226010

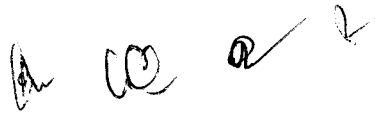

ROKAUS/P&E: TENDER/2023-24/11

Signature & Seal of the Contractor

क्षेत्रीय कार्यालय, कलेक्ट्रेट कम्पाउंड, मंझनपुर, कौशांबी-212207, दूरभाष: 05331-232990

Regional Office, Collectorate Compound, Manjhanpur, Kaushambi-212207, Telephone: 05331-232990

e-mail: rokaus@barodauprrb.co.in

IMPORTANT SCHEDULES

DATE OF ISSUE OF TENDER	:	07.03.2024
LAST DATE OF SUBMISSION OF TENDER	:	27.03.2024 till 15:00 HRS
DATE OF OPENING OF TENDER:	:	27.03.2024 at 16:00 HRS at RO,Kaushambi.
EARNEST MONEY	:	5000/- (FIVE THOUSAND RUPEES ONLY)
SECURITY DEPOSIT	:	3 % of accepted value of tender
ACCEPTANCE OF WORK	:	Within 5 days of issue of letter of intent/order
COMMENCEMENT OF WORK	:	Within 10 days of issue of letter of intent/order
PERIOD OF COMPLETION	:	30 days from the date of issue of letter of Intent / order (Including holiday & Sunday)
LIQUIDATED DAMAGES	:	Rs 5,000 per week, subject to a max. 7.5% of the accepted Contract Sum.
PERIOD OF RUNNING BILL	:	Fortnightly
RETENTION MONEY/DEPOSIT	:	10 % of Gross Value from Each running Bill
REFUND OF RETENTION MONEY:	:	refunded 14 days after giving in writing a request after End of Defects Liability Period.
INCOME TAX DEDUCTION	:	At the Prevailing Rates from each bill
DEFECTS LIABILITY PERIOD	:	12 months after completion of Works
PERIOD OF FINAL MEASUREMENT	:	3 weeks from completion/ date of submission of Final Bill, whichever is later.



ROKAUS/P&E: TENDER/2023-24/11

Signature & Seal of the Contractor

क्षेत्रीय कार्यालय, कलेक्ट्रेट कम्पाउंड, मंजानपुर, कौशांबी-212207, दूरभाष: 05331-232990

Regional Office, Collectorate Compound, Manjhanpur, Kaushambi-212207, Telephone: 05331-232990

e-mail: rokaus@barodauprb.co.in

SECTION – I

INVITATION TO TENDERERS

SECTION- I

- 1.1 Sealed tenders on item rate basis are invited in the prescribed form by the REGIONAL MANAGER, Baroda U. P. Bank, Regional Office Kaushambi - 212207

TenderNo	NameofWork	Earnest Money	Time ofCompletion
ROKAUS/P&E: TENDER/2023-24/11	Furnishing and electrical work	5,000/-	30 days

- 1.2 The work as detailed in this tender shall be executed and completed in all respects within the stipulated period in accordance with the Tender Document, Bill of Quantities, Drawings and Instructions, to the satisfaction of the Architects and the Employers.
- 1.3 The tenderers is required to deposit Rs. 5,000/- for MAHESHGANJ Branch as **Earnest Money** along with the tender in the form of crossed Demand draft payable at Kaushambi, in favor of Baroda U.P. Bank. The earnest money will be refunded without any interest to the unsuccessful tenderers.
- 1.4 Tenders filled in the prescribed form should reach the office of **Regional Manager, Baroda U. P. Bank, Collectorate Compound, Manjhanpur, Kaushambi - 212207** latest by Date – 27.03.2024, 15:00 hrs. in sealed covers and super scribed with the name of the work and the tender No. They would be opened on the same day at 16:00 HRS. in the presence of contractor/ authorized representative with Bank officers.
- 1.5 Rates must be quoted for complete work at site, inclusive of all costs, taxes, any other charges etc. All charges like Sales tax, Works Contract tax, E.S.I charges etc... would be borne by the contractor and Employer will not entertain any claim whatsoever in this respect.
- 1.6 The tenders shall remain valid for acceptance by the Employer for a period of 3 months from the date of opening the tenders.
- 1.7 The Security amount and The Retention Money will be refunded without any interest as per the schedule mentioned.
- 1.8 The **Defects liability period** will be 12 months from the date of completion of Work. Any defects found during this period in the various jobs executed by the contractor will have to be rectified by him, without any extra charges. In case the Employer finds that the contractor has not carried out the rectification, then he is at a liberty to get the same executed by another contractor and adjust the amount spend from the Security Deposit of

ROKAUS/P&E: TENDER/2023-24/11

Signature & Seal of the Contractor

क्षेत्रीय कार्यालय, कलेक्ट्रेट कम्पाउंड, मंजानपुर, कौशांबी-212207, दूरभाष: 05331-232990

Regional Office, Collectorate Compound, Manjhanpur, Kaushambi-212207, Telephone: 05331-232990

e-mail: rokaus@barodauprrb.co.in

the main contractor.

- 1.9 The earnest money of the successful tenderers will be forfeited in the event of his refusal/ delay in starting the work. The decision of Regional Manager, Baroda U. P. Bank Kaushambi will be final in this.
- 1.10 Tender documents (complete) duly filled and signed by the tenderers shall be submitted as the tender for the work.
- 1.11 The Baroda U. P. Bank and the Architects, M/s Bharat and Associates do not bind themselves to accept the lowest or any tender, or to assign any reason thereof and also reserves the right of accepting the whole or part of the tender. The tenderers in such an event will be bound to perform the contract at the same rates as quoted in the tender for various works. Any item is liable for alteration at the discretion of the Architect & the Employer, if required.
- 1.12 Canvassing in any form in connection with the tender is strictly prohibited and the tenders submitted by the contractor who resorts to canvassing in any form will be liable for rejection.
- 1.13 The tendering firms, in case the tenderers is a partnership firm, shall submit the tender signed by all the partners.
- 1.14 On acceptance of the Tender, the Contractor shall intimate the name of his accredited representative who would be responsible for taking instructions from the architects and carrying out the works.
- 1.15 The successful tenderers will extend full co-operation with other contractors appointed by the employer, so that the work shall proceed smoothly. The main responsibility of the overall completion of the work in time will lie with the Furnishing Contractor.
- 1.16 The successful tenderers will need to sign the agreement, three sets, on stamp paper of Rs 100/- only. Tenderers failure to make such an agreement within the stipulated timeframe will amount to non- acceptance on his part. In this case the Employer will have the right to revoke the acceptance of tender without any further notice to the tenderers.
- 1.17 For calculation of L-1 tender rates of both furnishing and electrical work will be taken together.
- 1.18 Rate should be quoted inclusive of Freight Charges.

ROKAUS/P&E: TENDER/2023-24/11

क्षेत्रीय कार्यालय, कलेक्ट्रेट कम्पाउंड, मंझनपुर, कौशांबी-212207, दूरभाष: 05331-232990

Regional Office, Collectorate Compound, Manjhanpur, Kaushambi-212207, Telephone: 05331-232990

e-mail: rokaus@barodauprrb.co.in

Signature & Seal of the Contractor

Terms and condition of tender:

- Rates should be quoted on the space provided in **annexure attached only**. No other sheet/form should be used for quoting rates.
- **Rates quoted only by bank's empanelled vendors will be consider/accepted.**
- The competent authority (bank) does not bind themselves to accept the lowest or to give any reasons for its decision of acceptance or rejection of tenders.
- Incomplete in any respect or conditional tender shall liable to be rejected.

Other conditions:

- The registration number of the firm along with **GST no.** allotted by the authorities must be submitted.
- **PAN NUMBER** of the firm allotted by the income tax authorities should be submitted (without which the vendor's bid would become invalid and shall be liable to reject)
- Conditional tenders shall not be accepted on any ground and shall be rejected straight.
- Any deviation of the conditions given by the purchaser will not be accepted and bid will be rejected without assigning any reasons.
- If any clarification is required the same should be obtained before submitting the bid.
- The entire document must be signed with the seal and attached as mark of acceptance of terms and condition.
- BUPB reserve the right to accept or reject any bid whole or in parts without assigning any reason thereof.
- Bank's decision will be final and no correspondence will be entertained in this regard.
- In case of delays in submission/non submission of bids ,Bank will not assume any responsibility.
- Bank may reject any or all quotations without assigning any reason.
- Quoting incredibly low value of items with a view of subverting the tender process shall be rejected straight away.

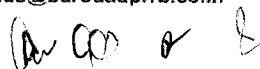

SECTION-II

INSTRUCTIONS TO TENDERERS

- 2.1 The tenderers are advised to visit and inspect the site at their own cost and responsibility and to secure all necessary information which may be required for completing the tender. Ignorance of site conditions or local information shall not be considered as an excuse for non- performance of the contract or any increase in the rates quoted by them.
- 2.2 The tenderers shall examine carefully all the tender documents consisting of:
- Invitation to Tenderers
 - Instructions to Tenderers
 - General and Special Conditions of Contract
 - Bill of Quantities
 - Set of Drawings

All the above shall form Part of the agreement.

- 2.3 Time is the essence of contract and the tenderers are required to complete the works in all respects to the satisfaction of the Architect & the Employer within the stipulated time.
- 2.4 The tender should contain the rates & the amount (both in figures and words), in the prescribed column of the BOQ. All the items should be totalled up in the end. All corrections should be duly attested by the tenderers. In case of any discrepancy between rates and amounts, the lower value will be taken for finalizing of the tender amount.
- 2.5 It shall be clearly understood that the rates quoted in the tender are to be, for complete work at site, as per the instructions to Tenderers, Conditions of Contracts, Specifications and Drawings and also for all such works as become necessary for proper completion of works, although specific mention thereof may not have been made in the specifications or drawings of tender documents. The rates shall be firm and not subject to cost escalation on account of labor and material conditions or any other reason whatsoever.
- 2.6 The tenderers shall use only the form issued with this tender to fill up the rates.
- 2.7 Every page of the tender shall be signed on the left hand side bottom corner.
- 2.8 The Contract will be governed by the Indian Contract Act, Indian Sale of Goods Act and all other relevant Laws. All payments due to the contractor under the contract will be made in Indian Rupees Currency.

ROKAUS/P&E: TENDER/2023-24/11

Signature & Seal of the Contractor

क्षेत्रीय कार्यालय, कलेक्ट्रेट कम्पाउंड, मंझनपुर, कौशांबी-212207, दूरभाष: 05331-232990

Regional Office, Collectorate Compound, Manjhanpur, Kaushambi-212207, Telephone: 05331-232990

e-mail: rokaus@barodauprrb.co.in

**SECTION-III
FORWARDING LETTER**

To,

Regional Manager
Baroda U.P. Bank
Regional Office
Kaushambi - 212207

FROM -----

Ref : Tender No. **ROKAUS/P&E: TENDER/2023-24/11**

Dear Sir,

With reference to the tender invited by you, I/we hereby offer to perform, provide, execute and complete the works in conformity with conditions of contract, drawings and specifications for the respective items of schedule of quantities attached here to.

I/we have satisfied ourselves as to the location and prevailing conditions of the site, and have read carefully the Articles of Agreement, Conditions of Contract, Specifications, General and Special Conditions, Technical Specifications, etc. I/we understand that the works are to be completed within ----- days from the date of issue of letter of Intent/ Order and fully understand that time will be the essence of the contract.

I/ we enclose a demand draft for MAHESHGANJ Branch, drawn on _____, payable at Kaushambi, in favor of Baroda U. P. Bank as Earnest Money and fully understand that this amount will not bear any interest.

I/we agree to keep the offer open for 90 days from the date of opening the tender.

Should this tender be accepted in whole or part, I/we hereby agree to abide by and fulfill all the terms and conditions annexed here to.

All the terms and conditions of tender have been fully read by me/us. I/we accept the same and sign here under in token of their acceptance.

We further enclose the following documents:-

- i) Partnership deed, Article of Association and Power of Attorney, as applicable. We agree that no change will be made in these documents without prior approval of Baroda U. P. Bank
- ii) Tender document duly signed.
- iii) Details of my firm
- iv) Latest ITCC

Name of Partners/ Directors

Yours Faithfully

Date :

Signature of Tenderers with Official Stamp.

ROKAUS/P&E: TENDER/2023-24/11

Signature & Seal of the Contractor

क्षेत्रीय कार्यालय, कलेक्ट्रेट कम्पाउंड, मंझनपुर, कौशांबी-212207, दूरभाष: 05331-232990

Regional Office, Collectorate Compound, Manjhanpur, Kaushambi-212207, Telephone: 05331-232990

e-mail: rokaus@barodauprrb.co.in

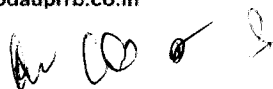

**SECTION –IV
GENERAL CONDITIONS OF CONTRACT**

4.1 DEFINATIONS

In this contract, the following words and expression shall have the meaning thereby assigned to them unless the contract ascribed a different meaning

- a) **Employer** means Baroda U.P. Bank and includes their authorized representatives to deal with any matter on their behalf.
- b) **Employer-in-charge** means the person appointed by the Employer and notified to the Contractor to be in charge of the project.
- c) **Clerk of Works** means any Engineer appointed by the Employer to perform the duties of Resident Engineer, limited to Supervision of Work and notified to the Contractor to be in charge of the project
- d) **Architects** mean the Architects Employed by Baroda U.P. Bank to give consultancy.
- a) **Contractor** means the individual, firm or Company with whom the contract is entered into and includes the heirs, executors, or successors.
- b) The expression **Contract** means the document forming the Tender and acceptance thereof and included all the sections of the tender including BOQ and set of drawings.
- c) **Tender** means the offer made by an individual or firm or company for execution of the works.
- d) **Acceptance of Tender** means the letter from the Employer communicating to the tenderer the acceptance of this tender and include the advance acceptance of his tender.
- e) **Drawings** means the drawings referred to in the tender documents including any modifications of such drawings approved in writing by the Architect or his representative and such other drawings as are made from time to time and furnished by the contractor and approved by the Architect.
- f) **Site** means the actual place as described in the tender at which the execution of works is to be done with the surrounding areas.

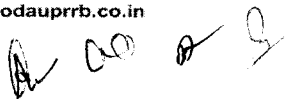

- g) **A Week** shall mean 7 days without regard to the number of Hours worked in a day in that week.
- h) **Specifications** means standard specifications for works and materials brought out in the tender, and added to or superseded by special specifications. In absence of any specifications for any item of work the relevant specifications in CPWD or IBA works Manual shall be followed and work be executed accordingly.

4.2.1 EXTENT OF CONTRACT

The contractor shall supply at his own cost all the materials like ladders, scaffoldings, temporary works that may be required for the proper execution of the works, whether original, altered or substituted works. The contractor shall also supply survey instruments and other materials necessary for purpose of setting out of works and assisting to the measurements or examination at any time.

The contractor shall also provide a sufficient portion of fencing and lights required to protect the public from accidents and shall be bound to bear any expenses of defense brought by any person for injury sustained owing to neglect of the above precautions, and to pay any damages and costs which may be awarded in any such suit, action or proceedings to any such person. In no case the Employer shall be a party to any such claim and the Contractor shall indemnify the Employer against any claim for any person on this account.

4.2.2 Sufficiency of Tender

The Contractor shall be deemed to have satisfied himself before tendering as to the correctness and sufficiency of his tender for the works and his prices for the work which shall cover all his obligations under the Contract and all matters and things necessary for the proper completion and maintenance of the work.

4.2.3 Sub- Letting of Contract

The contractor shall not assign the contract or any part thereof to any other party without the prior written consent of the Employer.

4.2.4 Power to make alterations

Architect shall have the powers to make any alterations or additions to the stipulated specifications, drawings, designs and instructions that he may feel necessary or advisable during the progress of the work. The contractor shall have no claim for compensation on account of such alterations or additions. The contractor shall be bound to carry out the work in accordance with any instructions which may be given to him in writing signed by the Architect and such alterations shall not in validate the

ROKAUS/P&E: TENDER/2023-24/11

क्षेत्रीय कार्यालय, कलेक्ट्रेट कम्पाउंड, मंझनपुर, कौशांबी-212207, दूरभाष: 05331-232990

Regional Office, Collectorate Compound, Manjhanpur, Kaushambi-212207, Telephone: 05331-232990

e-mail: rokaus@barodauprrb.co.in

Signature & Seal of the Contractor

Contract, and any additional work which the Contractor may be directed to do in the manner above specified as part of the work shall be carried out by the contractor.

The time for completion and Costs of such additional works shall be extended in proportion to the original contract. The certificate of the Architect shall be conclusive as to such proportions.

4.2.5 Works subject to approval of Architect

All works to be executed under the contract shall be subject to approval of the Architect who shall be entitled to direct at what points and in what manner they are to be commenced.

4.2.6 Urgent repairs and Urgent Works

If by any reason, during the execution of the work or during the defects liability period, any works or repair become urgently necessary and the Contractor is unable/unwilling to do such work immediately, then the Employer may get the same done on their own and deduct the cost thus incurred from the funds due to the contractor.

4.2.7 Clearance of Site

The Contractor shall have to remove all Malba from site of work, dirt and dust, etc. before handing over the works to the Employer. The works shall not be treated as complete in all respects unless these requirements are fulfilled.

In the event the Contractor failing to do so the architect and the employer shall have the right to get the site cleared at the contractors risk and cost.

4.2.8 Protection of Trees and Shrubs

Trees and Shrubs designated by the Architect shall be protected from damage during course of the work and the earth level shall not be changed within three feet of such trees.

4.3 ARCHITECTS STATUS AND DECISIONS

- a) The Architect shall have General supervision & direction of Works. He has authority on behalf of the Employer to stop the work whenever such stoppage may be necessary to ensure proper execution of the works. The Architect shall be the interpreter of the conditions of Contract and the judge of its performance.
- b) The Architect within reasonable time make decisions of all claims of the contractor and all other matters related to the execution and progress of work.

ROKAUS/P&E: TENDER/2023-24/11

Signature & Seal of the Contractor

क्षेत्रीय कार्यालय, कलेक्ट्रेट कम्पाउंड, मंझनपुर, कौशांबी-212207, दूरभाष: 05331-232990

Regional Office, Collectorate Compound, Manjhanpur, Kaushambi-212207, Telephone: 05331-232990

e-mail: rokaus@barodauprrb.co.in

The decision of the Architect with respect to all or any of the following matters shall be final :

1. Variation/Modification of the Design
2. Quality and Quantities of Works Executed
3. Discrepancies in the drawings and Specifications
4. Opening up for inspection of any work covered up.
5. Amending of any defects occurring under Defects Liability Period

- c) The Contractor shall on the report of the Architect immediately dismiss from the works within 24 hrs any person employed thereof by him who may in the opinion of the Architect/ Employer be incompetent/ misconducts himself.

4.4 DIRECTIONS REGARDING DRAWINGS & DESIGN

- a) After signing the Contract, the Contractor will be given three sets of drawings free of charge. Additional copies if required would be made at his own costs. One set of the drawings shall be kept at the site by the contractor and available to Architect/ his representative at all times.
- b) Further drawings and Instructions including revisions, as the Architect may furnish to the contractor shall form part of this contract.
- c) Only figured dimensions and detailed drawings shall be followed. The Contractor shall verify all dimensions in the field before any work is commenced and obtain instructions of the Architect in case of any discrepancy.

4.4.2 **Action where no specifications**

In case of any work for which there are no specifications in the contract, such works shall be carried out in accordance with the directions of the Architect.

4.5 DIRECTIONS FOR EXECUTION OF WORKS

4.5.1 **Setting Out**

The Contractor shall be responsible for the true and proper setting out of works. If at any time during the progress of the work any error shall appear in any part of the work, the Contractor shall rectify the errors. The checking of any setting out by the Employer/ Architect shall not in any way relieve the contractor of his responsibility for the correctness thereof.

4.5.2 **Engagement of labor**

ROKAUS/P&E: TENDER/2023-24/11

Signature & Seal of the Contractor

क्षेत्रीय कार्यालय, कलेक्ट्रेट कम्पाउंड, मंझनपुर, कौशांबी-212207, दूरभाष: 05331-232990

Regional Office, Collectorate Compound, Manjhanpur, Kaushambi-212207, Telephone: 05331-232990

e-mail: rokaus@barodauprrb.co.in



The Contractor shall employ labor in sufficient numbers to maintain the required rate of progress and Quality of work. No child labor will be employed by the Contractor.

The contractor shall comply with all the provisions of Minimum wages Acts, Industrial Disputes Acts, ESI Acts.

The Contractor shall indemnify the Employer against any payment to be made under and for observance of the Regulations aforesaid without prejudice to his right to claim Indemnity from his sub- contractors.

The contractor shall provide at his own cost for the protection of the works and for the Safety of those employed on works or the Public.

4.5.3 Water and Power Requirements

All arrangements for water and Power required shall be made by the Contractor at his own costs and nothing extra on this account shall be paid to him. Similarly filtered water required for drinking purposes for the laborers shall also be arranged by the Contractor at his own cost.

The contractor shall make necessary arrangements for procuring petrol/ diesel for machinery or for Power generation to ensure uniform progress of work in the event of Powerfailure.

No extension of time of completion of the contract shall be allowed on account of Power failure.

4.5.4 Disruption of Progress

The Contractor shall give written notice to the Architect whenever progress of work likely to be delayed. The notice shall include details of the drawings or order required and of why and when it is required and of any delay likely to be suffered if it is late.

If for any reason, within reasonable time, the Architect is unable to give directions, and the work suffers, then the Architect shall take such delay into account in determining any extension of time to which the Contractor is entitled.

4.5.5 Rectification of Defects

If it appears to the Architect that any work has been executed with imperfect workmanship or inferior material, then the Contractor shall rectify/reconstruct the part so specified.

4.5.6 Samples

ROKAUS/P&E: TENDER/2023-24/11

Signature & Seal of the Contractor

क्षेत्रीय कार्यालय, कलेक्ट्रेट कम्पाउंड, मंझनपुर, कौशांबी-212207, दूरभाष: 05331-232990

Regional Office, Collectorate Compound, Manjhanpur, Kaushambi-212207, Telephone: 05331-232990

e-mail: rokaus@barodauprrb.co.in

Samples of all materials to be used in works, shall be submitted for approval to the Architects, within four days of commencement of Contract.

The costs for preparing samples will be borne by the contractor.

4.5.7 Inspection of Works

All works in execution stage or executed shall be open to inspection and supervision of the Architect/his representatives. During the Visit of the Architect, the Contractor or his representative should be available onsite.

4.5.8 Preparation of Program Schedule

The contractor, in consultation with the Architect shall prepare a program schedule of the various activities, before commencing of the works.

4.5.9 Extension of Time for Completion

If the contractor shall desire an extension of the time for completion of the work, on his having been unavoidably hindered in its execution or on any other ground, he shall apply in writing to the Architect within 3 days of occurrence of such hindrance and the extension he so desires.

The Architect, in consultation with the Employer shall, if, in his opinion will authorize such extension of time as may be proper.

4.5.10 Liquidated Damages for Delay

The time and Date stipulated in the contract for the completion of the work shall be deemed to be the essence of the contract. If the contractor fails to carry out the works within the stipulated time or the extended time if given, then he shall pay to BARODA U.P. BANK a sum of Rs. 5,000/- per week as Liquidated damages, for the period the works remain unfinished. The total amount of such a penalty shall not exceed 7.5% of the total Contract Price.

4.5.11 Defects Liability Period

The Contractor shall be responsible to make good and remedy at his own expense within such period as may be stipulated by the Employer any defects which may develop or may be noticed before the end of 12 months from the Certified Completion date and intimation of which has been send to the contractor within 7 days of the expiry of the said period.

If the Contractor, while rectifying the above defects, damages any other area of the site, will make good the related defects also at his own expense. In case he does not do so then the same would be got done by the Employer and expenses would be deducted from the amount due to the

ROKAUS/P&E: TENDER/2023-24/11

Signature & Seal of the Contractor

क्षेत्रीय कार्यालय, कलेक्ट्रेट कम्पाउंड, मंझनपुर, कौशांबी-212207, दूरभाष: 05331-232990

Regional Office, Collectorate Compound, Manjhanpur, Kaushambi-212207, Telephone: 05331-232990

e-mail: rokaus@barodauprrb.co.in

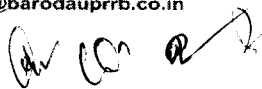

contractor.

4.6 MEASUREMENTS AND PAYMENTS

- 4.6.1 A bill supported with measurement details shall be submitted by the contractor fortnightly to the Architect for all works executed and the Architect or his Representative shall verify the requisite measurements. All bills shall be submitted in Triplicates.

All such intermediate payments to the contractor shall be regarded as payments by way of advance against the final payment and not as payments for works actually done and completed and shall not preclude the requiring of bad and imperfect work to be rectified or considered as an admission of due performance of the contract.

Income tax deductions will be made as per the prevailing rates from the contractor's on accountbills.

4.6.2 **Final Bill**

Final bill supported with consolidated measurements of the full work executed shall be submitted by the contractor, the same will be verified by the Architect within Three weeks of Completion of Works.

After Verification, the Architect will give seven days' notice to the Contractor to Countersign the bill as a token of acceptance or intimate in writing his intention to dispute. If the Contractor fails to take appropriate action within the prescribed period as above, then the bill finalized by the Architect shall be final and binding on the Contractor.

4.6.3 **Claim for Interest**

No Claim for interest will be entertained by the Employer, with respect to any money balances as lying with the Employer.

4.6.4 **Rates for Extra, Additional, Altered or Substituted works.**

The rates for additional, altered or substituted work shall be worked out in accordance with the following provisions, in their respective order.

- i) If rates for similar works are directly available in the Contract for the work, the contractor is bound to carry out at the same rates as available in the contract.
- ii) If rates are not directly available in the contract, then they will be derived from the rates for a similar class of works as are specified in the contract.
- iii) If the rates cannot be determined, then the Contractor shall submit a detailed cost analysis as per market rates for same. The Architect will settle such claims.

4.7 GUARANTEES

4.7.1 **Quality of Work**

The Contractor shall guarantee that the materials and workmanship are the best of their respective kinds for the service intended and that all items of work will be free from all inherent defects in workmanship and materials. He shall also guarantee that the works will not fail in any respect due to quality of materials, workmanship and method of construction.

The Specifications assume a proper degree of Skill on the part of the Contractor and Workmen Employed. The Contractor shall consult the Architect, whenever in his judgment variation in the methods of Construction or in the quality of material would be beneficial or necessary to fulfill the guarantee called for. Such variations may be made by the Contractor, only when authorized by the Architect.

4.7.2 **Cost of Execution of work or repair etc.**

All works of repair shall be carried out by the contractor at his own expense if the necessity thereof shall in the opinion of the Architect be due to the use of materials or workmanship not in accordance with the contract or on account of neglect or failure on the part of the contractor to comply with any obligation expressed or implied on the contractor's part under the contract.

4.7.3 **Remedy on Contractor's failure to carry out the works required.**

If the contractor shall fail to do any such work as the aforesaid required by the Architect. The Employer shall be entitled to carry out such works at the contractor's own cost and recover the same from any money that may become due to the contractor.

4.7.4 **Contract Valid during Guarantee Period**

This contract shall remain valid and in force until the expiry of Guarantee Period.

4.8 RESCINDING/ TERMINATE CONTRACT

4.8.1 In any case under any clause of this contract, the contractor has rendered himself liable to pay compensation amounting to whole of his retention deposit in hands of Employer, the Architect in consultation with the Employer, on his behalf shall have power to adopt any of the following courses-

- a) To rescind the contract (of which rescission notice in writing to the contractor shall be conclusive evidence)
- b) To employ a contractor paid by the Employer and to supply

ROKAUS/P&E: TENDER/2023-24/11

Signature & Seal of the Contractor

क्षेत्रीय कार्यालय, कलेक्ट्रेट कम्पाउंड, मंजानपुर, कौशांबी-212207, दूरभाष: 05331-232990

Regional Office, Collectorate Compound, Manjhanpur, Kaushambi-212207, Telephone: 05331-232990

e-mail: rokaus@barodauprrb.co.in

- materials to carry out the work or any part of the work, debiting the contractor with the cost of the labor and the price of the materials.
- c) To measure up the work of the contractor and to take such part of the work of the contractor as shall be unexecuted out of his hands and to give it to another contractor to complete. In this case any expense which may incur in excess of the sum which would have been paid to the original contractor, if the whole work had been executed by him, shall be borne and paid by the original contractor and may be deducted from any money due to him by the Employer.

In the event of any of the above courses being adopted by the Architect, the Contractor will have no claim to compensation to any loss sustained by him.

4.8.2 Termination of the Contract

If at any time after the commencement of the work the Employer for any reason whatsoever not require the whole or part thereof as specified in the tender to be carried out, Architect shall give notice in writing of the fact to the Contractor who shall have no claim to any payment or compensation whatsoever on account of any profit or advantage which would have derived from the execution of the work.

4.8.3 Jurisdiction

The contract and its operation shall be governed by the laws of India, for the time being in force. The contract shall be deemed to have been entered into at Regional Office Kaushambi.

4.8.4 Bye Laws and Local Authorities

The contractor shall conform to the provisions of any Govt. Acts and regulations of Local Authorities. Contractor would pay all charges and fees for towards Stacking, etc. The Contractor shall keep the Employer indemnified against all penalties and liabilities incurred in connection with the said contract.

The contract will be governed by the Indian Contract Act, Indian Sales Act and all other relevant laws.

4.8.5 Arbitration

All disputes related to the said contract shall be referred to the arbitration of the person appointed by the Employer. All rules will be subject to Arbitration Act 1940, or any statutory modification or re-enactment thereof.

It is a term of the contract that if the Contractor does not make any demand for arbitration in writing within 30 days of receiving the intimation from the Employer that bill has been certified for Payment, the claim of the contractor will be deemed to have been waived absolutely barred and the Employer shall be discharged and

ROKAUS/P&E: TENDER/2023-24/11

Signature & Seal of the Contractor

क्षेत्रीय कार्यालय, कलेक्ट्रेट कम्पाउंड, मंजानपुर, कौशांबी-212207, दूरभाष: 05331-232990

Regional Office, Collectorate Compound, Manjhanpur, Kaushambi-212207, Telephone: 05331-232990

e-mail: rokaus@barodauprrb.co.in

released of all liabilities under the contract.

4.8.6. Discretion

Bank can at any time cancel/alter/modify the terms and conditions mentioned herein before signing the contract. All conditions are at sole discretion of the bank.

**SECTION –V
FORM OF AGREEMENT**

This agreement made at.....day of.....2024..... between Baroda U.P. Bank, Regional Office, Kaushambi (hereinafter referred to as the Employer which expression shall include their heirs, executors, administrators and assigns) of the one part and.....of or whose registered office is situated at..... (herein after referred to as Executors which expression shall include their heirs, executors, administrators and assigns) of the other part.

WHEREAS the Employer is desirous of..... (herein after called “the work”) at..... and has caused drawings and BOQ specifications describing the work to be done to be prepared by..... and whereas the contractor supplied the employer with a fully priced copy of the said bills of quantities (which copy herein after referred to as “the contract bills”) and whereas the said drawings and Specifications and the Price Schedule of Quantities have been signed by both the parties and the contractor has agreed to execute upon.

NOW IT IS HEREBY AGREED AS FOLLOWS

In consideration of the said contract, payments to be made to the contractor as hereinafter provided he shall upon and subject to the said conditions execute and complete the works shown upon the said drawings and such further detailed drawings as may be furnished to him by the said Architects and described in the specifications and the said Priced Schedule of Quantities.

The Employer shall pay the Contractor such sums as shall become payable hereunder at the times and in the manner specified in the said conditions.

The said Contract comprises the building above mentioned and all subsidiary works connected there within the same site as may be ordered to be done from time to time by the said Architects even, though such works may not be shown on the Drawings or described in the said Specifications or the Priced Schedule of Quantities.

The Employer through the Architect reserves to himself the right of altering the drawings and nature

ROKAUS/P&E: TENDER/2023-24/11

Signature & Seal of the Contractor

क्षेत्रीय कार्यालय, कलेक्ट्रेट कम्पाउंड, मंझनपुर, कौशांबी-212207, दूरभाष: 05331-232990

Regional Office, Collectorate Compound, Manjhanpur, Kaushambi-212207, Telephone: 05331-232990

e-mail: rokaus@barodauprrb.co.in

of the work and adding to or omitting any items of work or of having portions of the same carried out otherwise and such alterations shall be carried out without prejudice to this contract.

The Employer in consultation with the Architect reserves the right to exercise control on quality of work, check the measurements, approval of rates of extra or substituted items. The decision of the Architect shall be final and binding in this regard.

The following documents shall be deemed to form and construed as part of this agreement along with the amendments, negotiated and confirmed in various subsequent letters exchanged as mentioned herein after and parties here to will respectively abide by and submit themselves to the Conditions and Stipulations and perform the agreement on their parts respectively in such conditions contained

- a) Notice inviting Tender
 - b) Instructions to Tenderers
 - c) General Conditions of Contract
 - d) Special Conditions of Contract
 - e) Technical Specifications
 - f) Schedule of Quantities
 - g) Employers letter dated..... to the Contractor awarding the Contractor awarding the Contract
 - h) Contractors letter dated.....to the Employer in acceptance of the award of Contract
2. All dispute arising out of or in any way connected with the agreement shall be deemed to have arisen at Kaushambi, the Court in Kaushambi shall have jurisdiction to determine the same.

Witness

SIGNED BY THE SAID EMPLOYER

Witness

SIGNED BY THE SAID CONTRACTOR

ROKAUS/P&E: TENDER/2023-24/11

Signature & Seal of the Contractor

क्षेत्रीय कार्यालय, कलेक्ट्रेट कम्पाउंड, मंजानपुर, कौशांबी-212207, दूरभाष: 05331-232990

Regional Office, Collectorate Compound, Manjhanpur, Kaushambi-212207, Telephone: 05331-232990

e-mail: rokaus@barodauprrb.co.in

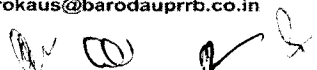

SECTION-VI

SPECIAL CONDITIONS OF CONTRACT

Insurance for Works

The contractor before commencing on execution, without limiting his obligation shall insure the works against all acts of God, at his own costs and keep them insured till the completion of the project, in the joint names of the Employer and the contractor, for the full amount of the Contract.

The Contractor shall deposit the policy and receipt for the premiums with the Employer within 7 days from the date of signing of the contract. In case the Contractor fails to do so, and then the Employer can make the required Policy and deduct the amount from the Contractors amount due.

Insurance in respect to damage to persons and property

The contractor shall be responsible for all injury to persons, animals or things and for all structural and decorative damage to property which may arise from the operation or neglect of himself or any other person employed by him.

The clause shall be held to include any damage to buildings whether immediately adjacent or otherwise. The Contractor shall indemnify the Employer and hold him harmless in respect of all and any expenses arising from any such injury or damage to persons or property.

The Contractor shall reinstate all damages of every sort mentioned, due to his contract work to the property of third parties.

The Employer shall be at liberty and is empowered to deduct the amount of any damage or compensation levied on him due to the negligence of the Contractor.

Such insurance will not limit or bar the liability and obligation of the contractor to deliver the works to the Employer complete in all respects as per the contract. In case of loss or damage, the money payable under any insurance shall be received and retained by the Employer until the works are finally complete and such money shall then be credited to the Contractor in final settlement of accounts.

ROKAUS/P&E: TENDER/2023-24/11

Signature & Seal of the Contractor

क्षेत्रीय कार्यालय, कलेक्ट्रेट कम्पाउंड, मंजानपुर, कौशांबी-212207, दूरभाष: 05331-232990

Regional Office, Collectorate Compound, Manjhanpur, Kaushambi-212207, Telephone: 05331-232990

e-mail: rokaus@barodauprrb.co.in

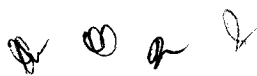

MAHESHGANJ

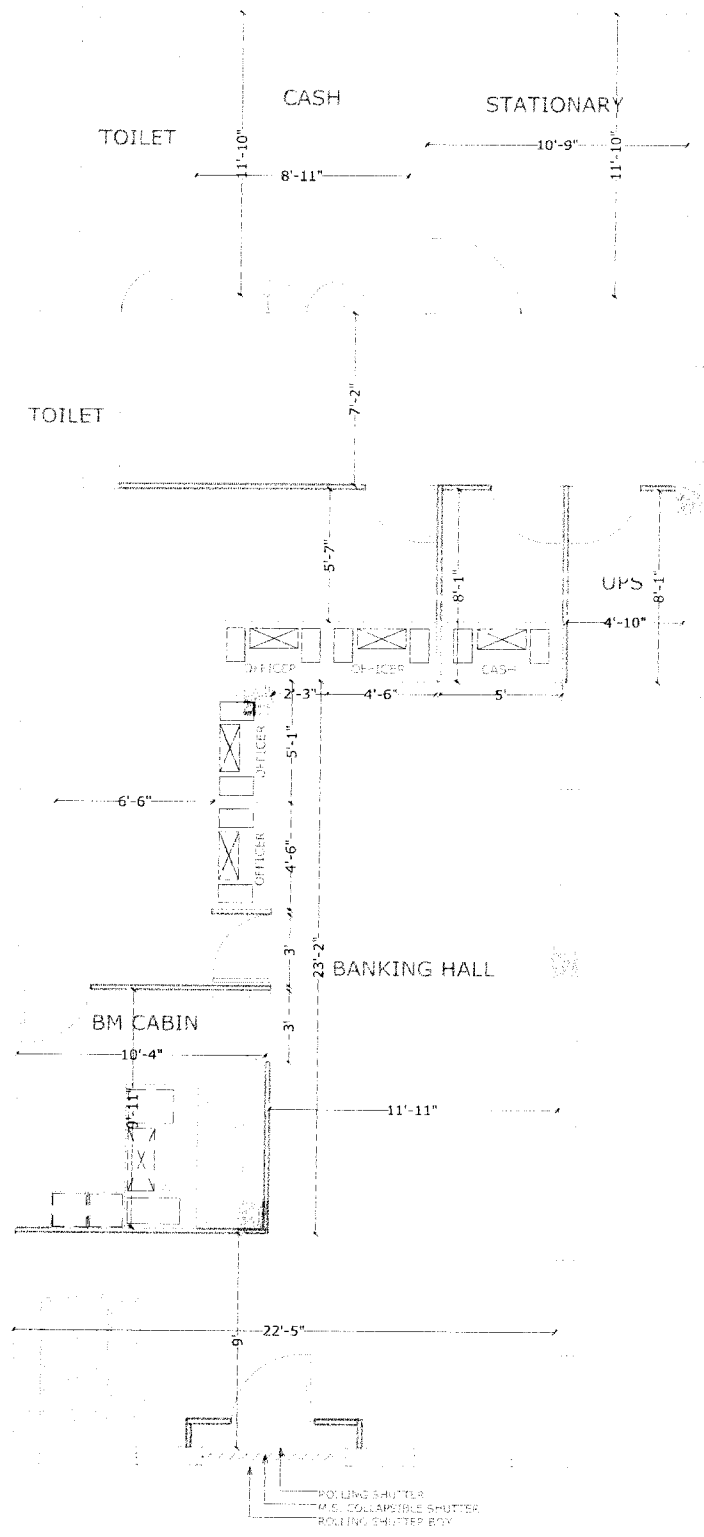

1.

2.

3.

Ref No.: BA/03/5055/2024

Dated 05-03-2024

**DETAILED ESTIMATE / SPECIFICATION FOR BILL OF QUANTITIES
 OF FURNISHING & ELECTRICAL WORK FOR BARODA UP BANK BRANCH AT MAHESHGANJ**

Sl.no	Description of items	Unit	Qty.	Rate	Amount
A (FURNISHING WORK)					
3	PAINTING WORK with Two Coat POP Base (Only Hall Area)	Sft	2310		
	Painting on undecorated / decorated wall and ceiling surfaces with two or more coats of acrylic emulsion (Asian/Berger make) (as / shade approved by the Architect) of approved brand. It shall include for preparing the surfaces clean, even and smooth with thoroughly brushing with broom, scratching with patti and sand papering respectively, so that the surfaces are free from oil, grease, dirt, mortar droppings & other foreign and loose matter. It shall also include for preparing the surface and filling of holes with plaster of paris before priming coat of whiting / approved primer. The rate shall include cost of all materials such as plaster of paris, whiting / primer, glue (Fevicol), indigo / stainer, brushes, sand paper, patti, dhoti, broom stick, clean water with storage and other containers, labour, scaffolding / ladder charges, cleaning of floors and other sundries etc., all complete to the satisfaction of the Architect.				
4	Entrance Door Branch	Sqft	125		
	Providing fabricating & fixing in position twin -style door at Main Entrance made of anodized/powder coated Aluminum sections of size 100mm height x 50mm thick aluminum bottom rail, 100mm x 50mm thick vertical and top rail 100mm x 50mm thick lock rail floor spring of ISI make, clip sections and 12mm thick glass(Modi/ Saint Gobain make) including fixing the frame to brick wall/RCC/wooden surfaces with necessary fasteners to have proper fixity including all incidentals etc complete. Glass to be fixed in the grooves of the aluminum sections with necessary materials/beading etc. The job also includes cost of providing & fixing heavy duty double action hydraulic floor spring (ISI mark) in the floor, fixing the door on it, including necessary fixing materials on the lintel/bottom, bolts, locks & satin finish stainless steel decorative tubular handles(approx.300mm long) on both faces complete as per drawing and instructions. All members to be 16 gauge. The vertical shutter rail to house wool packing to act as a sealant for a gap between shutter and frame fixed glazing. The rate should also include cost for decorative etching on the glass.				
5	Computerised Ledger & Cash Counter				
	Providing and placing in position ledger counter with top, vertical sides/dividers, skirting and fascia made out of 19mm thick water proof board with 1mm thick laminate (as/shade approved by the Architect) on all exposed surfaces. It shall also have 75mm x 40mm teak wood runners below the top and for footrest below. Every unit shall be provided with a side unit (size - W-500mm, H-750mm, D-500mm approx.), consisting of 150 mm deep drawer at top and a cabinet with open able/hinged shutter below.				

Sl.no	Description of items	Unit	Qty.	Rate	Amount
	. The fascia of drawer and shutter of cabinet below shall be made out 19mm thick water proof board with 1mm thick laminate (as/shade approved by the Architect) and sides and bottom of drawer shall be made out of 12mm thick water proof ply. The side unit shall have CAM locks, handles, guides, sliding units, hinges, magnetic catcher's etc. of approved make. Every unit shall be provided with a keyboard drawer unit (size - W-550mm, H-100mm, D-300mm approx.) below. The counter shall have 100mm deep fascia, below the top, in which keyboard drawer unit shall be adjusted.				
	It shall be made out 19mm thick water proof board with 1mm thick laminate (as/shade approved by the Architect) and sides and bottom of drawer shall be made out of 12mm thick water proof ply. The unit shall have CAM locks, handles, guides, sliding units etc. of approved make. The job shall include for 6mm x 6mm grooves in between sides and open able drawers and hinged shutters. All the exposed edges of water proof board and ply shall be provided with 6mm thick teak wood/hard wood lipping. All teak wood surfaces shall be melamine polished and other internal surfaces shall be painted with two coats of synthetic enamel over one coat of primer, all complete to the satisfaction of the Architect.				
a	High Level	Rft	5		
	High level (two levels) Computerised cash counter.				
	Lower level top shall be 900mm wide and at 750mm level from floor & upper level top shall be 250mm wide (and at 1150 mm				
b	Low Level	Rft	19		
	Low level (two levels) Computerised ledger counter including 1.5 ft High 12 m.m. glass in front of counter with brass clamps The edges of the glass to be machine polished.				
	Lower level top shall be 900mm wide and at 750mm level from floor & upper level top shall be 150mm wide and at 900mm level from floor				
6	Partly glazed partition for cash cabins (Wall side partition not to be done)	Sft	165		
	Decorative Grill (12mm thk)-hexagonal opening as per instruction of Bank's Engineer/Architect.) All exposed edges of Plywood shall be fixed with 1/8" C.P.Teak Lipping.				



Sl.no	Description of items	Unit	Qty.	Rate	Amount
	Providing and fixing of Cash Enclosures at height of 7'-4" with Anodized aluminium frame work, heavy sections (2mm thickness) of 2"x1.5", spacing of 2'0"x2'0" on bothsides and covered 6mm thick BWR plywood finished with 1mm thick laminate of blue, red colours for skirting & borders.Partition shall have provision for opening and 19mm BWR plywood tray for challan receiving purpose. Cost include aluminium grill and fixed with teak wood beading and duco paint. Cost also include 3 Nos of Solid core flush Doors with sizes of 2'6"x7'0", fixed in the partition. Door shall have teak wood beading and lipping with duco paint. Door finished with 1mm thick laminate of white colour for base and red & blue for skirting of approved pattern. Door shall have 8mm glass fixed with teak wood beading and duco paint. Rate to include hardware's like brass hinges, godrej three nos of night latch, door closure, door stopper and handles. Cost also include cash transaction opening shall be provided with door arrangements made with BWR plywood frame work finished by laminate, duco paint and locking system. Cost include wastages, transports, loading, unloading charges, labours, materials, tools, lead, lift and etc.Complete as per drawings and instructions of the Architect.				
	Solid till 4'-0" then Aluminium Decorative Grill height till 7'-0"then again solid				
7A	FULL HEIGHT GLAZED & UNGLAZED PARTITION (HT -8'-6")	205.00	Sq.Ft		
	Glazed Partition(upto false ceiling height only considered and above necessary ceiling supports to be provided) with Anodized Aluminium frame work, heavy sections (2mm thickness) of 2"x1.5" section, spacing of 2'0"x2'0" on bothsides and covered with 9mm thick BWR plywood finished with 1mm thick laminate of skirting & borders on both sides.Above 1'0"/2'6"/3'0" height partition, fixed with 8.0 mm bevelled glass with 3m sticker works door and teak wood beading with duco paint. Clear glass shall be finished with frosted film sticking over the glass of approved pattern and design. Rate to include providing cutouts and provisions to run electrical conduits, switches, etc..Cost include wastages, transports, loading, unloading charges, labours, materials, tools, lead, lift and etc.Complete as per drawings and instructions of the Architect.				
	The job shall also include for provision of laying conduits, switch boxes etc. The erection of partition shall include for expansion bolts cleats, clamps bolts, nuts, screws, rivets and other accessories, all complete up to the satisfaction of the Architect.				
	All door opening shall have rebated teak wood framework (size - 75mm x 50mm, as per profile) on vertical (2 Nos.) and horizontal (1 No.) sides, with melamine finish and rebate of 40mm x 12mm, all complete up to the satisfaction of the Architect.				
	the partition and doors shall have hinges floor springs/sliding arrangement/hydraulic door closer, mortise locks (Godrej make all), etc. The rate shall include cost of all materials, labour, T&P, wastages, etc. required for proper completion of work, all complete to the satisfaction of the Architect.				
B	Partly glazed low height partition	Sft	185		
	Same specification as in 1 but P/F half height partition of height 4'-6" with wooden laminate till 3'-0" and 1'-6" height 12 mm thick glass secured with D brackets including all hardware necessary with the same specs.as above.				

Handwritten signatures and initials: AL, CO, R, B

Sl.no	Description of items	Unit	Qty.	Rate	Amount
8	Providing and fixing Column & wall Panelling consisting of 2" x 1 " 18 gauge section placed at 2'0x2'-0" horizontally and vertically with Unannodised Alluminium size 1.5mm thick of JINDAL/INDAL confirming to ISI 303 standard as internal frame structure (as per site requirement) framework. The framing shall be fixed with with 8mm thick MR grade ply + 6 mm MDF of approved make firmly screwd to the aluminium frame on either side finished with 1mm th (high glossor texture) laminate as per approved sample. Item includes providing and fixing 12x12mm steem beech wood beading	Sft	422		
	making 6 mm grooves complete with polish & melamine spray finish on wood surface/grooves as per architectural drawings finished with 1mm thick laminate. Item includes providing and fixing 100mm wide skirting of 1mm thick mettalic laminate as per approved sample. Note: Surface measurement for one face & visible areas below false ceiling will be made for payment.				
9	Manager's table + Side Table with 12mm thk glass top	Each	1		
	Providing and fixing in position manager's table of size 6'-0"x2'6" as per drawing no. including side storage (credenza)by using 25 mm thick plywood for top and 18 mm thick plywood for all other horizontal and vertical members. Telescopic CPU stand/ready made keyboard tray shall be provided of approved model and make. Footrest made with TW member of size 4"x1 1/2 " finished with french polish.as per.				
	drawing shall be provided. Facia of side storage(credenza) shall be finished with 1 mm thick laminates as shown in the drawing and all other sides shall be finished with white enamel paint. The side storage (credenza) shall be provided with handles (stainless steel finish) and channels as per approval of the project consultant/bank . all exposed plywood surfaces to be finished with 1 mm thick . laminates of approved make and shade and all exposed edges of table top and ply verticals to have 1" x 1/4" TW lipping , all exposed TW section to be melamined and internal surfaces to have white enamel paint as directed. Item ti include plywood boxing , all necessary hardware and fittings in stainless steel finish , lipping to all eds etc. complete in all respect.				
	Same specification as above				
11	Full height storage / low height storage/ back storage (credenza)	Sft	120		
	Providing and fixing in position full height storage / low height storage / back storage (credenza) as shown in drawing no. (8) (9) and (10) respectively using plywood of required thickness finished with 1 mm thick laminates as shown in the drawing and all other sides shall be finished with white enamel paint as detailed therein.				



Sl.no	Description of items	Unit	Qty.	Rate	Amount
	The storage units shall be provided with handles (stainless steel finish) as per approval of the project consultant/bank.				
	All exposed plywood surfaces to be finished with 1 mm thick. Laminate of approved make and shade and all exposed edges of plywood to have 1"x1/4" TW lipping . all exposed TW section to be melaminated in matching colour laminate and internal surfaces to have white enamel paint as directed . item to include all necessary hardware an fittings in stainless steel finish ., Godrej multi purpose locks including magnetic ball catcher etc. complete in all respect.				
12	12 MM THICK GLASS FOR CASH CABIN				
	Providing & fixing 12 m.m. glass in front of cash cabin with brass clamps including cut out for passing currency as/details.The edges of the glass to be machine polished.	Sq. ft.	55		
13	Suggestion box	No	1		
14	Public writing wall stand (including cost of fitting) 36"x16"x9" 19mm Board, 1.00 mm thick mica, teak wood beeding, Polish/Paint with fitting.	No	1		
15	Check drop box	No.	1		
		Total	A (Furnishing work)		

B (ELECTRICAL& NETWORKING WORK)

	A -Electrical wiring (All switches to be Modular type - Anchor/ Havells or equivalent approved by architect)				
	<u>Light & Fan points</u>				
1	Supply & Installation of concealed point wiring using 600v grade 3x1.5 Sq.mm copper conductor PVC insulated wires (with proper R,Y,B color code) pulled through heavy gauge 19mm PVC conduit pipe heavy duty concealed in wall/ floor/ panelling/ partitions or above false ceiling as per requirement including 2 Nos. 2.5 sqmm circuit wires from the relevant DB and also including 1.5 sqmm green color copper earth wire and switch plate, switches, etc. as approved by the Bank's Engineer/Architect. All switch & sokets shall be modular type complete with cover plate & GI/ MS box. The work shall also include for cutting chase for conduits and moulded boxes, if required, in the wall/ floor (Without damaging the building/wall) along with clamping the conduit at every 600mm interval & finally finishing the surface & matching the same with the existing surface.The rate should include the cost of all materials, labour, T&P, taxes & levies, scaffolding, shifting of				
a	Light points + AFF points including the cost of 6A switch	Point	54		
b	Ceiling Fan Point including the cost of 6A Switch along with electronic regulator	Point	12		
c	Wall Fan Point along with 6A switch	Point	5		
d	6A switch & Socket on SDb	Point	7		
2	RAW POWER POINT				
	Single Power Points - Supply & Installation of point wiring for Raw power plug points on workstations / table for computers using 2 X2.5 + 1x1.5 Sq.mm copper conductor PVC sheathed flexible wire pulled through heavy gauge 19mm PVC conduit pipe heavy duty concealed in wall/ floor/ panelling/ partitions or above false ceiling as per requirement. Each point consisting of 1 nos of 16A , 2/3/5 pin sockets & 1 No.16A Switch wired together forming one point. The earth wire of green color only. All switch & sokets shall be modular type complete with cover plate & GI/ MS box. The work shall also include for cutting chase for conduits and moulded boxes, if required, in the wall/ floor (Without damaging the building/wall) along with clamping the conduit at every 600mm interval & finally finishing the surface & matching the same with the existing surface.The rate should include the cost of all materials, labour, T&P, taxes & levies, scaffolding, shifting of furniture, carting away the debris and cleaning the floor etc.The job shall be complete & to the entire satisfaction of the Bank.	Point	7		

Sl.no	Description of items	Unit	Qty.	Rate	Amount
3	AIR CONDITIONING				
a	AIR CONDITION POINTS - Circuit wiring with 2x4.0sq.mm + 1x 1.5sq.mm stranded Cu. conductor (Finolex/Anchor/Skytone) in 19mm M S conduit pipe heavy duty 16swg laid & concealed in wall/ floor/ panelling/ partitions or above false ceiling as per requirement. The job includes supply & fixing of flush mounted 4in one appliance protector pre-wired, IP 20 with factory fitted 25A, 2P MCB and 25A socket (Hagers/ Siemens/ ABB). The rate should include the cost of all materials, labour, T&P, taxes & levies, scaffolding, shifting of furniture, carting away the debris and cleaning the floor etc.The job shall be complete & to the entire satisfaction of the Bank.	Point	4		
4	UPS				
A	Sub Main Wiring/ Cabling - : SITC of sub main wiring 4nos. 10 sq mm Stranded copper wires for UPS Input from main incoming panel to incoming Db of UPS power input system etc. in 25mm dia PVC haevy duty conduit complete to the satisfaction of the bank.	JOB	1		
B	UPS Power Input System: SITC of 4way TPN Double door Db IP 42 horizontal Complete with 1no. Incoming 32A. TP MCB and 3 x 32A 2P MCB's to regulate supply for UPS complete in all respect as required and to the satisfaction of the bank.	Set	1		
C	Wiring for UPS Input & UPS Output (For both Critical 2Kva & Non-Critical 3Kva UPS) with 2x4.0sq.mm + 1x 1.5sq.mm stranded Cu. conductor (Finolex /Anchor /Skytone) to be laid in 19mm PVC pipe heavy duty/ Flexible pipe laid & concealed in wall/ floor/ panelling/ partitions or above false ceiling as per requirement. The rate should include the cost of all materials, labour, T&P, taxes & levies, scaffolding, shifting of furniture, carting away the debris and cleaning the floor etc.The job shall be complete & to the entire satisfaction of the Bank.	JOB	1		
D	S/F of 32A 2P MCB in 2way metallic box including proper connectionbs thru lugs. Both the Db's shall be inter looped- Qty included in item 3. (2nos. For ATM and 2nos. For Branch)	Each	1		
E	UPS Output Power Distribution System: SITC of 12 way SPN Db Double door IP -43 Siemens make with 32A DP 10kA MCB and 09 nos. SP 10kA MCB complete in all respect and as required & to the satisfaction of the bank. Siemens/ L&T/ MDS/ Schnider	Set	1		
F	Input Wiring for UPS Db's with 2x4.0sq.mm + 1x 1.5sq.mm stranded Cu. conductor (Finolex /Anchor /Skytone) to be laid in 19mm PVC pipe heavy duty/ Flexible pipe laid & concealed in wall/ floor/ panelling/ partitions or above false ceiling as per requirement. The rate should include the cost of all materials, labour, T&P, taxes & levies, scaffolding, shifting of furniture, carting away the debris and cleaning the floor etc.The job shall be	JOB	1		
G	Supply & fixing of 4nos. 6A switches & sockets (Modular type c/w MS/GI box & cover plate) complete with computer point circuit wiring with 2x2.5sq.mm + 1x 1sq.mm stranded Cu. Single core Copper conductor (Finolex/Anchor/RPG) to be laid in PVC conduit 1" dia/ vertical drops heavy duty laid & concealed in wall/ floor/ panelling/ partitions or above false ceiling as per requirement.	Per Node	8		
5	MAIN INCOMING PANEL & DISTRIBUTION				
A	SITC of 100A Kit kats fuse unit 3nos in wooden patra complete with 100Amp. Neutral link complete in all respect as required.	Set	1		

Sl.no	Description of items	Unit	Qty.	Rate	Amount
	1 No for Metre				
	1 no for Panel to Outer Side Of Wall (For Generator Connection)				
B	Main Incoming Panel				
	Supply, Installation, Testing & Commissioning of main distribution board panel fabricated of 18swg (powder coated) comprising of	Nos.	1		
	Indicator lamps 3 nos.				
	Voltmeter & ammeter(one each)				
	Rotary selector switches 2 nos for voltmeter & ammeter				
	Busbar (each of RYB +N) copper 100 amp each				
	125 Amp MCCB(Siemens/ L&T/ ABB/ Schnider) incoming 3P adjustable 25kA				
	Changeover TPN 100 amp for DG set (Havells/ ABB/ Sochomac)				
	Outgoing 63A 3P MCB's - 6 nos.				
	Outgoing 32Amp 2P MCB's - 6 nos.				
	Earth bus bar 25x5mm GI strip - 2nos. At the bottom.				
6	Supply Installation testing & commissioning of XLPE insulated Armoured Al.codutctor cable between main panel & DB's & generator of required thickness of approved make Skytone/ Havells based on the load assessment & confirmation of the same with architect. This rates include cost of lugs at both the ends				
	3.5 x50 sq.mm cable from Meter to Kit kat to the main panel & Pole (Approx - 20 mtr)	JOB	1		
	4c x20 sq.mm cable from Main Panel TO LHS DB (Approx - 20 mtr)	JOB	1		
	4c x 20 sq.mm cable from Main Panel to RHS DB (Approx - 20 mtr)	JOB	1		
	4c x 20 sq.mm cable from Main Panel to Kikat (Generator) (Approx - 40 mtr)	JOB	1		
7	Supply, installtion, testing & commissioning of VTPN Db double door with MCB as incomer IP 42 complete in all respects for AC, PP and L & F as under - Siemens/ Hager/ Lagrand/ ABB				
A	RHS 6way VTPN db - Loaction RHS wall opposite Cash cabins (From entrance to Rear record room & Toilet area) - Siemens				
	Incomer - 63A 3P MCB 10kA adjustable neutral to be directly connected to neutral bus	Each	1		
	3no. 32A 1P-MCBs 10 KA - AC's - 2nos. RHS & 1rear				
	3no. 16A 1P-MCBs 10 KA - for single power points - 2 cash & 1 May I help You & 2nos. D/W				
	4nos. 10A 1P-MCBs 10 KA for L&F				
	4os. 6A 1P-MCBs 10 KA for L&F				
	Blanking Plates - 2no.				
	All connections to be terminated thru lugs				
B	LHS 6way VTPN db - Loaction LHS wall behidn advance (From LHS LV Cash to Mgr Rm)- Siemens 8GB0406VRC or equivalent				
	Incomer - 63A 3P MCB 10kA adjustable neutral to be directly connected to neutral bus	Each	1		
	4o. 32A 1P-MCBs 10 KA - AC's - 3nos. LHS & 1 Mgr Rm				
	4no. 16A 1P-MCBs 10 KA - for single power points - (LV cash, 2 CRE, 1Advance, 2 MR & 2 Router)				
	2nos. 10A 1P-MCBs 10 KA for L&F				
	2os. 6A 1P-MCBs 10 KA for L&F				
	Blanking Plates - 2no.				
	All connections to be terminated thru lugs				

Sl.no	Description of items	Unit	Qty.	Rate	Amount
8	Glow sign Board - Circuit wiring with 2x2.5sq.mm + 1x 1.0sq.mm stranded Cu. conductor (Finolex/Anchor/Skytone) to be laid in 19 mm PVC pipe heavy duty laid & concealed in wall/ floor/ panelling/ partitions or above false ceiling as per requirement. The rates should include the cost of all materials, labour, T&P, taxes & levies, scaffolding, shifting of furniture, carting away the debris and cleaning the floor etc.The job shall be complete & to the entire satisfaction of the Bank.	JOB	1		
	<u>E -EARTHING</u>				
9	For Main Panel - S/burying of Dual pipe technology (Pipe in Pipe) earthing electrode having GI 80mm O/D pipe with 25 micron coating, 3metres long. The space between two pipes to be filled with Highly conductive & Non corrosive chemical compound. The installation shall be thru earth auger. The vacant space between pipe & hole shall also be filled with compound all around. The job also includes S/F of GI strip clamp with two holes (with SS/GI bolts & nuts) on the electrode & taking two earthing leads of 25 x 5 mm GI strip (Assumed length of 10m - beyond 10m to be paid extra) upto Main panel complete in all respects with guaranteed E/N voltage of less than 3 volts and resistance less than 1 ohms. The distance between two earthing pits to be 10ft or more INCLUDING Earth wire 4 sq mm copper wire . Approx -80 mtr (2 FOR BRANCH & 1 ATM)	Per Icn.	2		
10	<u>F - FIXTURES & FITTINGS</u>				
C	Supply installation testing and commissioning of 1*20watt Batten type tubular LED light fitting with LEDs, driver, diffuser, and housing complete in all respects in UPS room and record /wc/bath room /suitable place with complete in all respect with required color on need basis.	Each	22		
D	S/F of angle holder for bulbs including cost of 11w CFL lamp for Toilets	Each	10		
E	i) Supply & installation of wall bracket fan 450 MM (Heavy duty/ high speed) Make Bajaj/crompton greaves/havells/Orient (to be supplied after consultation with architect/Electrical Engineer as per approved drawing)	Each	5		
F	g) Supply & fixing of the 1200 mm 48") Sweep Ceiling fan (Orient PSPO/crompton greaves/havells) with downward rod(below false ceiling), canopy etc. including of PVC flexible copper wire.(white colour)(High speed) (Warranty Certificate is necessary)with downward rod, circular boxes, ball sockets, ceiling plates,suitable arm bracket etc. including connection with wire)White colour (WITH REGULATOR)	Each	12		
G	Supply & Fixing of fresh air fan 12" - Crompton Greaves/ Usha/ Khaitan/ Bajaj	Each	2		

Sl.no	Description of items	Unit	Qty.	Rate	Amount
A	Supply & Fixing of XL RJ 45 toolless information outlet with Duplex face plate with dual connectors Grey colour cat 6e including cost of supplying & laying CAT 6e (as directed by Architect from Server to Switch, Switch to computer I/O data socket as required complete in all respects) in 25mm dia rigid PVC conduit (including laying of GI draw wire complete with junction box, circular box, elbows, bends & other accessories as required by chase cutting on floor, wall, through partition or over false ceiling. The data cabling pipe should be laid at a minimum distance of 3ft from pipes laid down for power distribution) including interconnection with connectors as required complete in all respects.	Each	9		
B	Supply & fixing of 7ft Grey colour Patch chord Giga speed Systimax/ D link make	Each	9		
C	Supply & fixing of 3ft Grey colour Patch chord Giga speed Systimax/ D link make	Each	9		
D	S/F of 24Port Jack Panel fully loaded systimex make	Each	1		
E	S/F of 9 U wall mounted rack c/w fan etc as required	Each	1		
F	S/F of Cable Manager as required	Each	1		
		Total		B(Electrical Work)	
	GRAND TOTAL AMOUNT (gst extra)			(A+B)	

Sl. No.	Materials	Approved manufacturers / suppliers
1	Paint	I.C.I. (Dulex - Duco) / Asian paints / Goodlac Nerolac
2	Plywood	BWR- Century/Green/Archid only Premium quality
3	Wood preservative	BWR- Century/Green /Archid only Premium quality
4	False ceiling	Armstrong , Indian gypsum board
5	Laminates	Sunmica/ Archid/Century/Green 1mm thick as per bank approved color
6	Screws	G.K.W./Nettle fold
7	Adhesive	Fevicol SH
8	Night latch	Godrej
9	Locks	Godrej
10	Aluminium door frame	Jindal
11	Glass	Modi/Asahi/Saint Gobain
12	Aluminium cladding	Eurobond/Altobond/Alukbond
13	Key board drawer	EBCO
14	Telescopic CPU stand	EBCO
15	Cable organiser (wire manager)	EBCO
16	Vitrified tiles	Jhonsions Perlto
17	Venetion blind	Vista, Luxaflex
18	MCCB	MDS legrands, ABB, GE, SIEMENS
19	Changeover	Indo Asian/ HPL Socomec / GE/ Standard stangaurd
20	Distribution board	MDS / Standard / Indo Asian / HPL

Sl.no	Description of items	Unit	Qty.	Rate	Amount
21	MCB				MDS / Standard / Indo Asian / HPL
22	Cable				Gloster / Rallison / Incab / CCI
23	Copper wire				Finolex/anchor
24	Switch / Socket / Call bell and accessories				Anchor / Havells / CPL / MDS / Philips
25	Electrical Light Fittings / Fixtures Complete				Philips
26	Wall Fan / Ceiling Fan / Exhaust Fan				Khaitan/Havells

Note : Plywood mentioned in the drawings as well as in bill of quantities should be IS: 710 BWR- Century/Green only Premium quality.

Handwritten marks: A, 2, 00, and a circled mark.