

RO/PRAY/P&E/2022-23/50

Date:- 19.12.2022

TENDER FOR FURNISHING OF MISHIRPUR BRANCH

Baroda UP Bank Regional Office Allahabad, 3 D Tashkant Marg Civil Line, invites sealed tender for furnishing for our **Mishirpur** branch (Dist- Prayagraj) from the empanelled Furnishers of Baroda UP Bank, Head Office, Buddh Vihar Taramandal Gorakhpur-273016 (U.P).

1. Tender issuing date : 19.12.2022
2. Last date for submission of tender : 03.01.2022 at 4:00 PM
3. Date of opening of tender : 03.01.2022 at 5:00 PM
4. Contact Number : 9793138316
5. Tender to be address to : **The Regional Head
Baroda UP Bank,
Regional Office- Prayagraj, 3D Tashkant Marg Civil Line,
211001**

Terms and condition of tender:

- Ø Rates should be quoted on the space provided in **annexure attached only**. No other sheet/form should be used for quoting rates.
- Ø The competent authority (bank) does not bind themselves to accept the lowest or to give any reasons for its decision of acceptance or rejection of tenders.
- Ø Incomplete in any respect or conditional tender shall liable to be rejected.
- Ø Rates quoted only by bank's empanelled vendors will be consider/accepted.

Other conditions:

- Ø The registration number of the firm along with **GST no.** allotted by the authorities must be submitted.
- Ø **PAN NUMBER** of the firm allotted by the income tax authorities should be submitted (without which the vendor's bid would become invalid and shall be liable to reject)
- Ø Conditional tenders shall not be accepted on any ground and shall be rejected straight.
- Ø Any deviation of the conditions given by the purchaser will not be accepted and bid will be rejected without assigning any reasons.
- Ø If any clarification is required the same should be obtained before submitting the bid.
- Ø The entire document must be signed with the seal and attached as mark of acceptance of terms and condition.

Regional Office : 3 D Tashkant Marg Civil Line Allahabad 211001 (U.P.)
E-mail: roalla@barodauprrb.co.in; Fax-0532-2407653 Mo.7311121755,7311121764,

[Handwritten signature]

- Ø BUPB reserve the right to accept or reject any bid whole or in parts without assigning any reason thereof.
- Ø Bank's decision will be final and no correspondence will be entertained in this regard.
- Ø In case of delays in submission/non submission of bids ,Bank will not assume any responsibility.
- Ø Bank may reject any or all quotations without assigning any reason.

Tender submission:

Submission of tenders in sealed envelope super scribing "TENDER OF FURNISHING OF MISHIRPUR BRANCH" addressed to "The Regional Manager Baroda UP Bank, Regional Office- Prayagraj, 3D Tashkant Marg Civil Line; 211001", Complete in all respect latest by **4.00 PM dated- 03.01.2022** Tenders received after that shall not be entertained.

Tender must be submitted through hand to hand or through registered post.

Evaluation of tender:

Quoting incredibly low value of items with a view of subverting the tender process shall be rejected straight away.

Yours faithfully,

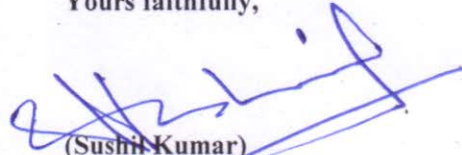
(Sushil Kumar)
Regional Head
Prayagraj - Region

Bharat and Associates.
Architects, Engineers, Interiors &
Landscape Designers,
Shop no-1, First Floor, Jeevan Plaza
Viram Khand-5, Gomti Nagar, Lucknow-226010
E-Mail: bharatandassociateslko@gmail.com

PROJECT - BOQ FOR FURNISHING WORKS.

BANK - BARODA UP BANK

BRANCH - MISHIRPUR

REGIONAL OFFICE PRAYAGRAJ

***ALL ITEM TO EXCLUSIVE OF TAXES . Taxes to Mentioned By the Contractor.**

***ALL WORKS TO BE DONE AS PER TENDER CONDITIONS.**

Laminate use only-Century, Green, Archid, Sunmica Aica (Other Laminate is not Acceptable)

S.NO	DESCRIPTION OF ITEM	QUANTIT	UNIT	RATE (Rs.)	AMOUNT (Rs.)
A.	FURNISHING WORKS				
1	Aluminum Section Door with Glass Aluminum entrance door with partition made of aluminum section of Hindalco/ Jindal 1.75"x1.75" and 1.5 m with 5mm thick glass with door made of door section 1.75" x 1.75" and door bottom 4.5"x1.75" (114mmx44mm) with 5mm glass complete with lock, door closures, tower bolt and handles etc.	130	SQFT		
2	Low /Full Height Wooden Partitions (partly glazed) and Flap Doors Providing and fixing of low height glazed Partition considered and above necessary ceiling supports to be provided) with Anodized Aluminium frame work, heavy sections (2mm thickness) of 2"x1.5" section, spacing of 2'0"x2'0" on bothsides and covered with 9mm thick BWR plywood finished with 1mm thick laminate of skirting & borders on both sides with necessary Pedilite SH adhesive, screws and bolts, etc; & above 8mm thk float glass with aproved quality and pattern frosted film, as per design Glass panel to be fixed with 19 X 32.5 mm teakwood beading around. Glass to be butt jointed and edges to be ground/machine polished to get a flush joint complete as directed and sealed with silicone sealent. Framework of partition is to be fixed to RC ceiling for support. All surfaces shall be treated with antitermite wood preservatives before covering up complete as per directions and approval. The job shall also include for provision of laying conduits, switch boxes etc. The erection of partition shall include for expansion bolts cleats, clamps bolts, nuts, screws, rivets and other accessories, all complete up to the satisfaction of the Architect. All door opening shall have rebated teak wood framework (size - 75mm x 50mm, as per profile) on vertical (2 Nos.) and horizontal (1 No.) sides, with melamine finish and rebate of 40mm x 12mm, all complete up to the satisfaction of the Architect.				

	the partition and doors shall have hinges floor springs/sliding arrangement/hydraulic door closer, mortise locks (Godrej make all), etc. The rate shall include cost of all materials, labour, T&P, wastages, etc. required for proper completion of work, all complete to the satisfaction of the Architect.	290.00	Sq.Ft		
	Partition to have 1.00 mm high Laminates at skirting on both sides of partition.				
3	CASH CABIN PARTITION(HT-7' ONLY)				
	Providing and fixing of wooden partitions made out of 2"x1-1/2" Aluminium frame work under framing for horizontal (at 0mm, 75mm, 750mm, 900mm, 1200mm, 2100mm and 2550mm and ceiling levels) & vertical (at 600mm c/c approx.) divisions or as per site conditions. It shall be covered with 9mm thick water proof ply with 1mm thick laminate, (from 0mm to 1200mm and 2100mm to 2550 mm/ceiling levels) on both sides. The design shall have 6mm x 4mm grooves (horizontal or vertical) at various levels, as suggested by the Architect				
	It shall have decorative aluminium grill (from 1200mm to 2100mm) fixed with teak wood beading (size - 30mm x 20mm, as per profile) with melamine finish. The job shall also include for provision of laying conduits, switch boxes etc. The erection of partition shall include for expansion bolts cleats, clamps bolts, nuts, screws, rivets and other accessories, all complete up to the satisfaction of the Architect.All door opening shall have rebated teak wood framework (size - 75mm x 50mm, as per profile) on vertical (2 Nos.)				
	and horizontal (1 No.) sides, with melamine finish and rebate of 40mm x 12mm, all complete up to the satisfaction of the Architect.It shall also include for door shutters, as per required width and 2100mm high. It shall be made out of 75mm x 25mm, kail/partal wood (with anti-termite) under framing for styles, top, middle and 100mm x 25mm for bottom rail. It shall be covered with 6mm thick water proof ply with 1mm thick laminate, (from 0mm to 900mm and other under frames) in shade and pattern approved by the Architect, on both sides.				
	The design shall have 6mm x 4mm grooves (horizontal or vertical) at various levels, as suggested by the Architect. It shall also have aluminium grill (from 900mm to 2025mm) fixed with teak wood beading (size - 20mm x 20mm, as per profile) with melamine finish. Door shutters shall have teak wood edging (size - 40mm x 10mm, as per profile) on all sides, with melamine finish. Each shutter shall have hinges floor springs/sliding arrangement/hydraulic door closer (heavy duty), mortise locks, etc. The rate shall include cost of all materials, labour, T&P, wastages, etc. required for proper completion of work, all complete to the satisfaction of the Architect.	160.00	Sq.Ft		
4	Glass Barrier on cash cabin and front glass for counter(12 MM NECESSARY)	45.00	Sq.Ft		



	Providing and fixing glass barrier (as per profile and design) in front of cash and ledger counter made out of 12mm thick polished edged float glass (Make – Modi guard or equivalent). It shall have 25mm x 20mm teakwood beading (as/shape approved by the Architect) to hold the glass from sides and top (optional). All teak wood surfaces shall be melamine polished. The rates shall include for cutting (in geometrical shape) and polishing the edges, all complete to the satisfaction of the Architect.				
5	Computerised Ledger & Cash Counter				
	Providing and placing in position ledger counter with top, vertical sides/dividers, skirting and fascia made out of 19mm thick water proof board with 1mm thick laminate (as/shade approved by the Architect) on all exposed surfaces. It shall also have 75mm x 40mm teak wood runners below the top and for footrest below. Every unit shall be provided with a side unit (size - W-500mm, H-750mm, D-500mm approx.), consisting of 150 mm deep drawer at top and a cabinet with open able/hinged shutter below.				
	. The fascia of drawer and shutter of cabinet below shall be made out 19mm thick water proof board with 1mm thick laminate (as/shade approved by the Architect) and sides and bottom of drawer shall be made out of 12mm thick water proof ply. The side unit shall have CAM locks, handles, guides, sliding units, hinges, magnetic catcher's etc. of approved make. Every unit shall be provided with a keyboard drawer unit (size - W-550mm, H-100mm, D-300mm approx.) below. The counter shall have 100mm deep fascia, below the top, in which keyboard drawer unit shall be adjusted.				
	It shall be made out 19mm thick water proof board with 1mm thick laminate (as/shade approved by the Architect) and sides and bottom of drawer shall be made out of 12mm thick water proof ply. The unit shall have CAM locks, handles, guides, sliding units etc. of approved make. The job shall include for 6mm x 6mm grooves in between sides and open able drawers and hinged shutters. All the exposed edges of water proof board and ply shall be provided with 6mm thick teak wood/hard wood lipping. All teak wood surfaces shall be melamine polished and other internal surfaces shall be painted with two coats of synthetic enamel over one coat of primer, all complete to the satisfaction of the Architect.				
A	High Level	5.00	Rg.Ft		
	High level (two levels) Computerised cash counter.				
	Lower level top shall be 900mm wide and at 750mm level from floor & upper level top shall be 250mm wide (and at 1150 mm level from floor				
B	Low Level	10.00	Rg.Ft		
	Low level (two levels) Computerised ledger counter.				
	Lower level top shall be 900mm wide and at 750mm level from floor & upper level top shall be 150mm wide and at 900mm level from floor				
6	Tables				

340/24

A	BM TABLE Table with Side credenza(Side Table) include the 12 mm thick glass (6 X3 X2'-6")	1.00	No.		
	Providing and placing in position tables with top, vertical sides/dividers, skirting and modesty panel made out of 19mm thick Premium Board (Green /Century) with 1mm thick laminate (as/shade approved by the Architect) on all exposed surfaces. It shall also have 75mm x 40mm teak wood runners below the top and for footrest below. Every table shall be provided with a side unit (size - W-500mm, H-750mm, D-500mm approx.), consisting of 150 mm deep drawer at top and a cabinet with open able/hinged shutter below.				
	The facia of drawer and shutter of cabinet below shall be made out 19mm thick Premium Board (Green /Century) with 1mm thick laminate (as/shade approved by the Architect) and sides and bottom of drawer shall be made out of 12mm thick Premium Board (Green /Century). The side unit shall have CAM locks, handles, guides, sliding units, hinges, magnetic catcher's etc. of approved make. Every table shall be provided with a keyboard drawer unit (size - W-550mm, H-100mm, D-300mm approx.) below. The table shall have 100mm deep facia, below the top, in which keyboard drawer unit shall be adjusted. It shall be made out 19mm thick water proof board with 1mm thick laminate (as/shade approved by the Architect) and sides and bottom of drawer shall be made out of 12mm Premium ply (Green /Century). The unit shall have CAM locks, handles, guides, sliding units etc. of approved make.				
	The job shall include for 6mm x 6mm grooves in between sides and open able drawers and hinged shutters. All the exposed edges of Premium Board (Green /Century) and ply shall be provided with 6mm thick teak wood/hard wood lipping. All teak wood surfaces shall be melamine polished and other internal surfaces shall be painted with two coats of synthetic enamel over one coat of primer, all complete to the satisfaction of the Architect. Every table top shall be provided with 10 mm thick float glass (as per profile) with polished and beveled (25mm wide) edges all complete to the satisfaction of the Architect.				
B	Officer Table size 4'-6"x 2'-6"x 2'-6" With Side Table & 12 mm Thick Glass	1.00	No.		
	SPECIFICATION AS PER MANAGER TABLE(PART -A)				
7	Column & wall Panelling (As per Direction BY Architect)	310.00	Sq.Ft.		
	Providing & fixing in position 2"x2" Aluminium frame work and finished with 9 mm thk. Premium Board (Green /Century, Archid) on both sides with 1.0 mm thk. Laminate on top as per instruction of the Architect.				
8	Low /full height Storage Racks				
	S1-Storage (Low Height)				
	Size- 6' Length X 2'-6" high X 1'-4" deep				
	Ply Wood-19.0mm Premium Board (Green /Century) for side top and door & back 12.0mm thick Premium Ply with shutters, shelf 19.0mm Premium Board (Green /Century)				

34C/24

	Shelf-19.0mm thick Premium Board (Green /Century)				
	Handle-Brush finish stainless steel				
	Lock-Vijayan/Godrej				
	All internal & rear surfaces to be painted with two coats of enamel paint over a coat of primer / putty as directed to get a smooth finish.All instructed by Bank's Engineer/Architect.	110.00	sqft		
9	Complaint & Suggestion Box	2.00	No.		
	Providing and fixing in position complaints/suggestion box (as per design) with hinged shutter of size - 450mm x 600mm x 150mm made out of 19mm thick water proof board with 1mm thick laminate (as per shade approved by the architect) on all exposed surfaces. It shall have 6mm thick water proof plywood on the back.				
	.The hinged shutter shall be made out of teakwood (section - 25mm x 50mm) framework, with 4mm thick float glass, fixed with teakwood (size - 12mm x 12mm) beading. The unit shall have cam locks, handles, spring hinges, magnetic catchers etc. of approved make. All the exposed edges of water proof board or ply shall be provided with 6mm thick teak wood/hard wood lipping. All teak wood surfaces shall be melamine polished and other internal surfaces shall be painted with two coats of synthetic enamel over one coat of primer, all complete to the satisfaction of the Architect.				
10	Notice Board	1.00	No.		
	Providing and fixing in position notice board (as per design) of size - 900mm x 600mm x 150mm. The sides shall be made out of 19mm thick Premium Board (Green /Century) with 1mm thick laminate (as per shade approved by the architect) on all exposed surfaces.It shall have 12mm thick tack The front shall have 6mm thick float glass sliding shutter in two parts.				
	It shall also have 19mm wide two track aluminium channel for sliding arrangement, all around, along with locking arrangement.board (Make - Cellotex or equivalent) wrapped with stretched blazer cloth (Make- Raymonds), of Rs. 200.00 per Mt. (approx.) in colour and pattern approved by the Architect. It shall be fixed with help of kail/partal wood (sect. 19mm x 25mm) frame work. It shall be covered with 6mm thick Premium ply (Green /Century), on the back. All the exposed edges of water proof board and ply shall be provided with 6mm thick teak wood/hard wood lipping. All teak wood surfaces shall be melamine polished and other internal surfaces shall be painted with two coats of synthetic enamel over one coat of primer, all complete to the satisfaction of the Architect.				
11	ACP PANNELING IN SHUTTER BOXING	225.00	sqft		
	Frame Work-2" X 2" X 1.5 mm thick Aluminum Tubular section (Horizontal/Vertical) Jindal /Alstrong Make, Aluminum Composite Panel- 3.0 mm thick of approved colour with bonding material				
12	Main Panel Boxing	55	Sqft		

	Providing & fixing in position with Anodized Aluminium frame work, heavy sections (2mm thickness) of 2"x1.5" section, spacing of 2'0"x2'0" on bothsides and covered with 9mm thick bison board finished with 1mm thick laminate & Inner Side of Storage Paste 1.5 Thick Aluminium Tubular Section of Approved Colour Pattern . Front Side of Storage Loovers/Aluminum Jali for Ventilation of the Panel & the Measurement of the Storage only front Facia of the Storage (Lenth x Height) . All work Complete to the Satisfaction of the Bank /Architect .				
13	Public settee size 60"x 18"x18" Teak wood ,19 mm thick board, 1.00 mm thick mica GL/VL teak wood beeding including cost of all material, labour tools and plant etc. with 3" foam sleep well 32 density and covering cloth of superior quality.	Per Piece	2		
14	Public Writing Table- (Size 36"x24x42") Teak wood ,19 mm board, 1.00 mm thick mica GL/VL teak wood beeding including cost of all material, labour tools and plant etc.	Per Piece	1		
	Total				
	GST TAX EXTRA (18%)				



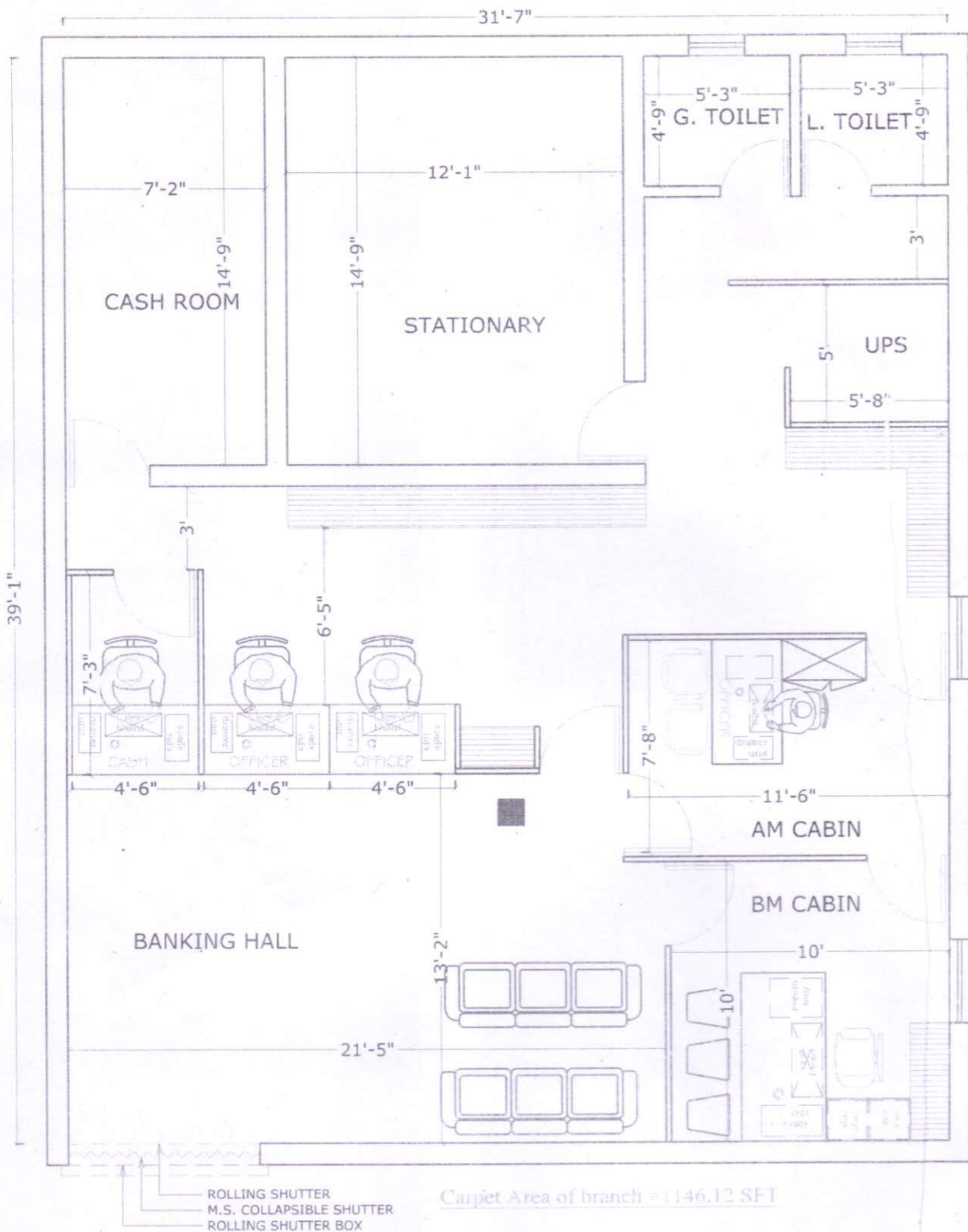

PROJECT:
 PROPOSED LAYOUT PLAN
 FOR BGUP MISHIRPUR
 BRANCH PRAYAGRAJ

DATE:
 15.12.2022

BHARAT & ASSOCIATES
 5, Tagore Town Bhojubir
 varanasi
 Ph.0542-2505982
 M. 9415221355