



बड़ौदा यू.पी. बैंक
Baroda U.P. Bank

SHORT TERM TENDER NOTICE

(For Empanelled Furnishers and Interior Decorators)

FURNISHING WORKS FOR ANNAWA BRANCH REGION-AYODHYA

IMPORTANT DATES

DATE OF ISSUE OF TENDER	05.11.2024
LAST DATE AND TIME OF SUBMISSION OF TENDER	14.11.2024 up to 04:00 PM
DATE OF OPENING OF TENDER (FINANCIAL BID)	16.11.2024 at 04:00 PM

Baroda U.P. Bank
Premises and Equipment Department
Regional Office Ayodhya
Baldev Niwas Compound, Acharya Narendra Dev Road Ayodhya-224001

Regional Manager

Date: 05.11.2024



NOTICE INVITING TENDER

Sealed item rates short term tenders are invited on behalf of the Regional Manager, Baroda UP Bank, from the Furnishers & Interior Decorators having valid Empanelment with the Baroda UP Bank for the work of FURNISHING WORKS of ANNAWA Branch District-Ambedkarnagar.

1. Issue of tender documents: 05.11.2024 to 14.11.2024 up to 04:00 PM

2 Last date of receipt of tender documents: 14.11.2024 up to 4.00 PM.

3 Date of opening of tender documents: 16.11.2024 at 4.30 PM.

4 Place of submission & opening of tender: Baroda. U.P. Bank, Regional Office Ayodhya.

5. Name of Architect: Gunjan and Associates (Mob: 9838818489)

6. Period for completion of work from order date: Maximum 30 days.

7. Retention percentage: 10% (Ten percent) from final bill.

8. Defect liability period: 12 months from the date of completion certificate issued by the Bank Architect.

9. Release of retention money: After 14 days from defect liability period.

10. Commencement of work: Within 7 days of issue of work order.

12. Period Of Completion: 30 days from the date of issue of work order (A penalty of Rs100/day will be imposed for further delay).

SUBMISSION OF TENDER

The tenders are to be submitted in a sealed envelope and clearly superscribed as

"Tender for FURNISHING AND ELECTRICAL WORKS of ANNAWA" branch and to be submitted at Baroda U.P. Bank, Regional Office, Baldev Niwas Compound, Acharya Narendradev Road, Ayodhya- 224001 (U.P.)

ENVELOPE TO BE CONTAINED

Envelope shall contain the priced Tender Volume

GENERAL INSTRUCTIONS TO TENDERERS

- 1 The term "Employers" or "Bank "shall mean "Baroda U.P. Bank, or its authorized representatives at Baroda U.P. Bank, Regional Office Ayodhya, District-Ayodhya.
2. The term "Architect shall mean "M/s Gunjan and Associates who is the Architect Consultant to the Employer for this project & having office at 141. Sainik Nagar, Raibareilly Road, Lucknow-226002 or its authorized representatives.
3. The term "Contractor" shall mean the successful tenderer to whom the Contract shall be awarded.
4. The "Works" shall mean the "FURNISHING AND ELECTRICAL WORKS AT ANNAWA BRANCH REGION-AYODHYA, DISTRICT-AMBEDKARNAGAR
5. The Contractor should quote the rates in figures and words. Any corrections or Overwriting should be initialed by the Contractor.
6. The Contractor should submit the tenders with seal, signature and date on each Page.
7. The Contractors should submit the cost of the main items as per tender specifications. Further modification after awarding of the contract shall be not allowed unless there is specific instruction by the Bank/Architect to change specifications.
8. The contract is time-bound and the works are to be completed within the time limit specified in the notice inviting tenders. This is a working office and the contractor has to work with no or minimum obstruction to its regular services.
9. The decision of Employer and the Architect is final and binding.

TERMS & CONDITIONS

1. Unless otherwise mentioned, all works are with no allowance for Lapse waste. Unless otherwise described or measured separately, price for all the items shall include all necessary straight & curved edges.
2. Any damage to the work before the site is handed over, is to be replaced or made good at the expense of the contractor to the entire satisfaction of the Architect/Bank.
- 3 Income Tax, Other Tax as applicable shall be deducted at source as per the Income Tax Act/Rules.
4. The quantities indicated are subject to change. The payment of the bill shall be made as per the actual measurement as certified by the architect but not exceeding the total value quoted in the tender form.
5. The Architect or any officer of the Employers will be free to inspect the work at the site during the period of execution any suggestion of change or modification to improve the quality of work will be carried out subject to prior approval of the competent authority of the employers and that of the Architect.
6. In case of failure to take up the work even after accepting the work order, or leaving the work incomplete, or for defective work not rectified, or violation of the terms and conditions, the contractor will be de-panel/blacklisted.
7. For any item of work not covered or any unforeseen items of work, payment will be made according to the rates approved for similar nature of work, the costing done by the Architect, as per current PWD schedule of rates, or as per analysis of material cost,
8. The tenderers shall sign each & every page of the tender documents including the drawings attached here to.
9. The amount is to be quoted in figures as well as in words. In case the rates quoted in words and in figures are in variance, the amount written in words shall be taken as final.
10. The Contractor shall make their own arrangement at their own cost for storing materials, plants, tools etc. The employers will not be liable for security of the Contractor's materials.
11. No tools or plants will be issued by the bank.
12. The Employer / Architect reserves the right to accept or reject any tender without assigning any reason whatsoever and the said decision shall be final and binding upon the tenderer.
13. In case of breach of contract by the Contractor for slow progress of works or any other claim of damage, the Employer or the Architect may have the power to rescind the contract

without furnishing further reasons thereof.

14. The Architect shall have the power to ask the contractor to furnish the sample/ colour / test certificate from any Govt. /Authorized agent for any materials used/ to be used in the Works, the expenditure of which is to be borne by the Contractor.

15. The Employer shall be not be liable for any damages or compensation payable as a consequence of any accident or injury to any workman or other persons in the employment of the Contractor or any sub-contractor.

16. On completion of the Works, all rubbish, debris, materials, tools, Labourers, etc. to be removed by the contractor from the site and the contractor will hand over the site clean & clear & in usable condition within 3 days of completion of the works. Failing this, the employer may dispose the materials at the cost of the contractor.

17. In case of any dispute, the matter will be referred to the General Manager, Baroda U.P. Bank, Head Office Taramandal, Gorakhpur(UP).

18. Final Payment after completion of Project will be done with the certificate of Architect with deduction of retention money by the Bank.

19. The rates quoted in the tender shall exclude GST but include all excise tax, octroi & other taxes, no escalation of rates will be allowed under any circumstances.

20. If the work is not completed within the stipulated time, a penalty of Rs 100/- per day will be imposed till the completion of works.

ARCHITECT

Gunjan And Associates
141, Sainik Nagar, Raibareilly Road
Lucknow-226002

Gunjan and Associates
Architects, Engineers, Interiors
& Landscape Designers

141, Sainik Nagar, Raebareilly Road, Lucknow-226002

Phone: 0522-3553324, 9839018489, 9838818489

E-mail: studio@gunjanandassociates.com

URL: www.gunjanandassociates.com

BOQ FOR ELECTRICAL WORK AT BARODA UP BANK, ANNAWA, REGIONAL OFFICE FAIZABAD

S.NO.	DESCRIPTION OF ITEM	QTY	UNIT	RATE	AMOUNT
1	SITC of 100Amp Kit kat Fuse unit 3 nos with 100 Amp neutral link on wooden board (3' x 3') complete with connections (new).	1.00	Set		
2	ELECTRICAL PANEL				
	Design, manufacture, providing, storing & installing in position, effecting proper connection, testing and commissioning of panel made of 14 SWG, CRCA sheet steel. It shall be dust and vermin proof. It shall have compartmentalized construction with bus bar chambers, cable alley, cable glands plate etc. as required, duly painted from inside as well outside.				
	It shall have followings 1 No. 100 Amp. TPN, MCCB (10 KA breaking capacity), Busbars.100 Amp., 3 phase, 4 strips, 415 volts, 50 Hz. copper busbars with colour coded PVC heat shrinkable sleeves. Instruments. Multi function Meter for Voltage, Ampere, Power factor, KWH, Data 1 No. with CT 75/5				
2	Outgoing. 3 Nos. 63 Amp. 4P MCB (Power AC DB, Branch UPS DB and One Spare) 2 Nos. 25 Amp. 4P MCB (For Light/Fan DB & Spare Feeder) 10 AMP DP MCB. 3 Nos (for Glow Sign board, 1 spare and Strong Room Lighting) 1 No., 100 Amp. Four Pole Change Over for D.G. Set. (Seperate from the panel)The design of panel should be got approved by the Architect before manufacturing.The job shall be completed, to the satisfaction of the Bank Engineer/Architect. Any deviation in specification/distribution shall be viewed seriously.	1.00	Set		
2a	Change over outside Panel - S/F of 100A TPN changeover in SS enclosure	1.00	Nos.		
3	UPS I/P, O/P AND DISTRIBUTION				
a.	SITC of 40/ <u>32 AMP</u> 2P industrial socket along with DPMCB for UPS & Inverter I/P	2.00	Nos.		
b.	SITC of 32AMP 2P industrial socket along with MCB for UPS & Inverter O/P	2.00	Nos.		
c.	SITC of 12 WAY SPN DB Double Door (1 No. 40 AMP DP MCB and 10 NOS. 6-10 AMP SPMCB) (Branch UPS Power Distribution for UPS Points at 1 Manager Cabin (2nos.), Router (2nos.) and Staff counters (3nos.). Two adjacent computer nodes can be controlled thru one MCB	1.00	Nos.		
d.	SITC of 4 WAY SPN DB Double Door (1 No. 32 AMP FP MCB for UPS supply	1.00	Nos.		
e.	SITC of 63Amp Rotary Phase selector switch complete with RYB indication lift in incloser complete in all respects as required. (Branch UPS) Salzer	2.00	Nos.		
4	RAW POWER & FAN, LIGHTING DB & AC DISTRIBUTION BOARD				
a.	4 WAY TPN DB Double Door (1 No. 20 AMP TP MCB and 12 Nos. 6-10 AMP. SPMCB in each outgoing circuit for Light, Fan & 6A Socket 16A Power Points.) all complete.	1.00	Nos.		
5	CABLES				

a	SITC of 4 Core 16 Sq.mm Aluminium Armoured Cable (From Electric Meter to Electric Panel), complete with end termination and all respect as required.	25.00	Mtr.		
b.	SITC of 4 x 6.0 Sq.mm Copper Wire + 1 x 4.0 Sqmm Copper Earth Wire (Panel to UPS Incomer, LDP) in PVC Pipe fixing on walls or chassing the walls and making it good with cement mortar of 1:5 ratio and painting compete with end termination/lugs and in all respect as required.	45.00	Mtr.		
c.	SITC of 4 x 10.00 Copper Wire + 1 x 4.0 Sqmm Copper Earth Wire (Kit Kat fuse unit/ Main Panel to AC / POWER DB) in PVC Pipe fixing on walls or chassing the walls and making it good with cement mortar of 1:5 ratio and painting compete with end termination/lugs and in all respect as required.	35.00	Mtr.		
d.	SITC of 2 x 6.0 Sq.mm Copper Wire + 1 x 2.5 Sqmm Copper Earth Wire (Rotary Switch to UPS and UPS to UPS DB) in PVC Pipe fixing on walls or chassing the walls and making it good with cement mortar of 1:5 ratio and painting compete with end termination/lugs and in all respect as required.	25.00	Mtr.		
e.	SITC of 2 x 2.5 Sq.mm Copper Wire + 1 x 2.5 Sqmm Copper Earth Wire (Electric Panel Glow Sign Board) in PVC Pipe fixing on walls or chassing the walls and making it good with cement mortar of 1:5 ratio and painting compete with end termination/lugs and in all respect as required.	15.00	Mtr.		
6	EARTHING				
a.	PIP technology GEL type 50mmdia 3000mm long earth electrod. One Earthing for Neutral grounding, One earthing for Panel body grounding, One earthing for UPS body grounding, One for UPS output	2.00	Nos.		
b.	12 SWG Bare Copper Earth Wire from earthing pit /Earth terminal to load point (UPS DB and Main DB etc)	45.00	Mtr.		
7	UPS POINT				
a	Supply & Installation of point wiring for Primary UPS or stabilized power plug points on workstations / table for computers using 3 x 1.5 Sq.mm copper conductor multi starnd FR PVC sheathed flexible wire pulled through floor raceways/conduit and taken upto table top using PVC rigid or flexible conduits run within wooden/metal partitions. Each point consisting of 2 nos of 10A 3 pin sockets, 1 nos 16A 2/3 pin sockets, 1 nos 16A Switch (Modular) & 1 nos indicator, wired together forming one point. The earth wire of green color only. No secondary UPS Points to be made.	7.00	Nos.		
8	RAW POWER POINT 16A SOCKET POINT IN WALL ONLY				
a.	Supply & Installation of point wiring for Primary Raw power plug points on walls only for computers using 2X4+1X2.5 Sq.mm copper conductor PVC sheathed flexible wire pulled through already laid floor raceways and taken upto table top using PVC rigid or flexible conduits run within wooden/metal partitions. Each point consisting of 2 nos of 16A 2/3/5 pin socket & 2 nos 16A Switch (Modular), wired together forming one point. The earth wire of green color only. No secondary Points to be made.	10.00	Nos.		
9	LIGHT/FAN POINT				
	Supply & Installation of concealed point wiring using 600v grade 1.5 Sq.mm copper conductor PVC insulated wires (with proper R,Y,B color code) pulled through heavy gauge PVC conduits laid concealed over false ceiling including 2 Nos. 2.5 sqmm circuit wires from the relevant DB and also including 2.5 sqmm green color copper earth wire and switch plate, switches, etc. as approved by the Bank's Engineer/Architect.				
a.	Primary light points including the cost of 10 A modular switch		Nos.		

b.	Ceiling Fan Point including the cost of 10A modular Switch along with 4/5 step electronic fan regulator.	7.00	Nos.		
c.	Wall Fan Point along with 10 AMP modular switch	7.00	Nos.		
d.	Exhaust Fan Point along with 10 AMP modular switch	3.00	Nos.		
e.	6/10A Switch with 5pin 10A socket in counter, light & fan board	6.00	Nos.		
10	DATA CABLING & POINT THERE MUST BE MINIMUM 3FEET DISTANCE BETWEEN DATA AND				
	Supplying and laying of D-Link make CAT-6 (UTP) cable through trenches / conduits.				
a.	Supplying and laying D-link make CAT-6 Cable complete with CAT-6 information outlet with plate & surface Box at individual Tables	7.00	Nos.		
b.	Supplying and fixing of 2 mtr long crimped patch cord	7.00	Nos.		
c.	Supplying and fixing of 1 Mtr long crimped patch cord	7.00	No.		
d.	S/F of 24 Port Patch Panel complete in all respects	1.00	Each		
	Patch Panel- Brocade/ Cisco/ DigiLink/ 3 Com/ Nortel/ Foundary/ D- Link				
e.	S/F of 24 Port switch complete in all respects	1.00	Each		
	Switch- Brocade/ Cisco/ DigiLink/ 3 Com/ Nortel/ Foundary/ D- Link				
f.	Supply & Fixing of wall mounted rack 9U with glass perforated front door and removable rear locking door, Mounting Hardware pack, Fan assembly - Cable entry from rear complete in all respects	1.00	Each		
	Racks- Com Rack/ HCL/ Val Rack/ APW President				
g.	Supply & fixing of 1U - PVC cable Manager with cover	1.00	Each		
	Cable Manager - Krone/ Pouyet/ TVS				
12	FIXTURES				
	SITC of following fixtures as per make list				
a	LED Tube Light Patti Type (white) - 18 Watts Make/ Brand as per MAKE LIST	27.00	Nos.		
c	Ceiling Fan - 900mm Make/ Brand as per MAKE LIST	7.00	Nos.		
d	Wall Mounted 80/100 watt plastic body Fan - 450mm, 1300 to 1500RPM Make/ Brand as per MAKE LIST	7.00	Nos.		
e	Exhaust Fan Metal Body - 300mm Make/ Brand as per MAKE LIST	3.00	Nos.		
f	Call Bell Wireless	1.00	No.		
g	S/F of Holder with 8w LED bulb	2.00	Nos.		
	TOTAL (excl. GST) (Rs.)				
Note: All rates are excluding G.S.T.					
For GUNJAN & ASSOCIATES  (AR. GUNJAN KAPUR) PROPRIETOR					
Ar. Gunjan Kapur					
For M/s Gunjan & Associates					

Gunjan and Associates.

**Architects, Engineers, Interiors &
Landscape Designers,**

141, Sainik Nagar, Lane-9,

Raibareli Road Lucknow-226002.

Phone: 0522-3553324, 9839018489

E-Mail: arunjan@yahoo.com

studio@gunjanandassociates.com

Website: www.gunjanandassociates.com

BARODA U.P. BANK

LIST OF MATERIALS OF APPROVED BRAND AND/OR MANUFACTURER

1. The contractor shall use materials in their work subject to inspection, prior to dispatch, by Owner or his authorized representative of any materials not otherwise specified, shall be in Accordance with the following list. All materials not otherwise specified shall be in accordance With the latest Indian Standard Specifications, where such exists with prior approval of Owner /Architects. The contractor shall be bound to offer sample of materials, which are claimed to be conforming to I.S Specification, for testing at an approved testing laboratory.
2. Contactor shall purchase all materials from the makers or their authorized stockist only. Necessary documentary evidences must be produced to the Owner or their authorized Representative on demand.
3. Contractor shall be bound to supply items or any make of the items as per the choice of the Owner/ Architects.

A CIVIL / FURNISHING WORK

S.No	Description	Approved Brand/ Manufacturer
1.	Cement	M/s ACC, M/sPrism ,M/s Jaypee
2.	Wood	First class Steam beach wood or as specified
3.	Polish	MRF Polyurethane
4.	Termite treatment	Chloroporyphos 20% concentration / Dusban /Terminator pidlrite make
5.	Soft Board	Celotex
6.	Flase Ceiling and Sections	Grid Tiles ---Armstrong, St Gobain Gypsum India,
7.	Aluminium sections	Hindalco, Jindal, Indal
8.	Vitrified Floor tiles	RAK Asian, Regent, Kazaria, nitco
9.	Block boards / Plywood/Flush doors	M/s Green, Duro , M/s Archid, M/s Century, CorbetT MR Grade alternate brands from the same manufacturer allowed
10.	Laminates	M/s Green, lam (New Mika),M/s Merino, , M/s Century, M/s AEROLAM/Archid
11.	Hardware-(Aluminium)	Approved design, brand, quality & manufacture allowed
12.	Hardware	ALL HARDWARE TO ONLY GODREJ
13.	Drawer/ cabinet Handless/locks	Dorset / Kitch/ Godrej/ hettich
14.	Magnet Catcher	Supreme, Excel
15.	Drawer / cabinet shutter Accessories	Ebbco, Hettich
16.	Synthetic Enamel Paints, Distemper or Plastic paint Best quality of make as approved	Asian Paints Ltd), Berger Paints (India) Ltd.(Luxol), ICI, Nerolac.
17.	Venetian blinds/ verticals	vista
18.	Glazing	M/s Modiguard, M/s asahi india, Saint Gobain.
19.	Door Closer/ floor spring	Godrej, Dorma, Ozone
20.	Glue Addhesive	Fevicole, Century
21.	Door handles/ Locks	Godrej
22.	Screw	Excel GKW

23.	Glass brass bracket	Flora, Perfect
24.	POP bag or readymade work	Diamond (Super fine quality)
25.	GI section for Partitions, Panel, false ceiling	Same Company as of Gypsum Bard or Mineral Fibre tiles
26.	Film	Alkor, Garware, 3M
27.	Plants	
28.	Wire management holes	Twinkle
29.	Cement Board	E board, Bison,
30.	Vitrified floor tiles adhesive / Grout	Bal Endura, Dr. Fixit Fevimate XL with Polymer Modified Mortar, ROFF Granite tile adhesive
31.	Texture	Spectrum , Heritage, Acro paint
32.	Upholstery	Raymonds
33.	Sanitary Fixtures	Cera, Hindware, Parryware
34.	GI Pipes and accessories	TATA
35.	CI Pipes and accessories	NECO
36.	Plumbing Fittings	Jaquar Continental series
37.	Ceramic Tiles	Kajaria (High Lighter Concept)
38.	Chairs / Sofa	Godrej, Delite / Debo
BARODA U.P. BANK		
<u>LIST OF MATERIALS OF APPROVED BRAND AND/OR MANUFACTURER</u>		
ELECTRICAL		
1.	MCCB	MDS legrands, ABB, GE, SIEMENS
2.	Changeover	Indo Asian/ HPL Socomec / GE/ Standard stangaurd
3.	Distribution board	MDS / Standard / Indo Asian / HPL
4.	MCB	MDS / Standard / Indo Asian / HPL
5.	Cable	Gloster / Rallison / Incab / CCI
6.	Copper wire	Rallison / Finolex / Polycab / R.R. Cable
7.	Switch / Socket / Call bell and accessories	Anchor / Havells / CPL / MDS / Philips / Simon
8.	Electrical Light Fittings / Fixtures Complete	Philips
9.	Wall Fan / Ceiling Fan / Exhaust Fan	Khaitan//Bajaj

NOTE: In case any make is mentioned in bill of quantity, it will take precedence over those given in the Given in the "Acceptable Makes of Materials" above.

The choice of make at a specific site will have to be consent with the project architect.

Gunjan and Associates
Architects, Engineers, Interiors
& Landscape Designers
 141, Sainik Nagar, Raibareilly Road, Lucknow-226002
 Phone: 0522-3553324, 9839018489, 9838818489
 E-mail: studio@gunjanandassociates.com
 URL: www.gunjanandassociates.com

Bill of Quantity for Furnishing works for Baroda U.P. Bank

Branch at Annawa

Region - Faizabad

- 1.No offsite prefabrication shall be allowed in any case. All fabrication shall be done at the site after getting the materials inspected by the architect
- 2.No payment shall be made for any in completed or unsatisfactory work
- 3.The Contractor should strictly follow the Booklet requirements of the Bank including the detailed drawings in the booklet. Any discrepancy between the booklet and the Specifications below should be brought to the notice of the Architect.
4. List of material to be strictly as per the booklet.
5. Cable Managers to be provided in the tables and Counters wherever required.
- 6. All underframe should be properly treated with antitermite and waterproofing material**
7. All Locks in the drawers and doorsets should be of Godrej
8. All keyboard Trays and Drawers to be on Channel Sliding Mechanism.
- *The contractor to follow the banks colour Coding. Any other specified colour to be superceded by the Banks Colour code.**
- *All board to be BWP. Of approved brand and if written BWR it should be superceded by BWP board/ply.**

S.No.	Description of item	Unit	Qty.	Rate	Amount
1	Branch Manager Table with Side Table.	NOS.	1.00		
	Size -5'-6" (L) X 2'-6" (W) X2'-6" (H) Providing and placing in position table made of phenol bonded 19mm thick commercial board with top front and sides finished in 1.0 mm Thick laminate and 12mm thick toughened glass on top . The front facade of the table to have 6 mm thick and 29 mm wide moulding. Every table shall be provided with a key board, drawer, and a cabinet with a shutter below W-375mm, H-750mm, Depth- 500mm. The Storage unit shall consist of provision for C.P.U. 600X250 size Keyboard to be made of 19 mm thick commercial board and finished Drawers and a cabinet with a shutter below W-375mm, H-750mm, Depth-500mm. shall consist of 12 mm thick commercial board for bottom, sides and back of 19 mm thick phenol bonded commercial board with laminate in front and shall slide on tray system provision (sliding mechanism).				
	All the units shall be provided with all the necessary hardware as approved by the Architect. such as knobs, handles, etc. All unexposed surfaces to have two coats of synthetic enamel paint with primer and base, all complete, specifications and directions of the engineer in charge.				
2	Cash Cabin Partition (HT-7'-0" ONLY)	Sq.ft.	180.00		

	Providing and fixing of Cash Enclosures at height of 7'-0" with Anodized aluminium frame work, heavy sections (2mm thickness) of 2"x1.5", spacing of 2'0"x2'0" on bothsides and covered 6mm thick BWP plywood finished with 1mm thick laminate of approved colour. Partition shall have provision for opening and 19mm BWP plywood tray for challan receiving purpose. Cost include aluminium grill and fixed with teak wood beading and duco paint. Cost also include 3 Nos of Solid core flush Doors with sizes of 2'6"x7'0", fixed in the partition. Door shall have teak wood beading and lipping with duco paint. Door finished with 1mm thick laminate of approved colour for skirting of approved pattern. Door shall have 8mm glass fixed with teak wood beading and duco paint. Rate to include hardware's like brass hinges, godrej three nos of night latch, door closure, door stopper and handles. Cost also include cash transaction opening shall be provided with door arrangements made with BWP plywood frame work finished by laminate, duco paint and locking system. Cost include wastages, transports, loading, unloading charges, labours, materials, tools, lead, lift and etc. Complete as per drawings and instructions of the Architect.				
	Decorative Grill (12mm thk)-hexagonal opening as per instruction of Bank's Engineer/Architect.) All exposed edges of Plywood shall be fixed with 1/8" C.P. Teak Lipping.				
3	Cash Counter	Rft.	5.00		
	Bank counter of approved design for cashier made of 19.00 mm commercial block board and mica 1.00 mm thick of approved brand and colour on front customer top and writing desk. Height of counter from customer side 114cm (45"). width of writing desk 75cm.(30") with provision of cupboard after every 1.20 mts made of 19.00 mm block board with 1.0 mm sunmica pasted on both side (inner and outer), and teakwood beading complete with quality polish finish. Mica pasted on both sides external & internal including all locks & handles with door closer.				
4	Front Counter	Rft.	18.00		
	Front counter made of 19.00 mm block board with table top at the height 75 cm and 80 cm wide sunmica 1.0 mm on top and cup board and sliding key board with provision of fixing of glass in front. Mica pasted on both sides external & internal including all locks & handles.				
5	Cash Cabin-Aluminium Grill Top with teak Decorative Grill Partition).	Sq.ft.	44.00		
	Providing and fixing of Aluminum grill work in cash counter top with all nessecary fixing support of 'L', 'H' and 'C' aluminium sections and etc. Cost include 'L', 'H' and 'C' aluminium sections, hardwares, tools, wastages, lead, lift, labour charges, loading, unloading charges, cutting, transport and etc. Complete as per instructions of the Architect.				
6	12 mm Glass on Front Counter & Cash Counter	Sq. ft.	56.00		
	12 mm float glass with rounded edges with etching as per the requirement of bank for Front counter (Height: 60 cms) (With teak wood frame 70 cm).				
7	Low Height Partition up to 4'-6" ht. glazed/Unglazed partition	Sq.ft.	230.00		

	Half Height partition to be made with Anodized Aluminium frame work, heavy sections (2mm thickness) of 2"x1.5" sections, spacing of 2'0"x 2'0" on bothsides and covered with 9mm thick BWP plywood finished with 1mm thick laminate of approved colours for skirting & borders and white colour laminates for base on both sides with all necessary fixing accessories, arrangements and etc. Partition shall be block partition till 3' ht. and 1'-6" glazing. It shall have 12mm thick etched glass and fixed with teak wood beading with melamine polish. Clear glass shall be finished with frosted film sticking over the glass of approved pattern and design. Rate to include providing cutouts and provisions to run electrical conduits, switches, etc. Cost include wastages, transports, loading, unloading charges, labours, materials, tools, lead, lift and etc. Complete as per drawings and instructions of the Architect.				
8	Storage (Low Height)	Sq.ft.	20.00		
	Size-2'-6" highX 1'-6" deep				
	Size-8'-6" highX 1'-6" deep				
	Ply Wood -19.0mm thick board for side top and door & back 6.0mm IS 303 with shutters, shelf 19.0mm ply				
	Shelf -19.0mm thick MR Grade IS303 ply				
	Handle -Brush finish stainless steel				
	Lock -Vijayan/Godrej				
	Internal surface zinc oxide polish and other required accessories instructed by Bank's Engineer / Architect.				
9	Column / Wall Panelling (Meter Boxing with proper locking system, 2 nos. of air-con louvers & all necessary accessories)	Sq.ft.	420.00		
	Column Panelling 8'-6"/Wall Panelling 4'-6" only considered with Anodized Aluminium frame work, heavy sections (2mm thickness) of 2"x1.5", spacing of 2'0"x2'0" on bothsides and covered with 9mm thick BWP plywood finished with 1mm thick laminate colours for skirting & borders,. Rate to include providing cutouts and provisions to run electrical conduits, switches, etc. Cost include necessary hardwares like clamps, screws and etc. Cost include provisions for electrical db closing 19mm BWP plywood door arrangements, wastages, transports, loading, unloading charges, labours, materials, tools, lead, lift and etc. Complete as per drawings and instructions of the Architect.				
	Meter Boxing (Only front face to be measured for payment purpose) Size 3'-0"x 4'-6"				
10	Notice Board	No.	1.00		
	Notice Board made of 19.00 mm board (size: 3'-0"x3'-0") laminated sides andcovered by good quality Cherry Colour Velvet with attached Cheque Writing Desk (6"x6"x9") with attached Two Battens for Support, Sunmica Pasted on all sides.				
11	Writing Desk Including Suggestion Box and Cheque Drop Box	No.	1.00		
	Writing ledge of 19 mm Phenol bonded board as/design on 19 mm thick with pockets for slips of 6mm glass machine polished with seperators completed to the satisfaction of the architect and the Drawing. The Writing ledge includes a Suggestion box below, cheque drop box and a notice board above complete to the satisfaction of the Architect.				

12	Hydraulic Door Closure. (to be Godrej)	No.	1.00		
	Providing and fixing of hydraulic door closure (Make-Godrej, Product Code-4539 or equivalent) for doors. It shall incorporate the following –				
-	Body manufactured from Aluminium extruded alloy machined to extreme accuracy.				
-	Rack and Pinion-made of machined alloy steel duly heat-treated.				
-	Adjustable closing speed.				
-	Suitable for right hand and left hand opening doors.				
-	Suitable for door / frame mounting.				
-	Suitable for door weight up to 60 kgs.				
-	Suitable for 180 / 100 degree door opening.				
-	All complete to the satisfaction of the Architect.				
	Total				

Note: All rates are excluding G.S.T.

For GUNJAN & ASSOCIATES

 Ar. GUNJAN KAPUR
 PROPRIETOR

Ar. Gunjan Kapur

for Gunjan & Associates

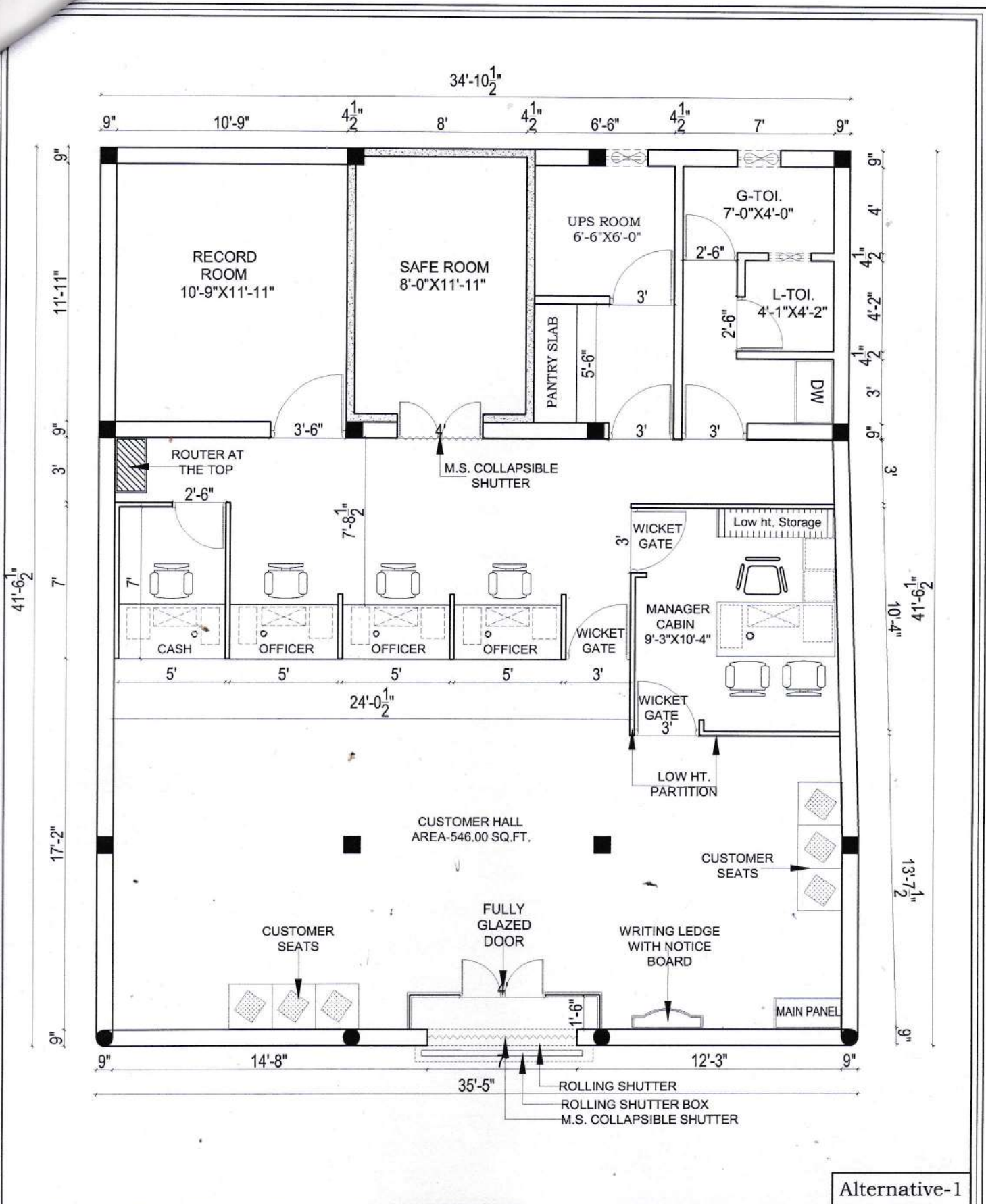

Alternative-1

<p>PROJECT:- LAYOUT PLAN FOR BARODA U.P. BANK AT ANNAWA, REGION FAIZABAD.</p>	<p>DRG. TITLE:- GROUND FLOOR</p> <p>DATE:- JUN -2024</p>	<p>NORTH:-</p> <p>DRAWN BY:-</p>	<p>ARCHITECT:- GUNJAN & ASSOCIATES ARCHITECTS, ENGINEERS, INTERIOR AND LANDSCAPE DESIGNERS. 141, SAINIK NAGAR, LANE NO-9, RAEBARELI ROAD LUCKNOW-226002 Telephone No:- +0522-3553324 Phone No:- +9838818489, 9839018489 E-Mail:-studio@gunjanandassociates.com Web:-www.gunjanandassociates.com</p>
--	--	----------------------------------	---

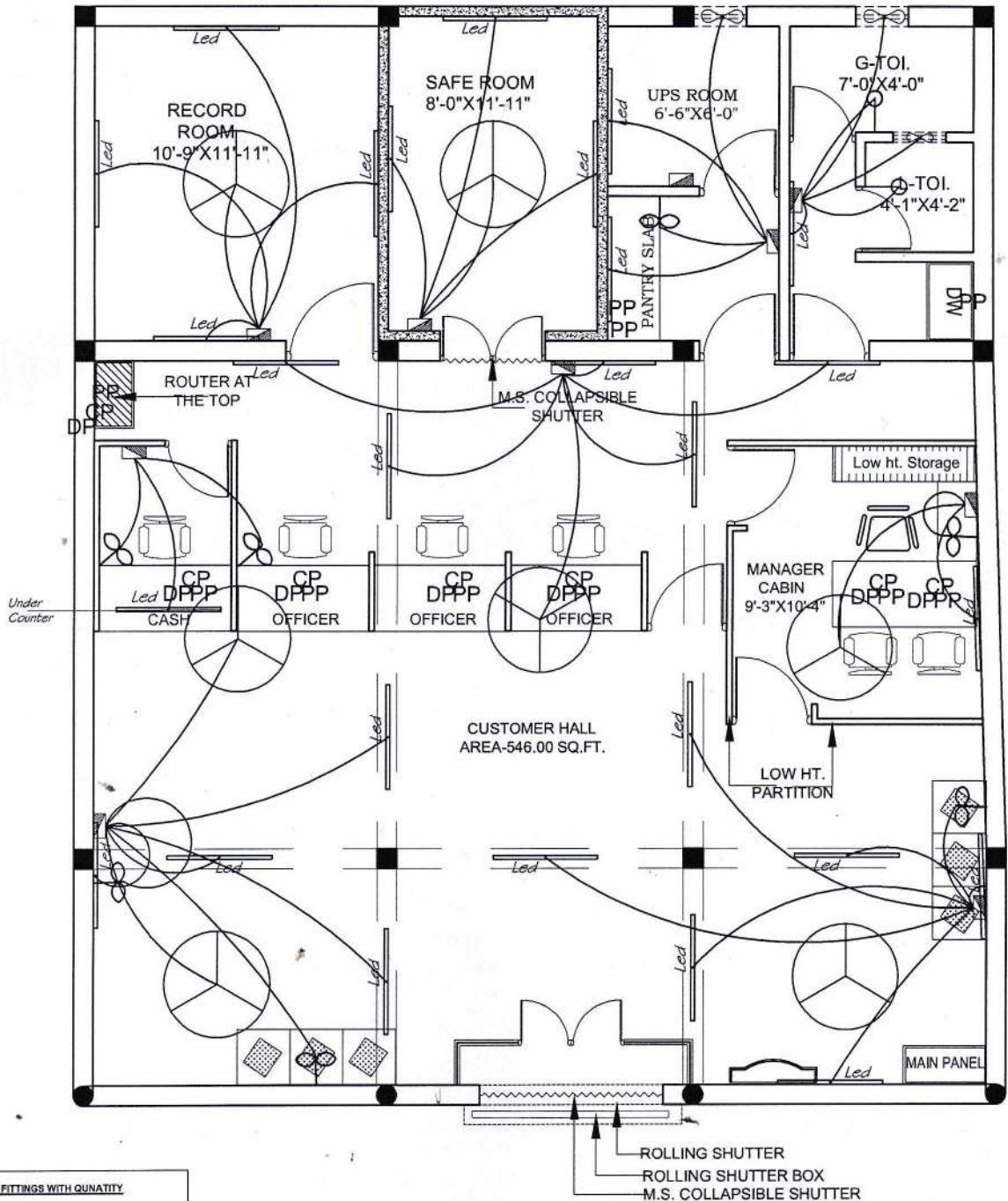

LEGENDS FOR FIXTURES & FITTINGS WITH QUANTITY

S.NO.	SYMBOL	DESCRIPTION	HT.
1.	—	4' long LED TUBE LIGHT	8'-0"
2.	⊙	CEILING FAN	
3.	⊗	Wall mounted Fan	6'-6"
4.	∞	AFF/ EXHAUST	8'-6"
5.	○	LED bulb light holder	8'-6"
6.	□	SWITCH BOARD	4'-6"
7.	PP/CP/DP	POWER/ COMPUTER/ DATA	1'-0"
8.	■	MAIN LT PANEL	
9.	⊕	TPN Db	6'-0"
10.	⊖	SPN Db	6'-0"

ROLLING SHUTTER
 ROLLING SHUTTER BOX
 M.S. COLLAPSIBLE SHUTTER

PROJECT:-

**ELECTRICAL PLAN FOR
 BARODA U.P. BANK AT
 ANNAWA, REGION
 FAIZABAD.**

DRG. TITLE:-

GROUND FLOOR

DATE:-

OCT -2024

NORTH:-

DRAWN BY:-

ARCHITECT:-
GUNJAN & ASSOCIATES
 ARCHITECTS, ENGINEERS, INTERIOR
 AND LANDSCAPE DESIGNERS.
 141, SAINIK NAGAR, LANE NO-9,
 RAEBARELI ROAD LUCKNOW-226002
 Telephone No:- +0522-3553324
 Phone No:- +9838818489, 9839018489
 E-Mail:-studio@gunjanandassociates.com
 Web:-www.gunjanandassociates.com